



Carnaby Caravans

HOLIDAY HOMES OF DISTINCTION
2026 COLLECTION

This is the ultimate holiday home... with a range of features to meet your every need. The delightful three piece suite combines mahogany furniture and beautiful curtains and give you a lounge of real distinction. Attractive kitchen suite incorporate an eye lev and illuminated extractor. In the full size and illuminated bathroom has a full size and illuminated extractor. In the full size and illuminated bathroom has a full size and illuminated extractor.

Celebrating 50 Years of Carnaby Caravans

“Half a century of craftsmanship. A lifetime of memories.

In 2026, Carnaby Caravans celebrates a truly special milestone — 50 years of building not just holiday homes, but unforgettable holiday experiences.

Since 1976, Carnaby has stood for more than exceptional design and craftsmanship.

We’re a family — a legacy of dedicated craftspeople, each generation passing down their passion, skill, and commitment to excellence.

Every holiday home tells a story of care, precision, and pride.

But our journey isn’t ours alone.

We’ve travelled this road alongside incredible partners in the holiday park industry, who’ve welcomed our holiday homes into thriving communities filled with warmth and belonging. Most importantly, we’ve shared our story with countless families who’ve made Carnaby a part of their lives — creating moments of joy, adventure and community.

As we mark 50 years, we thank everyone who’s been part of our journey.

Here’s to the next generation of getaways, memories, and milestones — together...”



CONTENTS

THE CARNABY STANDARD	4
GRANTLEY LODGE	8
THE LANGHAM	14
CHANNY LODGE	22
LAKEHOUSE LODGE.....	28
CARRINGTON	32
SILVERDALE.....	38
MELROSE	44
MELROSE CL	50
BAYVIEW	56
BREAKAWAY	62
EXTERNAL SIZES	68
WARRANTY.....	68
EXTERIOR FINISHES.....	69
WINDOW FINISHES.....	69
SPECIFICATION, FEATURES AND OPTIONS	70
ULTRA WARM UPGRADE	71



T H E C A R N A B Y S T A N D A R D

The Carnaby Standard encapsulates our brand; the unmistakable quality
is underfoot, within the walls and visually present.

More than style or a set of features, it's our values - hand woven into the
fabric of every holiday home we craft.

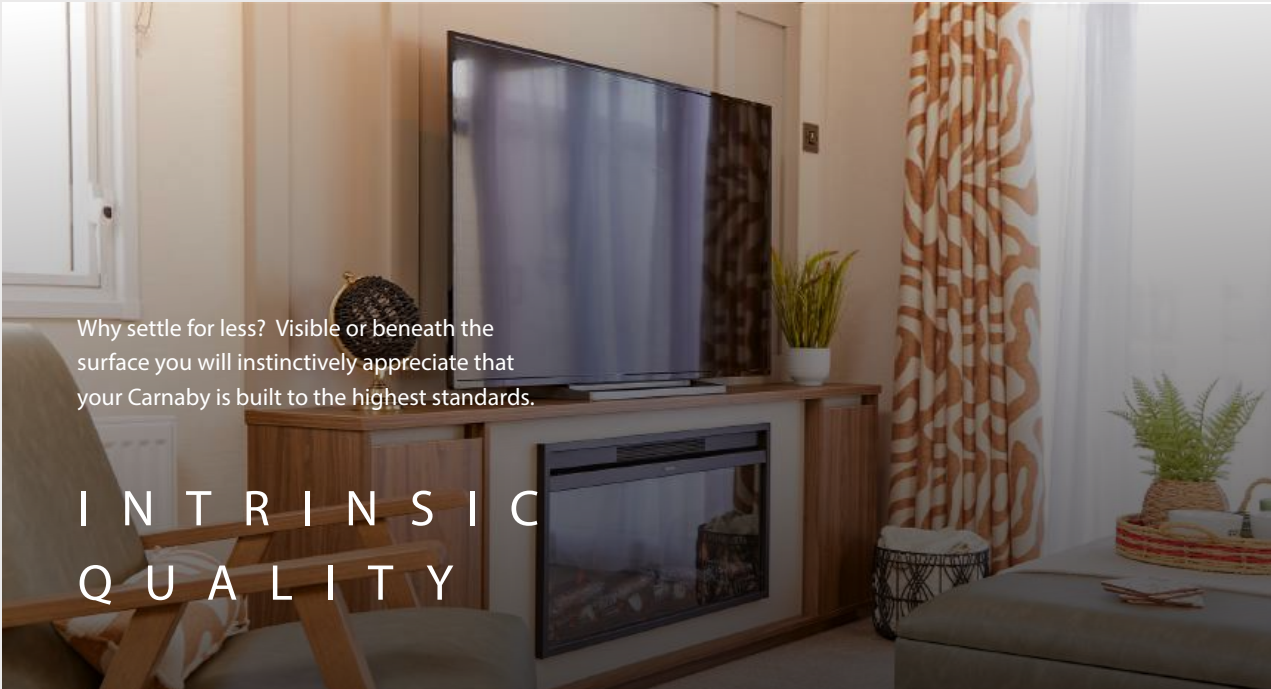

Why settle for less? Visible or beneath the surface you will instinctively appreciate that your Carnaby is built to the highest standards.

INTRINSIC QUALITY

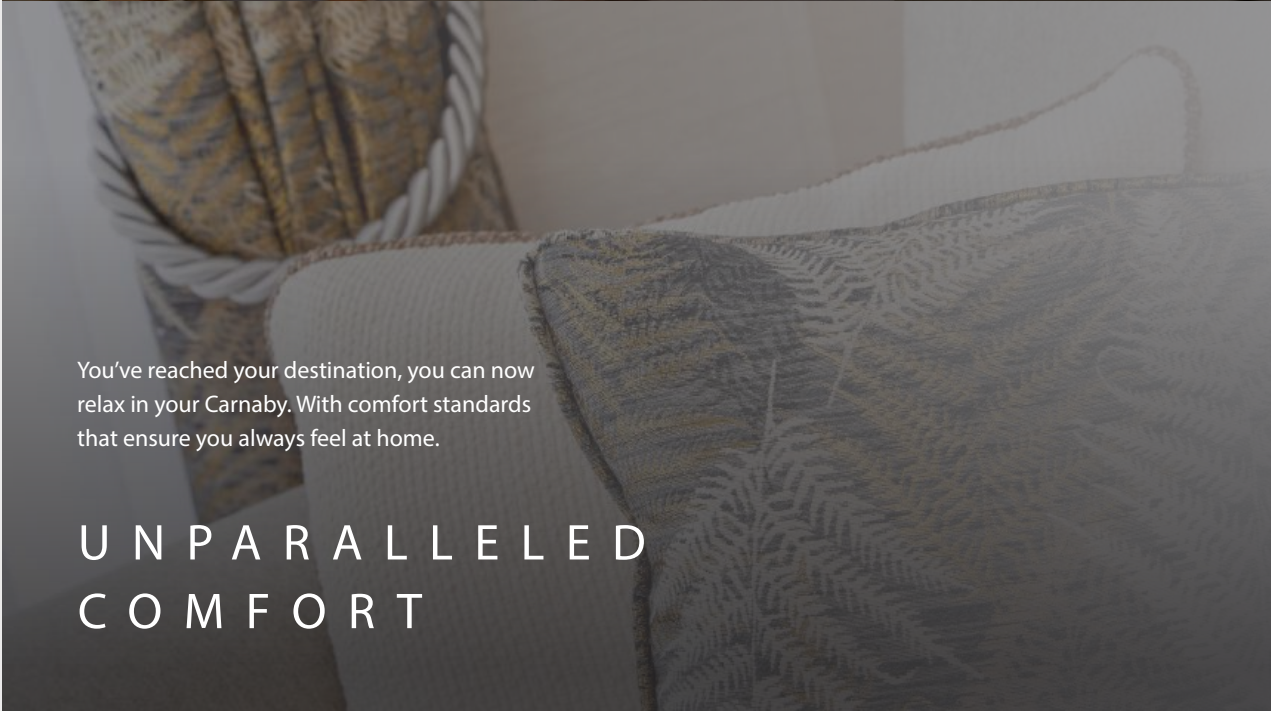

You've reached your destination, you can now relax in your Carnaby. With comfort standards that ensure you always feel at home.

UNPARALLELED COMFORT

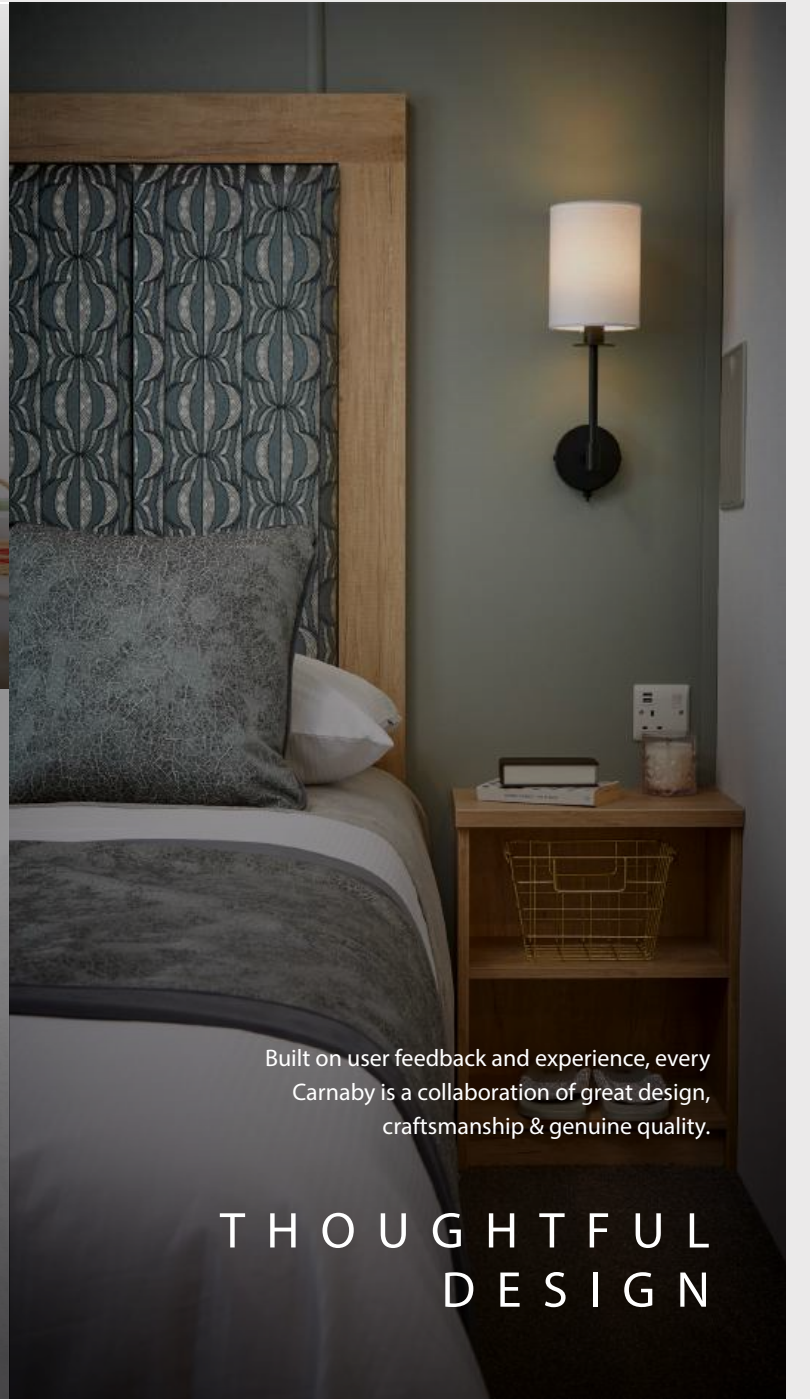

Built on user feedback and experience, every Carnaby is a collaboration of great design, craftsmanship & genuine quality.

THOUGHTFUL DESIGN

THE CARNABY STANDARD



INTRINSIC QUALITY

HEAD SPACE

Every Carnaby uses space to the maximum. 7-ft-high walls and vaulted ceilings are present across our range, giving you the space to live and entertain without compromise.

CABINETRY & JOINERY

First-class craftsmanship is at the heart of our holiday homes. You'll find stylish, well designed, solid furniture, crafted to withstand the rigours of everyday life.

FIXTURES & FITTINGS

We understand quality. We specify components and fixtures in line with The Carnaby Standard. Flick a switch, draw the curtains or open a drawer knowing time has been taken to ensure every interaction with your holiday home echoes quality.

QUALITY FEATURES

Appliances you can trust. We specify and fit branded white goods to all our kitchen areas - you will see brands you know and trust from your own home.

THERMAL RATINGS

Carnaby takes energy efficiency very seriously and by specifying either an Ultra Warm or Ultra Warm Plus upgrade, you can celebrate best in industry thermal efficiencies. We only install domestic quality heating systems to keep you warm on a chilly evening, and with a flow rate capable of running piping hot water to two showers simultaneously.

THE CARNABY STANDARD

UNPARALLELED
COMFORT

SEATING

Introducing the 'Carnaby Sit'. Our standard ensures every seat in every Carnaby is manufactured to be sumptuous whilst offering industry leading comfort levels.

COMFORT MATTRESS

Made in the UK to the highest standards, included across the range you'll find the Carnaby Comfort mattress which guarantees a restful night's sleep just as you would expect in your own home.

FURNISHINGS INCLUDED
AS STANDARD

At Carnaby, we believe in providing value. Carefully coordinated cushions and window voiles are included as standard with every holiday home in our collection.

FLOORING

Walk into any holiday home in our range, kick off your shoes and relax knowing that all carpets have super soft underlay fitted as standard. Within kitchens, bathrooms and en-suites you get springy, soft touch, high quality vinyl flooring.



GRANTLEY LODGE

TAKE A 360 TOUR



HIGHLIGHT
Front Panoramic Double Sliding
Patio Doors



GRANTLEY LODGE

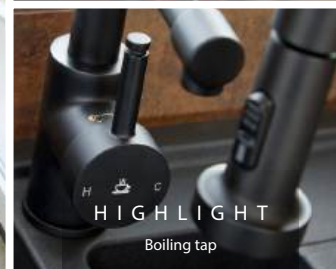

HIGHLIGHT

Unique Dining Island comprising a
Cocktail Bar and Wine Cooler



GRANTLEY LODGE





THE CARNABY STANDARD

- Carnaby Comfort mattresses
- Comfortable 'Carnaby Sit' seating
- 7-ft-high walls with vaulted ceilings
- Colour co-ordinated scatter cushions to sofa
- USB charging sockets in lounge and bedrooms
- Externally vented cooker hood extractor
- Exterior lighting to doors
- Voiles to selected windows
- Super soft underlay to all carpeted areas
- Utility storage cupboard

FLOOR PLANS

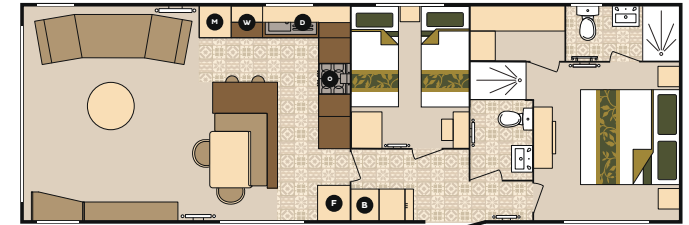

42 X 14 2B

Bed sizes: Super King 1905mm x 1830mm & 2 x Single 1905mm x 915mm which zip and link to make a Super King 1905mm X 1830mm

M Microwave
 O Oven
 B Boiler
 D Dishwasher
 F Fridge Freezer
 W Washing Machine*

*Optional extra

FEATURES

EXTERIOR

- Matt Champagne aluminium cladding with contrast plastic cladding to front
- Coloured uPVC double glazing
- Fully galvanised chassis
- Reversible tow bar facility
- Exterior light
- LED backlit front barge board
- Double sliding patio doors
- Velux rooflight to kitchen and main bathroom

HEATING & INSULATION

- External pipe lagging
- 'A' rated Vaillant combi boiler, wet radiators with thermostatic valves
- Fibreglass wall insulation
- Fibreglass roof insulation with vapour barrier
- Fibreglass under-floor insulation
- uPVC double glazing

LOUNGE & DINING

- Unique dining island unit comprising a cocktail bar, wine cooler, corner bench seating, two freestanding dining chairs, dining table and two bar stools
- Angled sofa with contrasting scatter cushions
- Bluetooth lounge ceiling speakers
- Wall mounted TV point (HDMI, double mains socket, aerial coaxial)
- Feature storage footstool with swivel lid
- Electric flame effect fire
- Window seat with bolster and storage
- Feature eleven arm pendant light over the dining table

KITCHEN

- Fan assisted electric oven and grill
- Five burner gas hob
- Gesture-controlled cooker hood extractor
- Integrated microwave oven
- Integrated dishwasher
- Integrated fridge/freezer
- Black resin sink and boiling tap
- Venetian blind
- Wine Cooler

BEDROOMS

- Carnaby Comfort mattresses
- Super King bed in master bedroom
- Super King split base divan with zip-lock mattress to second bedroom
- TV points to both bedrooms
- Feature upholstered headboard with bed-side lighting in master bedroom
- Wardrobes, bedside tables, dressing table and stool to both bedrooms
- Bedside USB charging sockets
- Walk in wardrobe to master bedroom with drawers and backlit hanging rails

BATHROOMS

- Extractor fans to both bathrooms
- Both bathrooms with thermostatically controlled showers
- Heated towel rails to both bathrooms
- Sculpted counter top wash basins with vanity unit
- Carnaby crafted cabinets and storage units

THE LANGHAM

TAKE A 360 TOUR



HIGHLIGHT

Unique 5-Star hotel
central living layout



THE LANGHAM

HIGHLIGHT

Feature LED cabinet lighting to kitchen

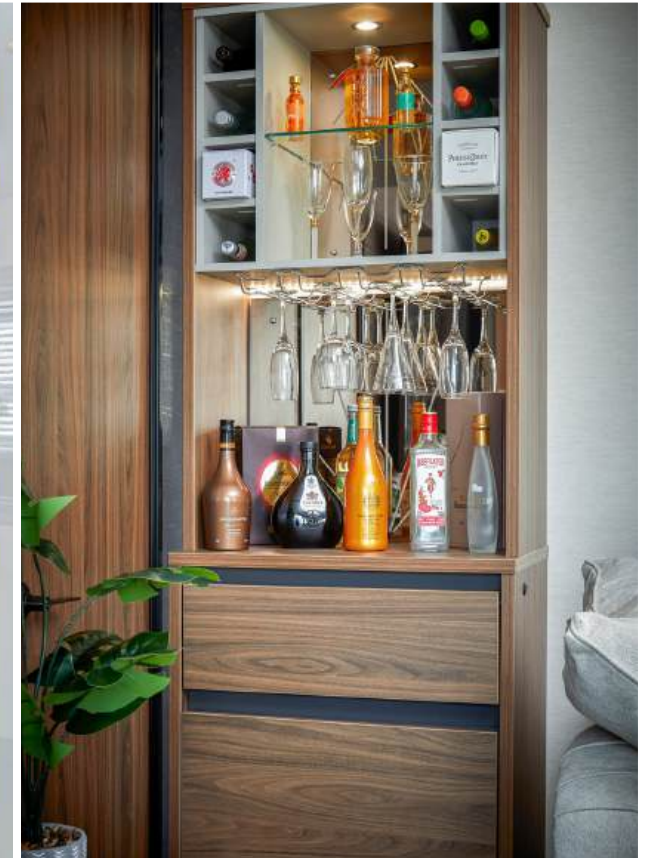

HIGHLIGHT

Super King bed in
both bedrooms



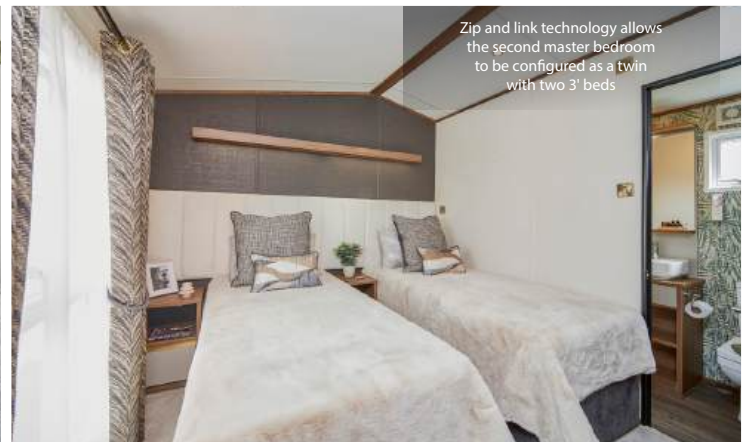



THE CARNABY STANDARD

- Carnaby Comfort mattresses
- Comfortable 'Carnaby Sit' seating
- 7-ft-high walls with vaulted ceilings
- Colour co-ordinated scatter cushions to sofa
- USB charging sockets in lounge and bedrooms
- Externally vented cooker hood extractor
- Exterior lighting to doors
- Voiles to selected windows
- Super soft underlay to all carpeted areas
- Utility storage cupboard

FEATURES

EXTERIOR

- Two tone Matt Champagne with Anthracite Grey cladding
- Coloured uPVC double glazing
- Fully galvanised chassis
- Reversible tow bar facility
- Exterior light

HEATING & INSULATION

- External pipe lagging
- 'A' rated Vaillant combi boiler, wet radiators with thermostatic valves
- Fibreglass wall insulation
- Fibreglass roof insulation with vapour barrier
- Fibreglass under-floor insulation
- uPVC double glazing

LOUNGE & DINING

- Free standing dining table with padded high back dining chairs
- Corner sofa with scatter cushions
- Bluetooth lounge ceiling speakers
- Wall mounted TV point (HDMI, double mains socket, aerial co-Axial)
- Feature storage footstool
- Electric flame effect wood burning stove
- Carnaby crafted cocktail cabinet

KITCHEN

- Fan assisted electric oven and grill
- Five burner gas hob
- Feature cooker hood extractor
- Integrated microwave oven
- Integrated dishwasher
- Integrated fridge/freezer
- Black resin sink and drainer
- Feature lighting to wall units and under counters
- Venetian blind

BEDROOMS

- Carnaby Comfort mattresses
- Super King bed in master bedroom
- Super King split base divan with zip-lock mattress to second master bedroom
- Storage beds
- TV points to both bedrooms
- Feature upholstered headboard with bed-side lighting in master bedroom
- Wardrobes, bedside tables, dressing table and stool to both bedrooms
- Bedside USB charging sockets

BATHROOMS

- Extractor fans to both bathrooms
- Both bathrooms with thermostatically controlled showers
- Heated towel rails to both bathrooms
- Dual sculpted counter top wash basins with vanity unit
- Carnaby crafted cabinets and storage units

FLOOR PLANS



41 X 13 2B

Bed sizes: Super King 1905mm x 1830mm & 2 x Single 1905mm x 915mm which zip and link to make a Super King 1905mm X 1830mm

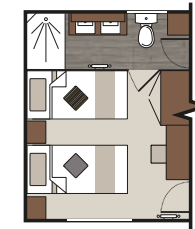

41 X 13 2B

Second Master Bedroom in Twin Configuration

M Microwave **O** Oven **B** Boiler **D** Dishwasher **F** Fridge Freezer **W** Washing Machine*

*Optional extra

CHANNY LODGE

TAKE A 360 TOUR

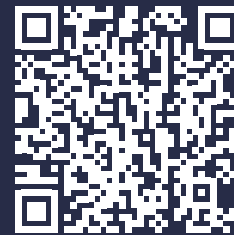

HIGHLIGHT

Double sliding patio doors as standard and Carnaby crafted wall unit with flame effect fire and space for up to 65" TV



CHANTRY LODGE

HIGHLIGHT

Wraparound corner sofa & feature storage footstool



HIGHLIGHT

Elegant deep blue feature kitchen cabinets with brushed gold inlays



CHANTRY LODGE





THE CARNABY STANDARD

- Carnaby Comfort mattresses
- Comfortable 'Carnaby Sit' seating
- 7-ft-high walls with vaulted ceilings
- Colour co-ordinated scatter cushions to sofa
- USB charging sockets in lounge and bedrooms
- Externally vented cooker hood extractor
- Exterior lighting to doors
- Voiles to selected windows
- Super soft underlay to all carpeted areas
- Utility storage cupboard

FEATURES

EXTERIOR

- Matt Champagne aluminium cladding
- Fully galvanised chassis
- Reversible tow bar facility
- Double sliding patio doors as standard
- Coloured uPVC double glazing
- Exterior lighting to side and front doors

HEATING & INSULATION

- External pipe lagging
- 'A' rated Vaillant combi boiler, wet radiators with thermostatic valves
- Fibreglass wall insulation
- Fibreglass roof insulation with vapour barrier
- Fibreglass under-floor insulation
- uPVC double glazing

LOUNGE & DINING

- Carnaby crafted wall unit with space for up to 65" TV
- Wraparound corner sofa
- Free standing dining table with padded high back dining chairs
- Feature storage footstool
- Flame effect electric fire

KITCHEN

- 90cm dual fuel range cooker (gas and electric) with five burner gas hob
- Integrated microwave oven
- Integrated dishwasher
- Integrated fridge/freezer
- Black resin sink and drainer
- Dividing door to hallway
- Venetian blind

BEDROOMS

- Carnaby Comfort mattresses
- King Size bed in master bedroom
- 3' beds to second bedroom (two bedroom model only)
- Storage bed with gas strut lift up mechanism (master bedroom only)
- TV points in all bedrooms
- Feature upholstered headboard with bed-side lighting in master bedroom
- Wardrobes, bedside tables and dressing table with stool in the master bedroom
- Bedside USB charging sockets

BATHROOMS

- Extractor fan to both bathrooms
- Family bathroom with a thermostatically controlled shower valve or bath option
- En-suite bathroom with thermostatically controlled shower
- Heated towel rails to both bathrooms
- Bathroom cabinet with mirror
- Sculpted counter top wash basin with vanity unit
- Venetian blinds in bathroom and en-suite

FLOOR PLANS

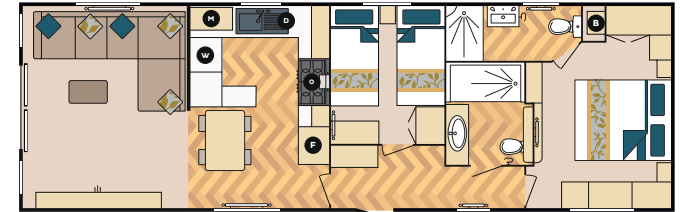

41 X 13 2B - SHOWER

Bed sizes: King Size 1905mm x 1525mm & 2 x Single 1905mm x 915mm

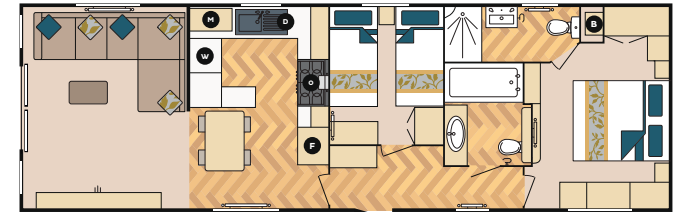

41 X 13 2B - BATH

Bed sizes: King Size 1905mm x 1525mm & 2 x Single 1905mm x 915mm



41 X 13 3B

Bed sizes: King Size 1905mm x 1525mm, 1 x Single 1830mm x 915mm, 1 x Single 1830mm x 760mm & 2 x Single 1830mm x 685mm

M Microwave
 O Oven
 B Boiler
 D Dishwasher
 F Fridge Freezer
 W Washing Machine*

*Optional extra

LAKEHOUSE LODGE

TAKE A 360 TOUR



HIGHLIGHT

Panoramic glazed front
with French doors



HIGHLIGHT

Wraparound feature kitchen with cashmere shaker doors and marble effect work surfaces



HIGHLIGHT

Corner sofa and feature accent chair

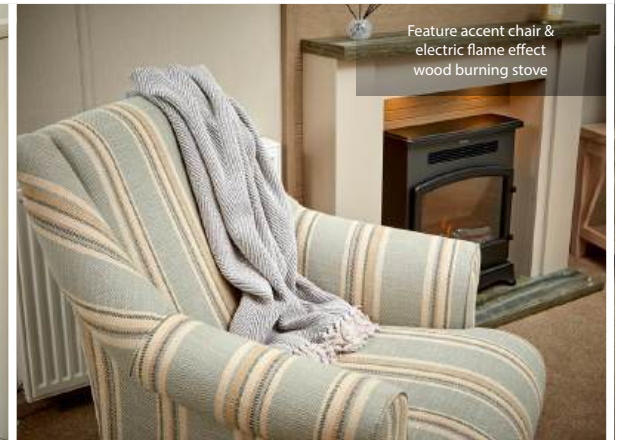

Feature accent chair & electric flame effect wood burning stove

HIGHLIGHT

King Size bed and bed-side lights
to master bedroom





En-suite



HIGHLIGHT
3' bed to second bedroom

Second Bedroom



Main Bathroom



Master Bedroom



Master Bedroom





Shown with optional Anthracite Grey uPVC glazing

THE CARNABY STANDARD

- Carnaby Comfort mattresses
- Comfortable 'Carnaby Sit' seating
- 7-ft-high walls with vaulted ceilings
- Colour co-ordinated scatter cushions to sofa
- USB charging sockets in lounge and bedrooms
- Externally vented cooker extractor hood
- Exterior lighting to doors
- Voiles to selected windows
- Super soft underlay to all carpeted areas
- Utility storage cupboard

FEATURES

EXTERIOR

- Matt Champagne aluminium cladding
- Fully galvanised chassis
- Reversible tow bar facility
- Panoramic glazing with French Doors
- Exterior lighting to side and front doors

HEATING & INSULATION

- External pipe lagging
- Fibreglass wall insulation

Available with optional Ultra Warm upgrade which includes;

- 'A' rated Vaillant combi boiler, wet radiators with thermostatic valves
- External pipe lagging
- Fibreglass wall insulation
- Fibreglass roof insulation with Vapour barrier
- Fibreglass under-floor insulation
- uPVC double glazing

LOUNGE & DINING

- Free-standing TV cabinet
- Wraparound sofa and contrasting chair
- Vertical blinds to glazed front end
- Venetian blinds with fabric pelmets to side windows
- Feature mirror over fireplace
- Free standing dining table with padded dining chairs
- Coffee table
- Electric flame effect wood burning stove

KITCHEN

- Fan assisted electric oven and grill with four burner gas hob
- Integrated microwave oven
- White resin sink, drainer and mixer tap
- Dividing door to hallway
- Venetian blind

BEDROOMS

- Carnaby Comfort mattresses
- King Size bed to master bedroom
- Storage bed with gas strut lift up mechanism in master bedroom
- TV point in master bedroom
- Bed-side lighting in master bedroom
- Wardrobes, bedside tables and dressing table with stool
- Bedside USB charging sockets

BATHROOMS

- Extractor fan to both bathrooms
- Thermostatically controlled showers
- Bathroom cabinet with mirror
- Sculpted counter top wash basin with vanity unit
- Venetian blinds in bathroom and en-suite

FLOOR PLANS

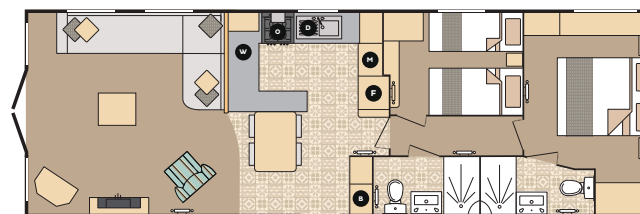

40 X 13 2B

Bed sizes: King Size 1905mm x 1525mm,
1 x Single 1830mm x 915mm & 1 x Single 1830mm x 760mm

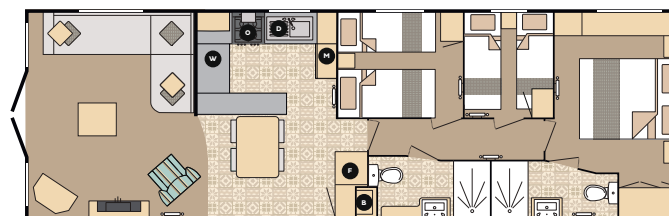

41 X 13 3B

Bed sizes: King Size 1905mm x 1525mm, 1 x Single 1830mm x 915mm,
1 x Single 1830mm x 760mm & 2 x Single 1830mm x 685mm

M Microwave
 O Oven
 B Boiler
 D Dishwasher*
 F Fridge Freezer
 W Washing Machine*

*Optional extra

CARRINGTON

TAKE A 360 TOUR

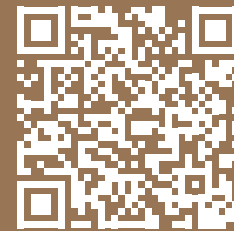

HIGHLIGHT

Open plan layout perfect for entertaining



CARRINGTON



HIGHLIGHT

Sumptuous shaped sofa with accent armchair and storage footstool



HIGHLIGHT

stylish kitchen with walnut and pebble grey colour tones







En-suite



Master Bedroom



Main Bathroom



Master Bedroom



Master Bedroom



Second Bedroom



Shown with optional Anthracite grey uPVC glazing and sliding patio doors

THE CARNABY STANDARD

- Carnaby Comfort mattresses
- Comfortable 'Carnaby Sit' seating
- 7-ft-high walls with vaulted ceilings
- Colour co-ordinated scatter cushions to sofa
- USB charging sockets in lounge & bedrooms
- Externally vented cooker hood extractor
- Exterior lighting to doors
- Voiles to selected windows
- Super soft underlay to all carpeted areas
- Utility storage cupboard

FEATURES

EXTERIOR

- Matt champagne aluminium cladding with feature aluminium to front
- Panoramic fixed front windows
- Reversible tow bar facility
- Exterior lighting to doors
- Optional patio door

HEATING & INSULATION

- External pipe lagging
- Fibreglass wall insulation
- Available with optional Ultra Warm upgrade which includes;
 - 'A' rated Vaillant combi boiler, wet radiators with thermostatic valves
- External pipe lagging
- Fibreglass wall insulation
- Fibreglass roof insulation with Vapour barrier
- Fibreglass under-floor insulation
- uPVC double glazing

LOUNGE & DINING

- Carnaby crafted media unit with inset fire and space for TV
- Angled sofa with contrasting scatter cushions
- Accent wooden armchair with bolster cushion
- Feature storage footstool
- Silver finish wall lights with diffusers
- Roman blinds with matching fabric pelmets to side windows
- Free standing dining table with padded dining chairs

KITCHEN

- Fan assisted electric oven and grill with four burner gas hob
- Colour contrasting cabinet doors
- Integrated fridge/freezer
- Graphite resin sink and matching tap
- Dividing door to hallway
- Venetian blind

BEDROOMS

- Carnaby Comfort mattresses
- King bed in master bedroom
- Feature upholstered headboard with bedside lighting in master bedroom
- Wardrobes, bedside tables, dressing table, backlit mirror and stool
- Bedside USB charging sockets
- Walk in wardrobe to master bedroom with drawers and hanging rails

BATHROOMS

- Extractor fans to both bathrooms
- Thermostatically controlled showers
- Bathroom cabinets with mirrors
- Sculpted counter top wash basins with vanity units
- Venetian blinds in both bathrooms

FLOOR PLANS



36 X 12 2B

King Size 1905mm x 1525mm & 2 x Single 1830mm x 685mm



40 X 12 2B

King Size 1905mm x 1525mm & 2 x Single 1830mm x 685mm



40 X 12 3B

King Size 1905mm x 1525mm, 2 x Single 1830mm x 685mm & 2 x Single 1830mm x 610mm

- M Microwave
- O Oven
- B Boiler
- D Dishwasher*
- F Fridge Freezer
- W Washing Machine*

*Optional extra

SILVERDALE

TAKE A 360 TOUR



HIGHLIGHT

Two large, comfortable and deep sofas with coordinating cushions



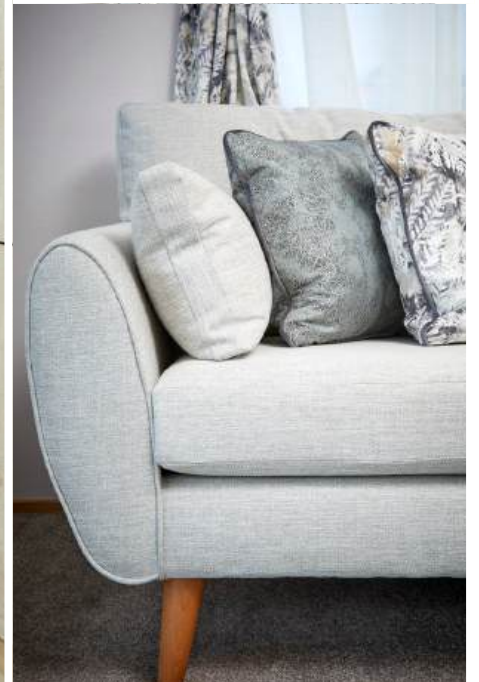

HIGHLIGHT

King Size bed with large headboard, bedside tables and bedside wall lights



SILVERDALE





THE CARNABY STANDARD

- Carnaby Comfort mattresses
- Comfortable 'Carnaby Sit' seating
- 7-ft-high walls with vaulted ceilings
- Colour co-ordinated scatter cushions to sofa
- USB charging sockets in lounge and bedrooms
- Externally vented cooker hood extractor
- Exterior lighting to doors
- Voiles to selected windows
- Super soft underlay to all carpeted areas
- Utility storage cupboard

FEATURES

EXTERIOR

- Matt champagne aluminium cladding
- Panoramic fixed front windows
- Reversible tow bar facility
- Exterior lighting to side door

HEATING & INSULATION

- External pipe lagging
- Fibreglass wall insulation

Available with optional Ultra Warm upgrade which includes;

- 'A' rated Vaillant combi boiler, wet radiators with thermostatic valves
- External pipe lagging
- Fibreglass wall insulation
- Fibreglass roof insulation with Vapour barrier
- Fibreglass under-floor insulation
- uPVC double glazing

LOUNGE & DINING

- Carnaby crafted free-standing TV cabinet
- Two and three seater free-standing sofas
- Carnaby crafted fire surround
- Feature framed mirror
- Free standing dining table with padded dining chairs
- Coffee table
- Flame effect electric fire
- Storage dresser

KITCHEN

- Fan assisted electric oven and grill with four burner gas hob
- Colour contrasting cabinet doors
- Integrated fridge/freezer
- Black resin sink and matching tap
- Dividing door to hallway
- Venetian blind

BEDROOMS

- Carnaby Comfort mattresses
- King Size bed in master bedroom with wall lights
- Feature mirrors
- Feature upholstered headboard
- Wardrobes, bedside table and dressing tables
- Bedside USB charging sockets

BATHROOMS

- Family bathroom with thermostatically controlled shower
- En-suite bathroom with thermostatically controlled shower (on units over 36')
- Bathroom cabinets with mirrors
- Floor standing vanity unit with countertop wash basin
- Venetian blinds in bathroom and en-suite

FLOOR PLANS

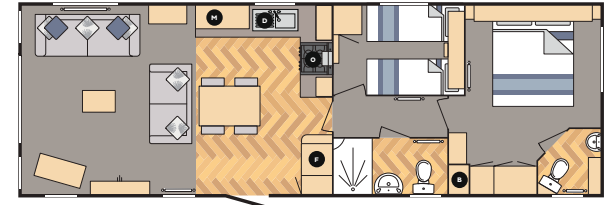

36 X 12 2B

Bed sizes: King Size 1905mm x 1525mm & 2 x Single 1830mm x 685mm

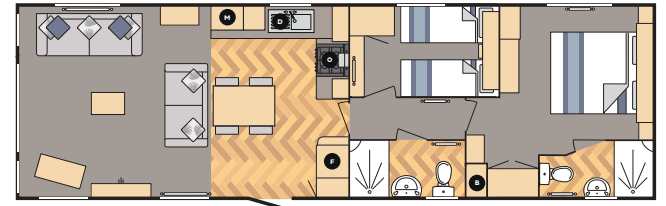

39 X 12 2B

Bed sizes: King Size 1905mm x 1525mm & 2 x Single 1830mm x 685mm

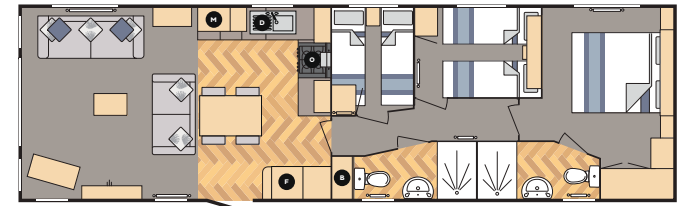

40 X 12 3B

Bed sizes: King Size 1905mm x 1525mm, 2 x Single 1830mm x 685mm & 2 x Single 1830mm x 610mm

M Microwave*
 O Oven
 B Boiler
 D Dishwasher*
 F Fridge Freezer

*Optional extra

MELROSE

TAKE A 360 TOUR

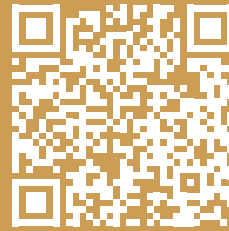

HIGHLIGHT

Modern, open plan layout with warm colour tones





HIGHLIGHT
Stylish freestanding dining table
with padded chairs



HIGHLIGHT

Sleek handle-less design kitchen
with ample storage



MELROSE



Master Bedroom



Bathroom



Second Bedroom



Master Bedroom



Main Bathroom



Shown with optional Anthracite grey uPVC glazing and Outlook Sliding patio doors

THE CARNABY STANDARD

- Carnaby Comfort mattresses
- Comfortable 'Carnaby Sit' seating
- 7-ft-high walls with vaulted ceilings
- Colour co-ordinated scatter cushions to sofa
- USB charging sockets in lounge & bedrooms
- Externally vented cooker hood extractor
- Exterior lighting to doors
- Voiles to selected windows
- Super soft underlay to all carpeted areas
- Utility storage cupboard

FEATURES

EXTERIOR

- Matt Champagne aluminium cladding
- Reversible tow bar facility
- Exterior lighting to side door
- Painted Chassis with pre-galvanised Legs
- Available as an Outlook layout (on units over 32')

HEATING & INSULATION

- External pipe lagging
- Fibreglass wall insulation

Available with optional Ultra Warm upgrade which includes;

- External pipe lagging
- Fibreglass wall insulation
- Fibreglass roof insulation with Vapour barrier
- Fibreglass under-floor insulation
- uPVC double glazing

LOUNGE & DINING

- Stain protective coating to sofa fabric
- Carnaby crafted media unit with space for up to 65" tv
- Wraparound freestanding sofa with scatter cushions
- Accent armchair with contrast scatter cushion
- Free standing dining table and chairs
- USB charging sockets in lounge
- Wall mounted TV point
- Coffee table

KITCHEN

- Gas oven & grill (twin cavity) with four burner hob
- Integrated fridge/freezer
- Textured stainless steel sink, drainer and mixer tap
- Venetian blind
- Dividing door to hallway

BEDROOMS

- Carnaby Comfort mattresses
- Feature mirrors
- Coordinated upholstered headboards
- Reading lights to main bed headboard
- Wardrobes, bedside tables and dresser with stool
- Bedside USB charging sockets

BATHROOMS

- Family bathroom with thermostatically controlled shower
- Bathroom cabinet with mirror
- Sculpted counter top wash basins with vanity units
- Venetian blind
- Extractor fan to shower bathroom

FLOOR PLANS

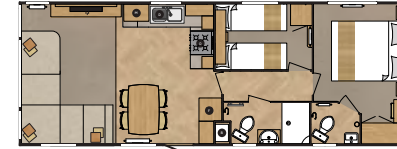

32 X 12 2B
King Size 1905mm x 1525mm & 2 x Single 1830mm x 685mm

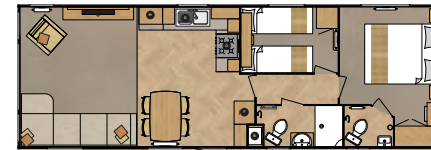

35 X 12 2B
King Size 1905mm x 1525mm & 2 x Single 1830mm x 685mm



36 X 12 3B
Double 1905mm x 1370mm, 2 x Single 1830mm x 685mm & 2 x Single 1830mm x 610mm

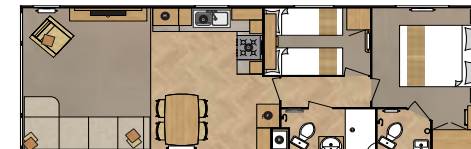

37 X 12 2B
King Size 1905mm x 1525mm & 2 x Single 1830mm x 685mm

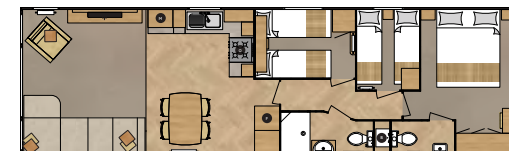

39 X 12 3B
King Size 1905mm x 1525mm, 2 x Single 1830mm x 685mm & 2 x Single 1830mm x 610mm

- M** Microwave*
- O** Oven
- B** Boiler
- D** Dishwasher*
- F** Fridge Freezer

*Optional extra

MELROSE CL

TAKE A 360 TOUR

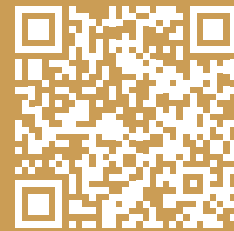

HIGHLIGHT

Central living layout with bedrooms at both ends





HIGHLIGHT

Sleek handle-less design kitchen
with ample storage







THE CARNABY STANDARD

- Carnaby Comfort mattresses
- Comfortable 'Carnaby Sit' seating
- 7-ft-high walls with vaulted ceilings
- Colour co-ordinated scatter cushions to sofa
- USB charging sockets in lounge & bedrooms
- Externally vented cooker hood extractor
- Exterior lighting to doors
- Voiles to selected windows
- Super soft underlay to all carpeted areas
- Utility storage cupboard

FEATURES

EXTERIOR

- Matt Champagne aluminium cladding
- Reversible tow bar facility
- Exterior lighting to door
- French Doors
- Painted Chassis with pre-galvanised Legs

HEATING & INSULATION

- External pipe lagging
- Fibreglass wall insulation

Available with optional Ultra Warm upgrade which includes;

- External pipe lagging
- Fibreglass wall insulation
- Fibreglass roof insulation with Vapour barrier
- Fibreglass under-floor insulation
- uPVC double glazing

LOUNGE & DINING

- Wraparound freestanding sofa
- Stain protective coating to sofa fabric
- Carnaby crafted media unit with space for up to 55" tv
- Free standing dining table and chairs
- USB charging sockets in lounge
- Wall mounted TV point
- Lounge scatter cushions
- Coffee table
- Optional vision pack reveal TV and extra window

KITCHEN

- Gas oven & grill (twin cavity) with four burner hob
- Integrated fridge/freezer
- Textured stainless steel sink, drainer and mixer tap
- Venetian blind

BEDROOMS

- Carnaby Comfort mattresses
- Feature mirrors
- Coordinated upholstered headboards
- Reading lights to main bed headboard
- Wardrobes, bedside tables and dresser with stool
- Bedside USB charging sockets
- 3' beds to 2nd bedroom (2 bedroom model only)

BATHROOMS

- Family bathroom with thermostatically controlled shower
- Bathroom cabinets with mirrors
- Sculpted counter top wash basins with vanity units
- Venetian blinds
- Extractor fan to both bathrooms

FLOOR PLANS



38 X 12 2B

Bed sizes: King Size 1905mm x 1525mm & 2 x Single 1830mm x 915mm



39 X 12 3B

Bed sizes: King Size 1905mm x 1525mm, 2 x Single 1830mm x 685mm & 2 x 1830mm x 760mm

- M** Microwave*
- O** Oven
- B** Boiler
- D** Dishwasher*
- F** Fridge Freezer

*Optional extra

BAYVIEW

TAKE A 360 TOUR

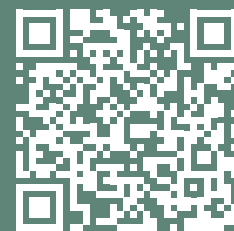

HIGHLIGHT

Comfortable 'Carnaby Sit' fitted corner sofa with storage chaise



BAYVIEW



HIGHLIGHT

Kitchen styled with brushed black counters, light grey doors & light timber accents.



BAYVIEW



Master Bedroom



Master Bedroom



Second Bedroom



Bathroom



Bathroom



THE CARNABY STANDARD

- Carnaby Comfort mattresses
- Comfortable 'Carnaby Sit' seating
- 7-ft-high walls with vaulted ceilings
- Colour co-ordinated scatter cushions to sofa
- USB charging sockets in lounge and bedrooms
- Externally vented cooker hood extractor
- Exterior lighting to doors
- Voiles to selected windows
- Super soft underlay to all carpeted areas
- Utility storage cupboard

FEATURES

EXTERIOR

- Matt Champagne aluminium cladding
- Reversible tow bar facility
- Exterior lighting to side door
- Optional patio door

HEATING & INSULATION

- External pipe lagging
- Fibreglass wall insulation

Available with optional Ultra Warm upgrade which includes;

- 'A' rated Vaillant combi boiler, wet radiators with thermostatic valves
- External pipe lagging
- Fibreglass wall insulation
- Fibreglass roof insulation with Vapour barrier
- Fibreglass under-floor insulation
- uPVC double glazing

LOUNGE & DINING

- Carnaby crafted wall unit with inset fire and TV space
- Wraparound fixed sofa
- Free-standing dining table and chairs
- Flame effect electric fire
- USB charging sockets in lounge

KITCHEN

- Gas oven & grill (twin cavity) with four burner hob
- Integrated fridge/freezer
- Textured stainless steel sink, drainer and mixer tap
- Venetian blind

BEDROOMS

- Carnaby Comfort mattresses
- Feature mirrors
- Coordinated upholstered headboard
- Wardrobes, bedside tables and dresser
- Bedside USB charging sockets

BATHROOMS

- Family bathroom with thermostatically controlled shower
- Bathroom cabinet with mirror to family bathroom and en-suite
- Porcelain pedestal wash basins
- Venetian blinds in bathroom and en-suite

FLOOR PLANS

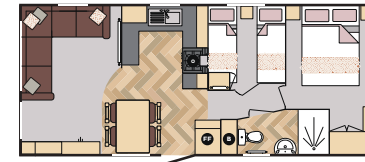

28 X 12 2B

Bed sizes: Double 1905mm x 1370mm & 2 x Single 1830mm x 685mm

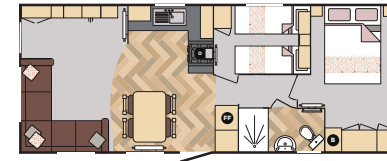

30 X 12 2B

Bed sizes: Double 1905mm x 1370mm & 2 x Single 1830mm x 685mm

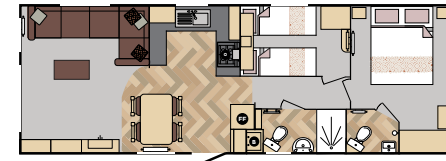

35 X 12 2B

Bed sizes: King Size 1905mm x 1525mm, 2 x Single 1830mm x 685mm



36 X 12 3B

Bed sizes: Double 1905mm x 1370mm, 2 x Single 1830mm x 685mm & 2 x Single 1830mm x 610mm

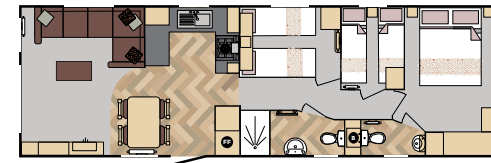

38 X 12 3B

Bed sizes: King Size 1905mm x 1525mm, 2 x Single 1830mm x 685mm & 2 x Single 1830mm x 610mm

B R E A K A W A Y

TAKE A 360 TOUR





BREAKAWAY



HIGHLIGHT

Marble effect work surfaces, oak doors and units with handle-less grey accents



BREAKAWAY



Master Bedroom



Master Bedroom



Second bedroom



Bathroom



Bathroom



THE CARNABY STANDARD

- Carnaby Comfort mattresses
- Comfortable 'Carnaby Sit' seating
- 7-ft-high walls with vaulted ceilings
- Colour co-ordinated scatter cushions to sofa
- USB charging sockets in lounge and bedrooms
- Externally vented cooker hood extractor
- Exterior lighting to doors
- Voiles to selected windows
- Super soft underlay to all carpeted areas
- Utility storage cupboard

FEATURES

EXTERIOR

- Matt Champagne aluminium cladding
- Reversible tow bar facility
- Exterior lighting to side door

HEATING & INSULATION

- External pipe lagging
- Fibreglass wall insulation

Available with optional Ultra Warm upgrade which includes;

- A' rated Vaillant combi boiler, wet radiators with thermostatic valves
- External pipe lagging
- Fibreglass wall insulation
- Fibreglass roof insulation with Vapour barrier
- Fibreglass under-floor insulation
- uPVC double glazing

LOUNGE & DINING

- Carnaby crafted wall unit
- Wraparound fixed sofa
- Free-standing dining table and benches
- USB charging sockets in lounge

KITCHEN

- Gas oven & grill (twin cavity) with four burner hob
- Freestanding silver finish fridge/freezer
- Textured stainless steel sink, drainer and mixer tap
- Venetian blind

BEDROOMS

- Carnaby Comfort mattresses
- Feature mirrors
- Coordinated headboards
- Wardrobes, bedside tables and dresser
- Bedside USB charging sockets

BATHROOMS

- Family bathroom with thermostatically controlled shower
- Bathroom cabinet with mirror
- Porcelain pedestal wash basin
- Venetian blind

FLOOR PLANS

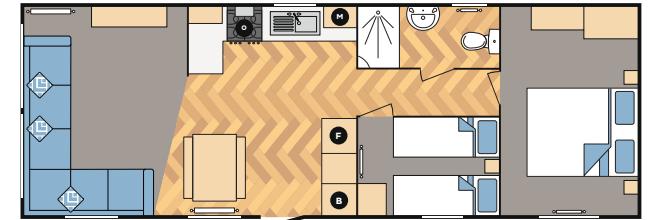

35 X 12 2B

Bed sizes: King Size 1905mm x 1525mm, 2 x Single 1830mm x 685mm

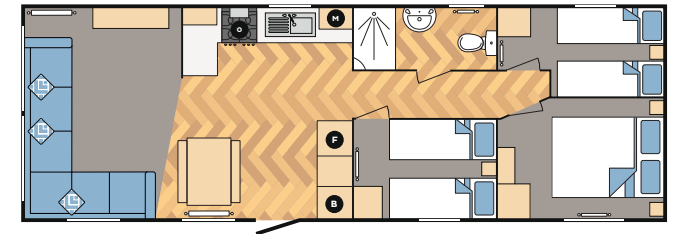

36 X 12 3B

Bed sizes: Double 1905mm x 1370mm, 2 x Single 1830mm x 685mm & 2 x Single 1830mm x 610mm

M Microwave*
 O Oven
 B Boiler
 D Dishwasher*
 F Fridge Freezer

*Optional extra

EXTERNAL SIZES



KEY All dimensions expressed in metres (m)

- | | |
|--|------------------------------------|
| L1 Overall length including tow bar | W1 Overall width including gutters |
| L2 Overall roof length including gutters | W2 Overall body width |
| L3 Body length including bay (if applicable) | H1 Overall height including flues |
| L4 Body length at floor level | H2 Height to ridge |

WARRANTY

Our comprehensive warranty offers protection for your investment and gives you peace of mind.

GET PEACE OF MIND GUARANTEED



- Fully Galvanised Chassis
- Aluminium cladding (Colour fade & corrosion)



- Boilers (Vaillant)
- Electric Fires
- Electric Sockets & Switches
- Taps
- Washbasins & Sanitaryware
- Radiators & Towel Rails**
- Kitchen Sink
- Interior Door Handles
- Gutters, Downpipes & Cladding



- Double Glazed Units and Frames in Windows & Exterior Doors (Excluding Handles and Hinges)
- Pan Tile Roof Sheets
- Wall, ceiling & floor structures



- Fridge-Freezers, Microwaves, Cooker Hoods & Dishwashers

All Carnaby caravans are covered by a minimum 12 months parts and labour warranty* from the date of purchase by the first owner.

* Excluding any damage caused by transport, siting, commissioning, general wear and tear or misuse. Warranty only applies to original purchaser and is non transferable. ** Only a 1 year warranty is provided for radiators positioned in shower rooms and toilets.

	L1	L2	L3	L4	W1	W2	H1	H2	Weight (KG)
BREAKAWAY									
35 x 12 2B	11.77	11.08	10.97	10.67	3.95	3.68	3.47	3.47	3850*
36 x 12 3B	12.07	11.38	11.27	10.97	3.95	3.68	3.47	3.47	4060*
BAYVIEW									
28 x 12 2B	9.74	9.05	N/A	8.64	3.95	3.68	3.47	3.47	3660*
30 x 12 2B	10.35	9.66	N/A	9.25	3.95	3.68	3.47	3.47	3820*
35 x 12 2B	11.76	11.07	N/A	10.66	3.95	3.68	3.47	3.47	4230*
36 x 12 3B	12.07	11.38	N/A	10.97	3.95	3.68	3.47	3.47	4500*
38 x 12 3B	12.78	12.09	N/A	11.68	3.95	3.68	3.47	3.47	4775*
MELROSE									
32 x 12 2B	10.81	10.32	N/A	9.91	3.95	3.68	3.47	3.47	TBC*
35 x 12 2B	11.67	11.18	N/A	10.77	3.95	3.68	3.47	3.47	4630*
36 x 12 3B	11.99	11.05	N/A	11.09	3.95	3.68	3.47	3.47	4670*
37 x 12 2B	12.29	11.88	N/A	11.39	3.95	3.68	3.47	3.47	4660*
39 x 12 3B	12.91	12.42	N/A	12.01	3.95	3.68	3.47	3.47	5040*
MELROSE CL									
38 x 12 2B	12.71	11.81	N/A	11.61	3.95	3.68	3.47	3.47	4920*
39 x 12 3B	13.01	12.11	N/A	11.91	3.95	3.68	3.47	3.47	4960*
SILVERDALE									
36 x 12 2B	11.92	11.43	N/A	11.02	3.95	3.68	3.47	3.47	4510*
39 x 12 2B	12.84	12.35	N/A	11.94	3.95	3.68	3.47	3.47	4860*
40 x 12 3B	13.14	12.65	N/A	12.24	3.95	3.68	3.47	3.47	5130*
CARRINGTON									
36 x 12 2B	11.97	11.48	N/A	11.07	3.95	3.68	3.47	3.47	TBC*
40 x 12 2B	13.14	12.65	N/A	12.24	3.95	3.68	3.47	3.47	5430*
40 x 12 3B	13.14	12.65	N/A	12.24	3.95	3.68	3.47	3.47	TBC*
LAKEHOUSE LODGE									
40 x 13 2B	13.4	12.71	N/A	12.3	4.3	3.98	3.57	3.57	6120*
41 x 13 3B	13.66	12.97	N/A	12.56	4.3	3.98	3.57	3.57	6100*
CHANTRY LODGE									
41 x 13 2B	13.6	12.91	N/A	12.5	4.3	3.98	3.57	3.57	6060*
41 x 13 3B	13.6	12.91	N/A	12.5	4.3	3.98	3.57	3.57	5620*
THE LANGHAM									
41 x 13 2B	13.66	12.76	N/A	12.56	4.3	3.98	3.57	3.57	5630*
GRANTLEY LODGE									
42 x 14 2B	13.9	13.21	N/A	12.8	4.6	4.28	3.61	3.61	6950*

* For CanExel cladding add 500Kg.

All model weights are inclusive of wet radiator heating systems. All dimensions are in metres.

EXTERIOR FINISHES

We have a range of exterior colours and finishes to suit you and your surroundings. Where options allow, holiday homes can be clad in Aluminium, Corelux Aluminium, Embossed Plastic or CanExel.

ALUMINIUM



MATT CHAMPAGNE PLANK

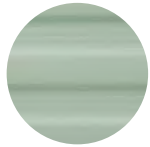

ENVIRONMENTAL GREEN

EMBOSSSED PLASTIC



CREAM



SAND



STONE



GREY

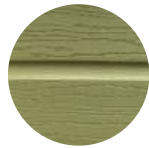

ENVIRONMENTAL GREEN

CANEXEL



BARNWOOD

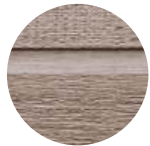

CLIFFSIDE

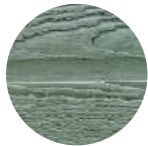

ACADIA ENVIRONMENTAL



MIST GREY

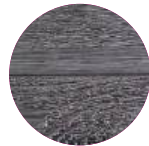

TIMBERWOLF



SAND



SIERRA

CORELUX ALUMINIUM



ACADIA

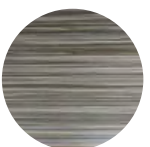

CLIFFSIDE



TIMBERWOLF

KEY	
Standard	S
Optional	O
Not Available	X

		BREAKAWAY	BAYVIEW	MELROSE	MELROSE CL	SILVERDALE	CARRINGTON	LAKHOUSE LODGE	CHANTRY LODGE	LANGHAM	GRANTLEY LODGE
ALUMINIUM	MATT CHAMPAGNE PLANK	S	S	S	S	S	S	S	S	S	S
	ENVIRONMENTAL GREEN	O	O	O	O	O	O	O	O	O	O
EMBOSSSED PLASTIC	CREAM	O	O	O	O	O	O	O	O	O	O
	SAND	O	O	O	O	O	O	O	O	O	O
	STONE	O	O	O	O	O	O	O	O	O	O
	GREY	O	O	O	O	O	O	O	O	O	O
	ENVIRONMENTAL GREEN	O	O	O	O	O	O	O	O	O	O
CANEXEL	BARNWOOD	O	O	O	O	O	O	O	O	O	O
	CLIFFSIDE	O	O	O	O	O	O	O	O	O	O
	MIST GREY	O	O	O	O	O	O	O	O	O	O
	TIMBERWOLF	O	O	O	O	O	O	O	O	O	O
	SAND	O	O	O	O	O	O	O	O	O	O
	SIERRA	O	O	O	O	O	O	O	O	O	O
	ACADIA ENVIRONMENTAL	O	O	O	O	O	O	O	O	O	O
CORELUX	ACADIA	O	O	O	O	O	O	O	O	O	O
	CLIFFSIDE	O	O	O	O	O	O	O	O	O	O
	TIMBERWOLF	O	O	O	O	O	O	O	O	O	O

WINDOW FINISHES

To complement your choice of exterior cladding colour we offer a wide range of uPVC window options.



RUSTIC OAK

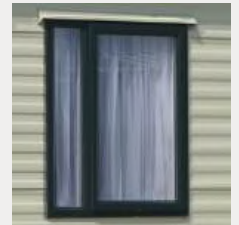

GREEN



GREY
Standard on Grantley Lodge,
The Langham and Chantry Lodge

SPECIFICATIONS, FEATURES AND OPTIONS

KEY
 Standard S
 Optional O
 Not Available X

	GRANTLEY LODGE	THE LANGHAM	CHANTRY LODGE	LAKEHOUSE LODGE	CARRINGTON	SILVERDALE	MELROSE	MELROSE CL	BAYVIEW	BREAKAWAY
EXTERIOR										
Aluminium Cladding	S	S	S	S	S	S	S	S	S	S
Plastic Cladding	O	O	O	O	O	O	O	O	O	O
CanExel Cladding	O	O	O	O	O	O	O	O	O	O
Environmental Colours (Cladding and Glazing)	O	O	O	O	O	O	O	O	O	O
Coloured uPVC Glazing	S	S	S	O	O	O	O	O	O	O
Painted Chassis with Pre-Galvanised Legs	X	X	X	X	S	S	S	S	S	S ¹⁵
Fully Galvanised Chassis	S	S	S	S	O	O	O	O	O	O
Reversible Tow Bar Facility	S	S	S	S	S	S	S	S	S	S
uPVC Double Glazing	S	S	S	O	O	O	O	O	O	O
Exterior Light	S	S	S	S	S	S	S	S	S	S
Single Front Door	X	X	X	X	X	X	X	X	O ⁵	X
French Doors	X	O	X	S	X	O	X	S	X	X
Sliding Double Patio Door	S	X	S	X	X	X	X	X	X	X
Sliding Single Patio Door	X	O	X	O	O	O	X	X	O	X
Velux Roof Window	S	O	O	O	O	O	O	O	O	O
Vision Pack Including Remote Reveal Television	X	X	X	X	X	X	X	O	X	X
HEATING & INSULATION										
External Pipe Lagging	S	S	S	S	S	S	S	S	S	S
Fibreglass Wall Insulation	X	X	X	S	S	S	S	S	S	S
Ultra Warm Upgrade	S	S	S	O	O	O	O	O	O	O
Ultra Warm Plus Upgrade	O	O	O	O	O	O	O	O	O	O
Trace Heating	O	O	O	O	O	O	O	O	O	O
BS3632 Residential Specification, includes uPVC Plastic Cladding	O	O	O	O	X	X	X	X	X	X
Electric Panel Heaters	O	O	O	O	O	O	O	O	O	O

	GRANTLEY LODGE	THE LANGHAM	CHANTRY LODGE	LAKEHOUSE LODGE	CARRINGTON	SILVERDALE	MELROSE	MELROSE CL	BAYVIEW	BREAKAWAY
--	----------------	-------------	---------------	-----------------	------------	------------	---------	------------	---------	-----------

	GRANTLEY LODGE	THE LANGHAM	CHANTRY LODGE	LAKEHOUSE LODGE	CARRINGTON	SILVERDALE	MELROSE	MELROSE CL	BAYVIEW	BREAKAWAY
LOUNGE & DINING										
Net Curtains/Voile on Selected Windows	S	S	S	S	S	S	S	S	S	S
Carpet Underlay	S	S	S	S	S	S	S	S	S	S
Stain Protective Coating to Sofa Fabric	S	S	S	X	X	S	S	S	S	X
Dining Table & Chairs	S ⁹	S	S	S	S	S	S	S	S	O ⁹
Additional Dining Chair	O	O	O	O	O	O	O	O	O	O
USB / USB C Charging Sockets in Lounge	S	S	S	S	S	S	S	S	S	S
Dining Stool	O	O	O	O	O	O	S	S	O	O
Bluetooth Lounge Ceiling Speakers	S	S	O	O	O	O	O	O	O	O
Wall Mounted TV Point (HDMI, Mains Socket, Aerial Coaxial)	S	S	S	O	S	O	S	S	O	O
Make-up Bed in Lounge	O	X	X	O	O	X	S	S	O	O
Air-Divan	O	O	O	O	O	O	O	O	O	O
Lounge Scatter Cushions	S	S	S	S	S	S	S	S	S	S
Coffee Table	X ⁹	X ⁹	X ⁹	S	X ⁹	S	S	S	O	O
KITCHEN										
Electric Fan Assisted Oven and Grill (Single Cavity)	S	S	X	S	S	S	X	X	X	X
90cm Dual Fuel Range Cooker	X	X	S	X	X	X	X	X	X	X
Five Burner Gas Hob	S	S	X	X	X	X	X	X	X	X
Four Burner Gas Hob	X	X	X	S	S	S	X	X	X	X
Externally Vented Cooker Hood Extractor	S	S	S	S	S	S	S	S	S	S
Gas Oven & Grill (Twin Cavity) & Four Burner Hob	X	X	X	X	X	X	S	S	S	S
Free-standing Microwave Oven	X	X	X	X	X	O	O	O	O	O
Integrated Microwave Oven	S	S	S	S	S	O	O	X	O	O
Integrated Dishwasher	S	S	S	O	O	O	O	O	O	O
Integrated Fridge/Freezer	S	S	S	S	S	S	S	S	S	O
Free-standing Fridge Freezer	X	X	X	X	X	X	X	X	X	S
Plinth Lighting	O	O	O	O	O	O	O	O	O	O
Dividing Door to Hallway	S	X	S	S	S	S	S	X	O	O
Integrated Washing Machine	O ¹	O ¹	O ¹	O ¹	O ¹	O	X	O	X	X
Integrated Washer/Dryer	O ¹	O ¹	O ¹	O ¹	O ¹	O	X	O	X	X
Wine Cooler	S	X	X	X	X	X	X	X	X	X
Boiling Water Kitchen Tap	S	X	X	X	X	X	X	X	X	X

KEY

Standard	S
Optional	O
Not Available	X

GRANTLEY LODGE	THE LANGHAM	CHANTRY LODGE	LAKEHOUSE LODGE	CARRINGTON	SILVERDALE	MELROSE	MELROSE CL	BAYVIEW	BREAKAWAY
----------------	-------------	---------------	-----------------	------------	------------	---------	------------	---------	-----------

BEDROOMS									
Bedding Set (Duvet Covers, Pillow Cases & Runners)	O	O	O	O	O	O	O	O	O
Tufttained Mattress (Single)	O	O	O	O	O	O	O	O	O
Tufttained Mattress (Double)	O	O	O	O	O	O	O	O	O
Gas Strut Lift Up Storage Bed (Master Bedroom Only)	X	X	S	S	O	O	O	O	O
Space Saving Fold Under Bed (Second Bedrooms Only)	X	X	O	O	O	O	O	O	O
Divan Beds	S	S	X	X	X	X	X	X	X
Mosquito Nets & Blinds (Bedroom windows only)	X	X	O	O	O	O	O	O	O
USB / USB C Charging Sockets in Bedrooms	S	S	S	S	S	S	S	S	S
TV Aerial Booster	O	O	O	O	O	O	O	O	O
TV Point in Main Bedroom	S	S	S	S	S	O	O	O	O
TV Point in Second Bedroom	S	S	S	O	O	O	O	O	O
TV Point in Third Bedroom	X	X	S	O	O	O	O	O	O
BATHROOMS									
Extractor Fan to shower bathroom (s)	S	S	S	S	S	S	S	S	O
Family Bathroom with Shower	S	S	S	S	S	S	S	S	S
En-suite Bathroom with Shower	S	S	S	S	S ²	S ²	X	S	X
Family Bathroom with Bath	X	X	O ³	X	X	X	X	X	X

*1) Plumbing and electrics fitted as standard
 *2) Not available on Carrington - 36 x 12 2B or Silverdale - 36 x 12 2B
 *3) 3 Bedroom Model Only
 *4) 2 Bedroom Model Only
 *5) Painted legs on Breakaway models
 *6) Optional on 28x12 2B and 30x12 2B only
 *7) Dining table, bench seating standard in Breakaway models
 *8) Dining table, bench seating and 2 x chairs standard in Grantley Lodge
 *9) Upholstered footstool as standard

ENERGY SAVING STANDARDS

Comfort comes in many forms which is why we've invested in the insulation properties of all our holiday homes.

Carnaby's research and development team have focused on the insulation values of the walls, floors, ceilings and windows - improving comfort levels and saving energy in all our holiday homes fitted with our Ultra Warm or Ultra Warm Plus options.



ULTRA WARM UPGRADE

- ✓ Wet System Radiators with Thermostatic Radiator Valves
- ✓ Fibreglass Wall Insulation
- ✓ Roof Insulation with Vapour Barrier
- ✓ Under-Floor Insulation Fibreglass
- ✓ uPVC Double Glazing



ULTRA WARM PLUS UPGRADE

- ✓ Wet System Radiators with Thermostatic Radiator Valves
- ✓ High Density Fibreglass Wall Insulation
- ✓ High Density Roof Insulation with Vapour Barrier
- ✓ Under-Floor Insulation Fibreglass
- ✓ uPVC Double Glazing 'Low E' Glass Argon filled.



1990
CARNABY
Turn your dreams into reality

WWW.CARNBYCARAVANS.COM

DISCLAIMER

Table settings, ornaments, toys, electrical appliances, duvet covers and pillowcases as displayed are intended for photographic purposes only and, unless otherwise specified in writing, do not form any part of any contract, nor do they constitute any representation whatsoever by us or on behalf of Carnaby Caravans Ltd. All dimensions are approximate sizes. Carnaby reserves the right to change any materials, fittings etc, shown in this brochure without prior notice in accordance with our policy of continual improvement or availability of material. The model designated size does not denote the body length or width. All Carnaby holiday homes must be connected to mains water, sewerage, electricity, and propane gas (unless otherwise specified).

Caravan holiday homes are designed to provide comfortable, high-quality accommodation for holiday and recreational use only; recreational use should be considered to include holidays of not more than six weeks of continuous use, weekend visits, and other short duration visits. They are not designed for residential occupancy.

Caravan holiday homes are built to EN1647 specification. If you are intending to live permanently in a caravan holiday home or stay in one for non-recreational use you should consider purchasing a residential park home built to BS3632 specification, which is sited on a licensed residential park. If the above advice is not followed and your caravan holiday home is used as a main residence then the manufacturer's warranty may be compromised.

Grantley Lodge, The Langham, Chantry Lodge and Lakehouse Lodge are, as an optional extra, available in BS3632 specification which has the advantage of 0% VAT on the construction element. Please refer to the Park Licence and associated planning conditions when selecting either a holiday home built to EN1647 specification or a BS3632 residential specification unit.

We have made every effort to make the colours and finishes printed in this brochure as close as possible to the colours and finishes of our caravan exteriors and contents. However, we cannot guarantee an exact match in colours and finishes and the images in this brochure should not be relied on as such. The representation of colours are limited by technology and may vary due to the printing process.

PLEASE ASK YOUR DEALER OR PARK TO CONFIRM PRICES

For product information call:

01262 679971

For general enquiries email:

info@carnabycaravans.com

For sales enquiries email:

sales@carnabycaravans.com



CARNABY CARAVANS LIMITED

Lancaster Road, Carnaby Industrial Estate, Bridlington,
East Riding of Yorkshire YO15 3QY