



# Pemberton

P A R K & L E I S U R E H O M E S





# CELEBRATING 80 YEARS OF EXCELLENCE



1946 - 2026  
GENERATIONS OF COMFORT,  
A FUTURE OF INNOVATION



**Pemberton**  
PARK & LEISURE HOMES

# Our Story - Celebrating 80 Years of Pemberton

In 2026, Pemberton Park and Leisure Homes proudly celebrates 80 years at the forefront of the UK's caravan and leisure home industry. From modest beginnings in the post-war 1940s to becoming one of the most respected names in the sector, our journey has been defined by innovation, quality, and customer loyalty.

It all began on the outskirts of Wigan, in a place called Pemberton, where two entrepreneurial brothers began converting old railway carriages and buses into basic holiday accommodation. That pioneering spirit set the foundation for a company that would go on to shape the very industry it helped create.

Throughout the decades, Pemberton has consistently led the way. In the 1980s, we were among the first to introduce 12ft wide homes to the market. We also broke new ground by launching one of the first accessible holiday homes tailored specifically for wheelchair users and people with disabilities, helping to set new standards for inclusivity.

In the 1990s, Pemberton homes redefined comfort and design in the industry, with superior insulation, electric heating, and elegant interiors. Our commitment to excellence was recognised in 1992 with the prestigious Caravan Holiday Home of the Year award. The 2000s brought further innovation, including the launch of the first 14ft wide model and, in 2011, our award-winning twin unit, which secured Best Twin Unit in both 2011 and 2012.

Today, our homes remain synonymous with craftsmanship, luxury, and long-lasting quality. We are proud to be the first leisure home manufacturer to offer the option of upgrading any model to Residential Specification, allowing our customers to enjoy their Pemberton all year round.

As we approach our 80th anniversary, we're not only reflecting on our rich heritage, but we're also looking forward. With continued investment in sustainable design, energy-efficient materials, and cutting-edge features, Pemberton remains committed to building the next generation of holiday and leisure homes.

## What Makes a Pemberton Home Different?

The difference lies in the detail. From high-spec construction to energy-saving features, every Pemberton home is designed with care, expertise, and a deep understanding of our customers' needs. Our longstanding commitment to quality and personalisation has earned us a loyal customer base, many of whom return time and again, with some families choosing Pemberton homes for generations.

Join us in celebrating 80 years of Pemberton—a legacy of quality, innovation, and homes designed for lasting memories.



## Contents

	Page
Contents & History	3
The Pemberton Design & Building Process	4
Pemberton Family & Membership Benefits	5
Buyers Guide	6
Where to view	7
Residential Specification BS3632	8
Platinum Collection	9
The Pemberton Range	10 - 79
Features Checklist	80 - 82
Cladding, Windows, Doors & Decking	82 - 83
Beds & Bed Sizes	84
Dimensions/Siting & Assembly	85
Refresh Your Pemberton	86
Pemberton Warranty	87



# The Pemberton Design & Building Process

## 1 Imagining

The Design Team collate information from customers, parks and the sales team. We value feedback to design the ultimate homes for our customer needs. They also look at market trends and visit trade shows to procure new products.



## 2 Designing

A design is conceived and then the hard work of engineering the new home begins. Regulations and standards are conformed to and materials and components are carefully selected to provide optimum performance and aesthetics.



## 3 Building

The final stage is to prototype the new home. This is carried out in our manufacturing facility here in Wigan. Our skilled tradesmen and design team work together to build the prototype. Feedback and data is gathered before the official launch.



## 4 Supplying

All our homes go through a rigorous quality and standards check. Our quality team conduct thorough inspections in the factory before despatch and also after it has reached its new location. All our homes are inspected and signed off by qualified inspectors for EN1647 or BS3632.

## Standard on All Models

- Twin-axle chassis (exc 28ft & 30ft avon)
- Tongue & grooved p5 moisture resistant floor boarding
- Lagged hot & cold water exterior pipework
- Pitched pan tile roof & domestic gutters
- Exterior Lighting
- Thermostatic mixer to bath or shower
- LED lighting
- Externally vented cooker hood
- Gas oven, grill and hob/cooker with electric ignition
- Dining table with chairs
- Fabric covered lounge seating/suite
- Flame-effect electric fire (except Skydale)
- TV booster
- TV point in main bedroom
- Extractor fan to bathroom/shower
- Fire extinguisher, smoke detector & carbon monoxide detector

## Optional On All Models

- BS3632 - Residential Specification
- Canaxel Cladding
- Stucco Render Cladding
- Grain Effect Plastic Cladding (standard on twin homes)
- Bluetooth surround sound
- Electric convector/panel heaters
- All electric option
- Auto-stop valve
- Trace-heating
- Lift-up storage bed
- Security safe
- Sky TV cabling
- External tap
- Platinum upgrade



# Pemberton Family & Membership Benefits

Pemberton have a wonderful group of loyal owners who love our brand and will not settle for another. New customers are also discovering the virtues of a Pemberton home and the life changing aspects it can bring. With this in mind we have created an owners club called the Pemberton Family.

Becoming part of the 'Family' could not be easier. Simply register your Warranty Card, which is enclosed within your Owners Handbook by using the QR code or returning the completed pre-paid card by post. Once you have registered you will be given the option to join the Owners Club.



Scan here to register your warranty.



## Show Tickets

A selection of free show tickets for some of the best park and holiday home shows the UK has to offer.



## Model Previews

Invitation to view new Pemberton Homes before they are launched to the general public.



## Competitions

An opportunity to win some fantastic prizes.



## Regular Newsletters

Informative newsletters giving you the lowdown on everything Pemberton.



## Consumer Feedback

Your opinions count. Get involved in the process of creating our homes for the future.



## Referral scheme

We know that our happy home owners love to shout about their Pemberton.

Why not refer a friend so they can share in the joy of owning a Pemberton home. Terms and Conditions apply.

Tel: 01942 321 221

Email: [info@pembertonlh.co.uk](mailto:info@pembertonlh.co.uk)

[www.pembertonlh.co.uk](http://www.pembertonlh.co.uk)



# Building a better future...

## ENERGY EFFICIENCY

### The Economic Pemberton

To address the growing need for energy-efficient lifestyles, we have devoted considerable effort to enhancing our static homes to maximise the advantages offered by cutting-edge technology:

1. The integration of low-energy lighting throughout our entire collection.
2. Utilisation of A-rated appliances wherever applicable, ensuring optimal energy efficiency.
3. Inclusion of superior insulation as a standard feature, providing excellent thermal performance.
4. Employment of low dual-flush toilet cisterns, contributing to water conservation.
5. The option of energy-efficient Low-E glass Argon filled double-glazed windows, available across all our models, further enhancing thermal insulation and reducing energy consumption.

## CARBON FOOTPRINT

### The Greener Pemberton

At Pemberton, we prioritise the reduction of our carbon footprint by employing sustainable practices in the construction of our homes. Our unwavering commitment to environmental responsibility is reflected in several key aspects of our designs.

In line with our dedication to sustainability, we actively implement waste segregation and recycling practices to minimise our ecological impact. Materials such as wood, aluminium, plastic, cardboard, and more than 95% of the timber used in the construction of our caravans are sourced from sustainably managed forests, reinforcing our commitment to responsible sourcing and environmental stewardship.

# Pemberton Options

Here at Pemberton, we understand that selecting the right elements for your home is crucial to ensuring long-term satisfaction. From choosing the type of cladding and the colour of external windows and doors to deciding on integrated appliances like a wine cooler, we offer expert guidance to our customers throughout the decision-making process.

By providing advice and insights into the various options available, we aim to assist our customers in making informed choices that align with their preferences and needs. Our goal is to ensure that the homes our customers select continue to bring them joy and meet their expectations for years to come. For further information see our comprehensive Features Checklist on pages 80-82.

**Did you know that as a landowner you can buy direct from Pemberton? Speak to our sales team for further information.**



Vinylit option shown, made from 100% recycled plastic.



# Where to view

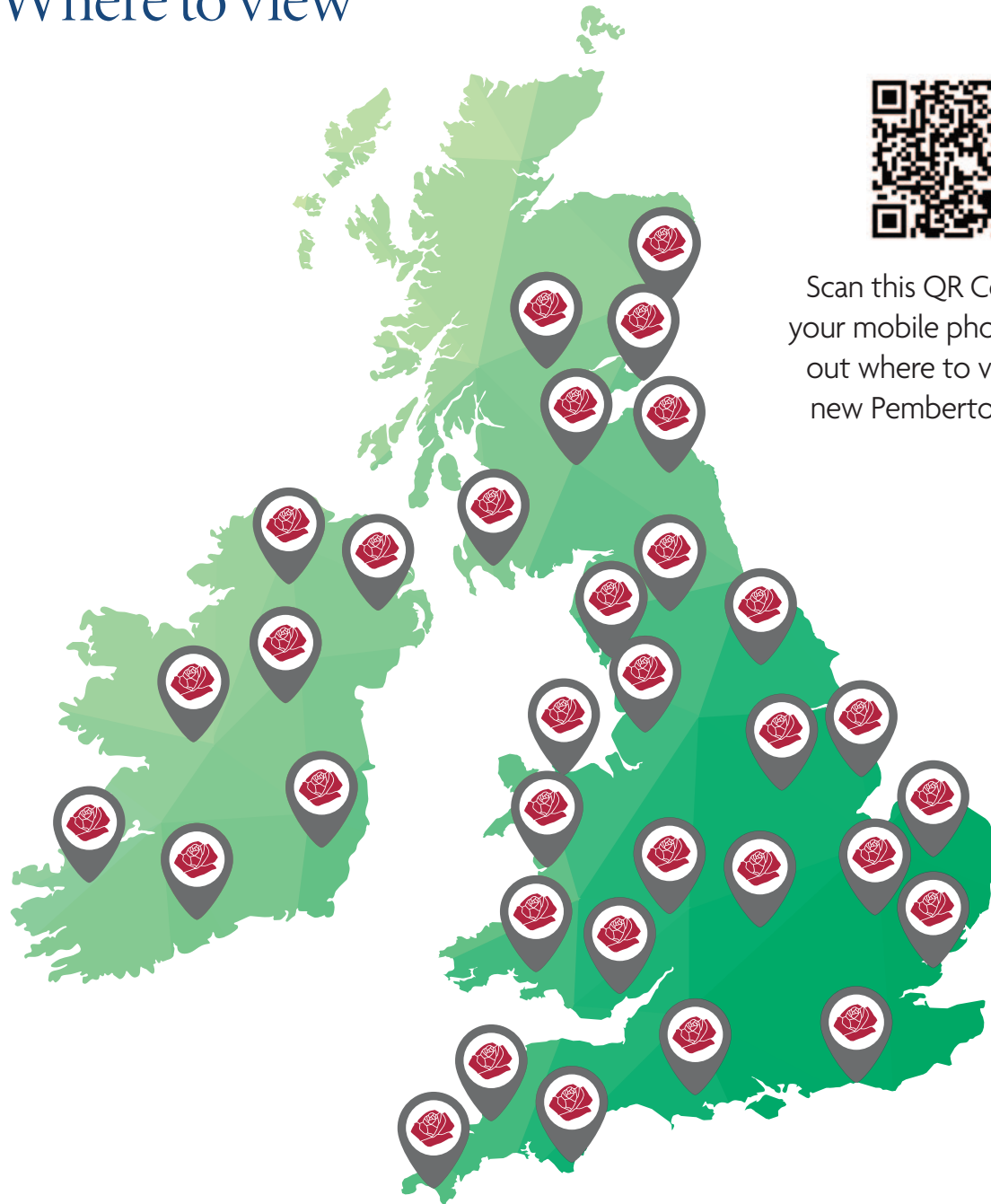

Scan this QR Code with your mobile phone to find out where to view your new Pemberton home.

## ENGLAND

**PEMBERTON HEAD OFFICE (Lancashire)**  
Woodhouse Lane, Wigan,  
Lancashire WN6 7NF  
Tel: 01942 321221

**ISLAND MEADOWS HOLDENS PARKS (Chichester)**  
Holdens Caravan Park, Bracklesham Lane  
Bracklesham, Chichester, West Sussex  
PO20 8JG  
Tel: 01243 670207

## WALES

**PEMBERTON (Haverfordwest)**  
Newgale Coast Holiday Park,  
Newgale, Haverfordwest,  
Wales, SA62 6BD  
Tel: 01437 710675

## NORTHERN IRELAND

**PEMBERTON (Portstewart)**  
Bonalston Caravans  
80 Mill Road,  
Portstewart, BT55 7SW  
028 70833 308

## SCOTLAND

**PEMBERTON (St Andrews)**  
Stewarts Resorts, Cameron  
St Andrews KY16 8PE  
Tel: 07717 896 821

[www.pembertonlh.co.uk](http://www.pembertonlh.co.uk)



**Pemberton**  
PARK & LEISURE HOMES

The first choice for your new home

# Distinguishing Between BS3632 and EN1647 Lodges

We are delighted to announce that all Pemberton Park & Leisure Homes are built to the superior BS3632 Residential Specification standard. While EN1647 sets the European benchmark for caravan holiday homes intended exclusively for temporary or seasonal use, BS3632 models are designed for permanent residency (subject to site licensing) and year-round habitation.

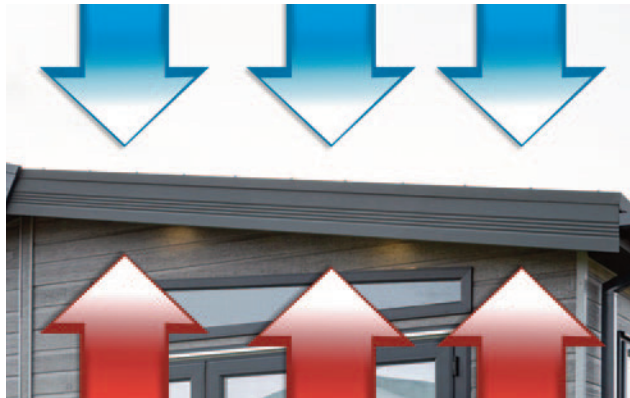

## What is BS3632 – 2023 Residential Specification?

Initially introduced in 1963, BS3632 represents the British Standard against which all our homes can be constructed. This standard, overseen by The British Standards Institution (BSI), is dedicated to fostering best practices and excellence. The objective of BS3632 is to ensure that residential units offer a secure and comfortable place to live.

In 2015, the British Standard underwent a revision to align more closely with conventional housing norms. A primary focus of BS 3632:2015 was the enhancement of energy efficiency, contributing to the reduction of the ecological footprint of residential park homes in recent years.

The latest iteration, BS 3632:2023, builds upon the foundational principles of its predecessor. In response to an evolving landscape of sustainability, this revision integrates improvements targeting heat loss through the external structure, ventilation enhancements, and vapour control measures. Additionally, the new standard incorporates enhanced safety features and refined construction guidelines.

**Insulation** – Enhanced thermal insulation significantly enhances the comfort of our homes. Thermal performance is measured as a U-value and the lower the figure the better. BS3632-2023 has improved on these and our roof, walls, floors and windows all exceed this regulation.. Our team of qualified engineers meticulously calculates U-values to ensure that each home meets or surpasses regulatory requirements across roofs, walls, floors, and windows.

**Soundproofing** – BS3632-2023 sets higher benchmarks for soundproofing within walls. Our walls are rigorously acoustically tested in a laboratory by qualified professionals to ensure compliance. The result is a high quality wall to make living in one of our homes both quiet and relaxing.

**Heating Systems** – BS3632-2023 mandates the inclusion of heating and hot water systems, precisely tailored to optimise homeowner comfort. We offer a diverse range of heating and hot water options, from LPG combination boilers to all-electric systems, to accommodate various preferences.

**Vapour Control** – The pursuit of improved energy efficiency has increased the risk of condensation within homes. To address this concern, the new standard incorporates performance criteria aimed at enhancing ventilation and improving indoor air quality.

**Enhanced Safety** – BS3632-2023 incorporates updates to enhance residential safety. Mandatory installation of graded smoke and heat alarms, along with improvements in means of egress, further underscores our commitment to ensuring homeowner safety.

Each and every home manufactured in our state of the art facility undergoes rigorous testing overseen by qualified inspectors. We ensure compliance with the latest regulations encompassing BS3632, as well as electrical and gas safety standards. Our unwavering dedication to delivering safe and comfortable homes remains a cornerstone of our ethos.

# Platinum Collection

All Pemberton loges are eligible for the Platinum Package which is something very special and gives you many of the features that are found at home from wallpaper to a Hive system.

- Aggregate Coated Steel Tile System with a 40 Year Weatherproof Warranty
- Wood effect Panelled Ceiling
- Wallpaper Finish or Painted panel finish (Skydale)
- Domestic Skirting and Door Casings
- Electric Combination Safe
- Hive Heating System
- Wine Cooler (where applicable)
- Bluetooth Speakers
- Outdoor Tap



Avon

Regent

Marlow

Marlow  
Centre lounge

Abingdon

Rivington

Langton

Park Lane

Knightsbridge

Arrondale Lodge

Rivendale Lodge

Glendale Lodge

Kingsdale Lodge

Skydale Lodge

# Avon

Whilst the Avon has Pemberton's smallest model in its range – 28ft x 10ft 2 bed - there is certainly no compromise on style or design. In fact you can expect the same standard of fixtures and fittings as well as clever storage and attention to detail as you would throughout the rest of the range. The 40ft x 13ft allows for an abundance of space in the lounge and the flexibility of freestanding sofas. In addition the Avon can be turned into a lodge with Canexel cladding which is something very special for a 12 ft home.



Image shows 40x13 2 bed



Pemberton Avon 35 x 12 2 bed shown with standard Seafoam Aluminium Cladding & White Windows & optional front French Doors

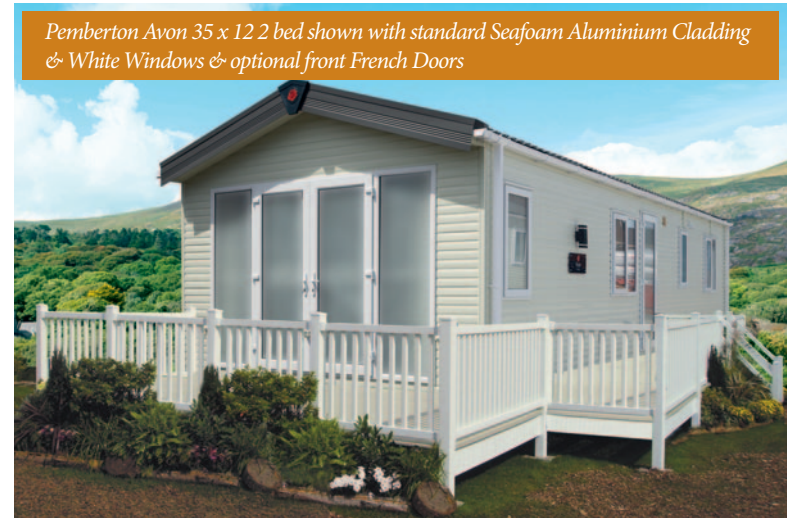

The option for French doors to the front elevation gives this model the versatility to create an outdoor space with a Pemberton deck if the pitch allows. Vintage gold, grey and creams feature against crafted wooden accents throughout the sociable, open plan front areas. The new addition of a walk-in wardrobe in certain models creates volumes of storage in the master bedroom where shelving cabinets elegantly frame the headboard.

Image shows 35x12 2 bed



### Highlights

- Wall mounted flame effect fire
- Fixed lounge seating incorporating a sofa bed / freestanding seating in 40ft model
- Accent chair
- En-suite toilet facilities (except in 28x10ft & 30x12ft)
- Windows to front aspect
- Integrated cooker with separate oven and grill
- DVD unit
- Contrast dining chairs

28ft x 10ft	2 bedroom
30ft x 12ft	2 bedroom
32ft x 12ft	2 bedroom
35ft x 12ft	2 & 3 bedroom
38ft x 12ft	2 & 3 bedroom
40ft x 13ft	2 bedroom

# Avon

## Residential Specification Option includes the following:

- Roof 250mm insulated
- 125mm thick wall
- Floor minimum 120mm insulated
- Windows low E glass and Argon filled
- Superior Insulation U values exceeding the British Standard

### Key

- |   |   |
|---|---|
|  |  |
|  |  |
|  |  |
|  |  |
|  |  |
|  |  |
|  |  |

28ft x 10ft - 2 bedroom

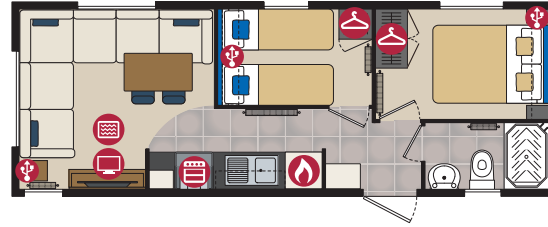

30ft x 12ft - 2 bedroom

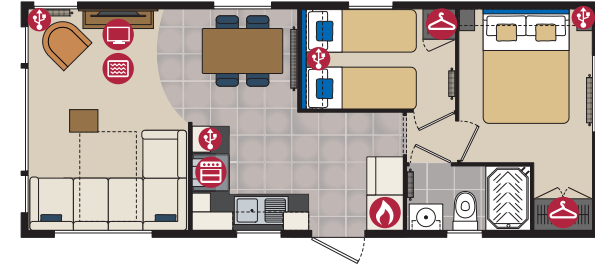

32ft x 12ft - 2 bedroom

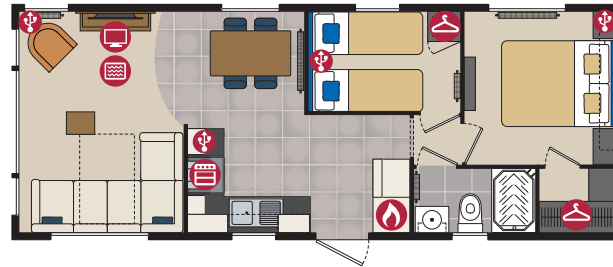

35ft x 12ft - 2 bedroom

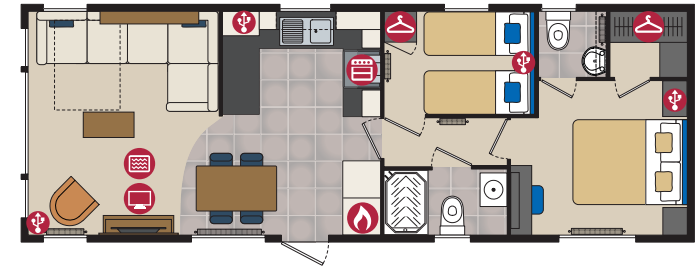

35ft x 12ft - 3 bedroom

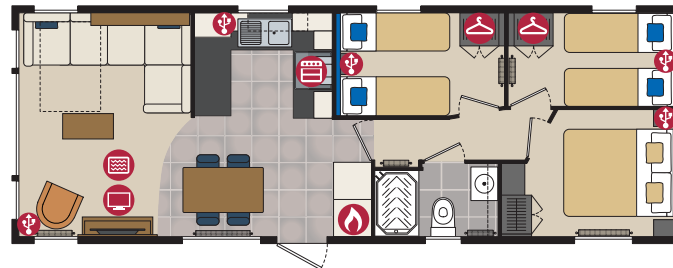

38ft x 12ft - 2 bedroom

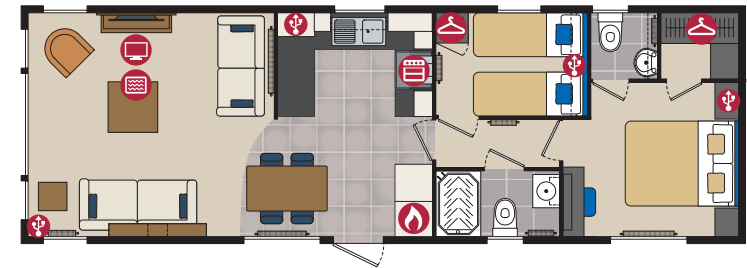

38ft x 12ft - 3 bedroom

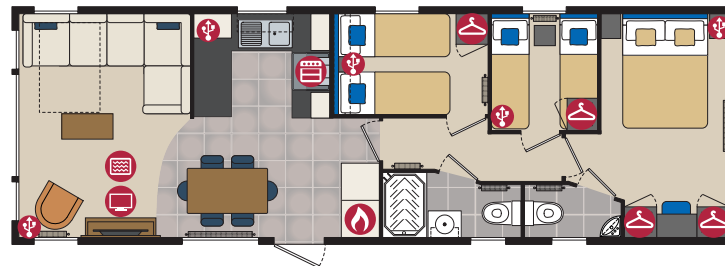

40ft x 13ft - 2 bedroom

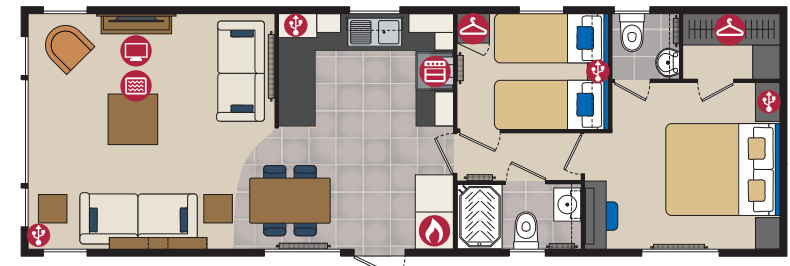

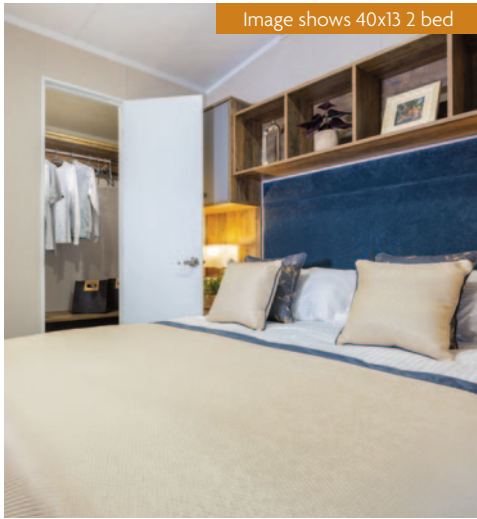

Image shows 40x13 2 bed



Image shows 40x13 2 bed



Image shows 40x13 2 bed



Image shows 40x13 2 bed

### Options available to order

- Residential Specification to BS3632 available in all cladding types
- Gas combi central heating system with thermostatic radiator valves
- PVCu double glazing
- French doors to front elevation
- Integrated dishwasher and washer/dryer (excluding 28ft & 30ft)
- Fridge/freezer and microwave
- Pre-galvanised chassis
- TV points in the twin bedrooms
- Stowaway occasional bed in twin room
- Lounge Scatter Cushions
- Bedroom Throws and Co-ordinating Scatter Cushions
- Duvet Sets
- Avon Lodge available in Grain Effect Plastic, Canexel, Stucco & Vinylit Cladding
- Lift up storage bed
- All electric version including central heating
- Platinum upgrade

For further details see standard features checklist on pages 80-82.



# Regent

The Regent boasts a rare concept in a 12 ft home and that is the ability to close off the lounge from the kitchen and dining area. Pocket doors are smartly encased behind the lounge shelving unit which provides lots of space for books and photos. The large sofa contrasts well with the luxurious accent chair – one in the 36ft and two in the 38ft home – and the fabrics invoke an atmosphere of calm and serenity.



Image shows 38x12 2 bed



Pemberton Regent 38 x 12 2 bed closed option shown with standard Seafoam Aluminium Cladding & Anthracite Windows & optional front French Doors



An L shaped kitchen allows for vast counter space, perfect for preparing meals or baking. The bedrooms are sleek and uncluttered with functional furniture such as floating bedside tables and a dressing table with room for storage baskets on the shelving unit in the 38ft model. Both Regent models have en-suite toilets and the shower rooms are well appointed with smart fixtures and fittings.

Image shows 38x12 2 bed



### Highlights

- Wall mounted flame effect fire
- Large sofa bed with two accent chairs (38ft only)
- Family shower room
- Accent walls
- Integrated cooker with separate oven and grill
- DVD unit
- Built in bookcase & storage unit to lounge
- Contrast high backed dining chairs
- En-suite toilet and sink to master bedrooms
- Walk-in wardrobe (36ft only)

36ft x 12ft

2 bedroom

38ft x 12ft

2 bedroom

# Regent

## Residential Specification

Option includes the following:

- Roof 250mm insulated
- 125mm thick wall
- Floor minimum 120mm insulated
- Windows low E glass and Argon filled
- Superior Insulation U values exceeding the British Standard

### Key

- |   |   |
|---|---|
|  |  |
|  |  |
|  |  |
|  |  |
|  |  |
|  |  |
|  |  |

36ft x 12ft - 2 bedroom

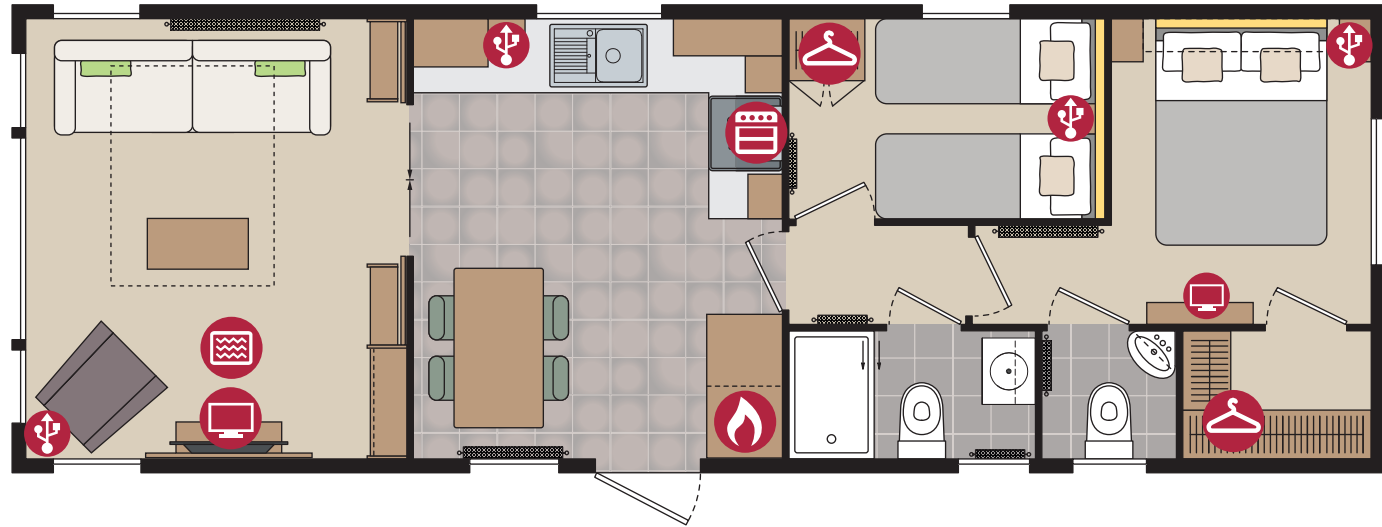

38ft x 12ft - 2 bedroom

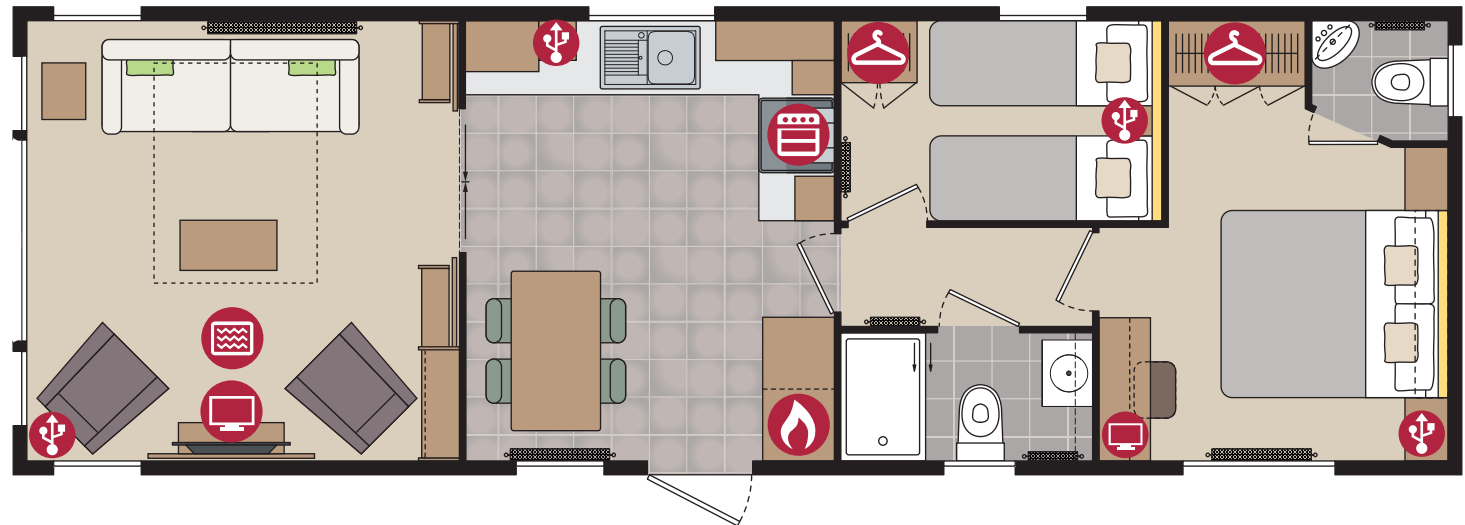

 **3D Walkthroughs**  
available to view online  
[www.pembertonlh.co.uk](http://www.pembertonlh.co.uk)



Image shows 38x12 2 bed



Image shows 38x12 2 bed



Image shows 38x12 2 bed



Image shows 38x12 2 bed

### Options available to order

- Residential Specification to BS3632 available in all cladding types
- Gas combi central heating system with thermostatic radiator valves
- PVCu double glazing
- French doors to front elevation
- Integrated dishwasher, washer/dryer and fridge/freezer
- Microwave
- Pocket doors separating lounge and kitchen
- Pre-galvanised steel chassis
- TV points in the twin bedroom
- Stowaway occasional bed in twin room
- Lounge Scatter Cushions
- Bedroom Throws and Co-ordinating Scatter Cushions
- Duvet Sets
- Regent Lodge available in Grain Effect Plastic, Canexel, Stucco & Vinylit Cladding
- Lift up storage bed
- All electric version including

For further details see standard features checklist on pages 80-82.



# Marlow

The Marlow has an abundance of model sizes developed in response to popular demand. Each model is open plan with a central dining space where there's the option for a practical and comfortable bench. The feature lounge panelling beautifully enhances the integrated fire, whilst plum accent fabrics give a modern twist to the pale wood finishes throughout.



Image shows 40x13 2 bed



Pemberton Marlow 40 x 13 2 bed shown with standard Seafoam Aluminium Cladding & optional Anthracite Windows & Doors



Kitchen highlights include generous storage and countertops, and an integrated microwave. Carefully considered lighting details ensure that the kitchen is perfectly illuminated when creating culinary delights, or a source of ambient background light for the lounge in the darker hours. Sumptuous velvet headboards add to the luxury of the bedrooms where well designed storage solutions abound in the furniture and lift-up bed options.

Image shows 40x13 2 bed



## Highlights

- Open plan living area
- Feature lounge paneling to chimney breast and sideboard areas
- Integrated flame effect fire with remote control
- Freestanding dining table with built in bench seating and/or dining chairs.
- Freestanding sofas (one with sofa bed)
- Freestanding TV cabinet with pull down storage area
- En-suite with shower to 13ft and 14ft models
- Generous dressing table to some models
- Spacious robe hanging area to all master bedrooms

36ft x 12ft	1 & 2 bedroom
38ft x 12ft	2 bedroom
40ft x 13ft	2 & 3 bedroom
42ft x 14ft	2 bedroom

# Marlow

## Residential Specification

Option includes the following:

- Roof 250mm insulated
- 125mm thick wall
- Floor minimum 120mm insulated
- Windows low E glass and Argon filled
- Superior Insulation U values exceeding the British Standard

### Key

36ft x 12ft - 1 bedroom

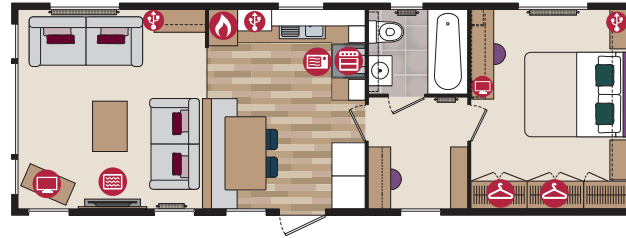

36ft x 12ft - 2 bedroom

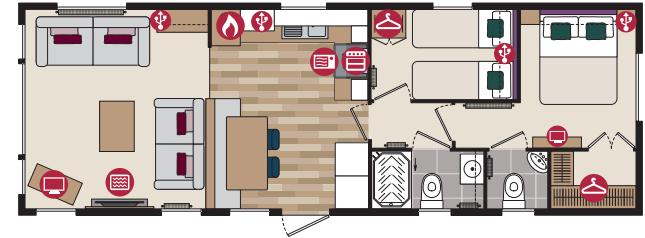

38ft x 12ft - 2 bedroom

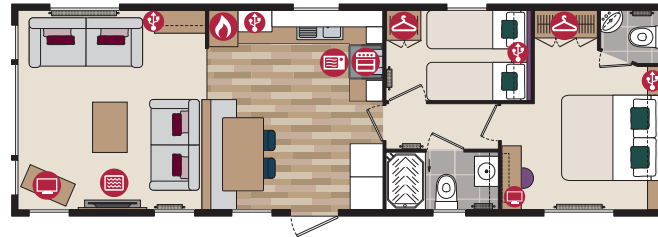

40ft x 13ft - 2 bedroom

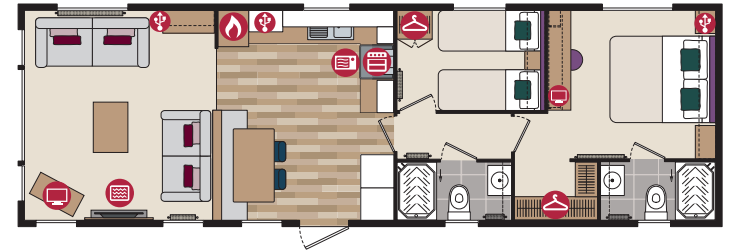

40ft x 13ft - 3 bedroom

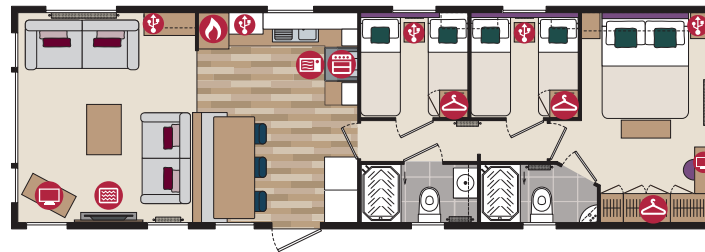

42ft x 14ft - 2 bedroom

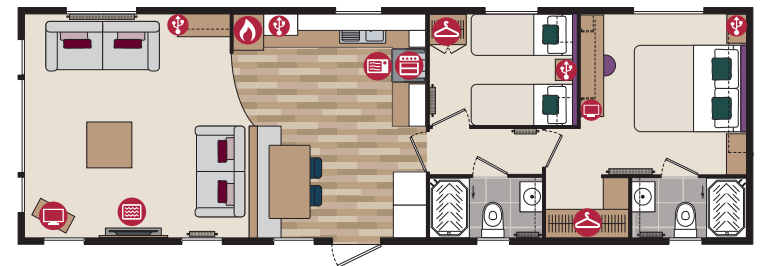



Image shows 40x13 2 bed



Image shows 40x13 2 bed



Image shows 40x13 2 bed



Image shows 40x13 2 bed

### Options available to order

- Residential Specification to BS3632 available in all cladding types
- PVCu double glazing
- French doors to front or elevation
- Gas combi central heating system with thermostatic radiator valves
- Pre-galvanised steel chassis
- Integrated dishwasher and washer dryer
- Integrated fridge freezer
- TV points in the twin bedrooms
- Lounge curtains instead of venetians
- Stowaway occasional bed in twin room
- Lounge Scatter Cushions
- Bedroom Throws and Co-ordinating Scatter Cushions
- Duvet Sets
- Marlow Lodge available in Grain Effect Plastic, Canexel, Stucco & Vinylit Cladding
- Lift up storage bed
- All electric version including central heating
- Platinum upgrade

For further details see standard features checklist on pages 80-82.

# Marlow Centre Lounge

Light streams in beautifully thanks to the generous windows of the brand-new Marlow Centre Lounge. Savour the airy atmosphere created by the mono pitch ceiling and effortlessly flowing open spaces. Comfort blends with practicality allowing for a perfect backdrop for entertaining whilst cooking.



Image shows 40x13 2 bed



Pemberton Marlow 40 x 13 2 bed shown with optional Vinylit Cladding & optional Anthracite Windows & Doors



Lush plum coloured fabrics work fabulously to accentuate the warm creams and pale wood finishes, resulting in spaces perfectly balanced to lose yourself and re-charge. Generous seating invites you to relax and take in the views or entertain in style against the backdrop of the feature built-in fireplace.

### Highlights

- Open plan living area
- Feature integrated fireplace and built in DVD unit
- Integrated microwave
- Freestanding dining table with faux leather dining chairs
- Accent chair and matching footstool (standard in 40ft model)
- L shaped sofa incorporating a sofa bed
- En-suite to master bedroom (bath included in 40ft model)
- Walk-in robe in 40ft model
- Dressing table to master bedroom
- Sleek kitchen worktops and complementary mirrored backsplash
- Integrated flame effect fire with remote control
- Mono pitch roof

Image shows 40x13 2 bed



38ft x 12ft

2 bedroom

40ft x 13ft

2 bedroom

# Marlow Centre Lounge

## Residential Specification

Option includes the following:

- Roof 250mm insulated
- 125mm thick wall
- Floor minimum 120mm insulated
- Windows low E glass and Argon filled
- Superior Insulation U values exceeding the British Standard

### Key



 **3D Walkthroughs**  
available to view online  
[www.pembertonlh.co.uk](http://www.pembertonlh.co.uk)

38ft x 12ft - 2 bedroom (Centre Lounge)

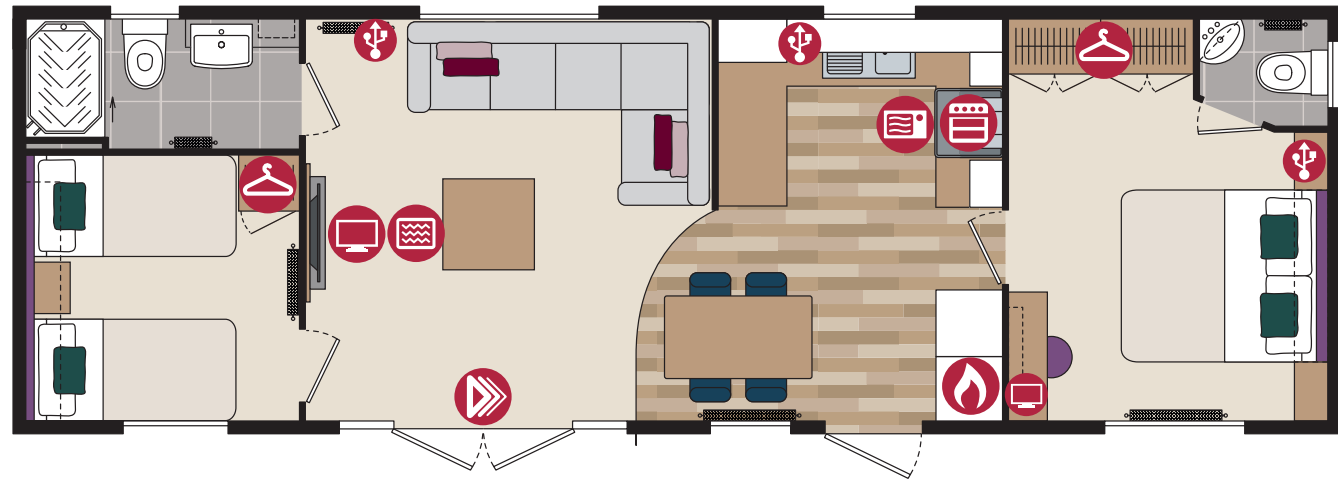

40ft x 13ft - 2 bedroom (Centre Lounge)

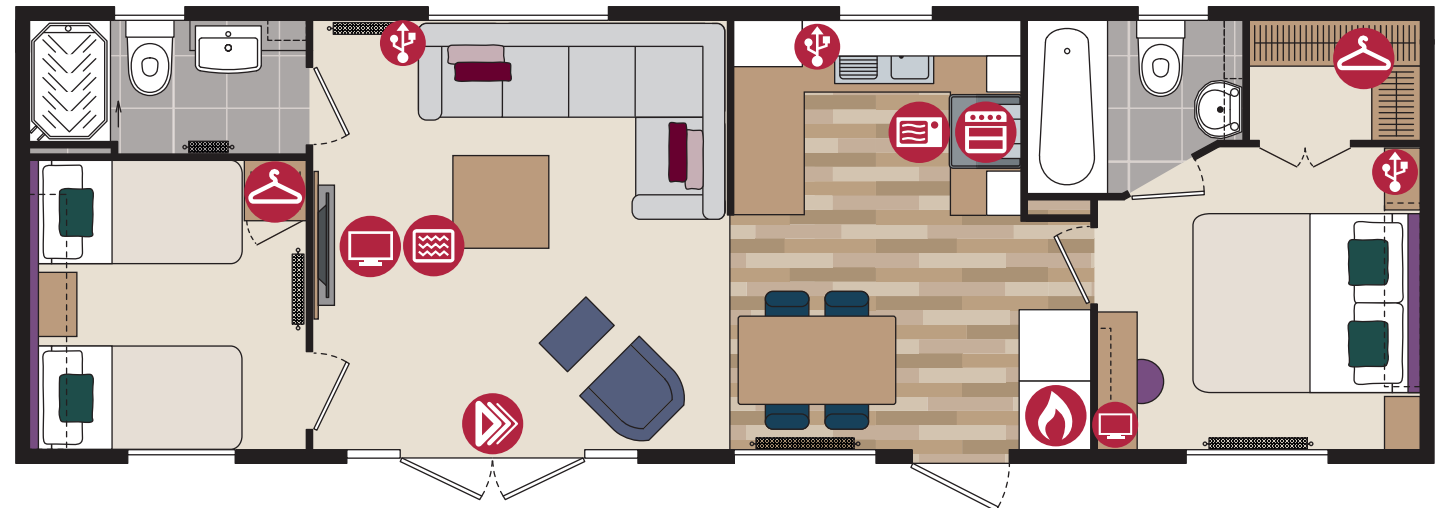



Image shows 40x13 2 bed



Image shows 40x13 2 bed



Image shows 40x13 2 bed



Image shows 40x13 2 bed

### Options available to order

- Residential Specification to BS3632 available in all cladding types
- PVCu double glazing
- Gas combi central heating system with thermostatic radiator valves
- Pre-galvanised steel chassis
- Integrated dishwasher and washer dryer
- Integrated fridge freezer
- TV point in the master bedrooms
- Lounge curtains instead of venetians
- Stowaway occasional bed in twin room
- Lounge Scatter Cushions
- Bedroom Throws and Co-ordinating Scatter Cushions
- Duvet Sets
- Marlow Lodge available in Grain Effect Plastic, Canexel, Stucco & Vinylit Cladding
- Lift up storage bed
- All electric version including central heating
- Platinum upgrade
- Accent Chair option in 38ft
- Bath can be shower in 40ft

For further details see standard features checklist on pages 80-82.



**Pemberton**  
PARK & LEISURE HOMES

# Abingdon

Serene blue and cream lounge furnishings sit beautifully against stone and oak coloured fitted furniture. Traditional styling works in harmony with the feature electric fireplace, and carefully designed wall shelves. This range in particular lends itself to a lodge upgrade in one of the many striking Canaxel colours. Available in two sizes - 38ft x 12 ft & 42ft x 13ft - the Abingdon feels spacious and well appointed.



Image shows 42x13 2 bed



Pemberton Abingdon 42 x 13 2 bed closed option shown with optional CanExel Cladding & Anthracite Windows & Doors



Select the optional pocket doors for a closed off lounge if you prefer a more cosy setting or to create more privacy when using the sofa bed in the lounge. The master bedroom features a plank effect feature wall with ornate wall lights in a blend of rustic meets luxury and wardrobes incorporate a smart dressing table with an upholstered cylinder stool.

Image shows 42x13 2 bed



### Highlights

- PVCu double glazing with French doors to front elevation
- Integrated microwave and fridge/freezer
- Gas combi central heating system with thermostatic radiator valves
- Modern electric fire
- Large sofa bed with accent chair(s) and a contrasting footstool
- Lounge cushions
- 5ft bed in master bedroom
- En-suite facilities in 42ft 2 bed or 38ft En-suite option
- Integrated cooker with separate oven and grill

38ft x 12ft

2 bedroom

42ft x 13ft

2 bedroom

# Abingdon

## Residential Specification

Option includes the following:

- Roof 250mm insulated
- 125mm thick wall
- Floor minimum 120mm insulated
- Windows low E glass and Argon filled
- Superior Insulation U values exceeding the British Standard

### Key

 Cooker	 USB Point
 Hob	 TV Space
 Fridge-Freezer	 Electric Fire
 Microwave	 Patio Doors
 Washer/Dryer	 French Doors
 Dishwasher	 Bifold Doors
 Boiler	 Wardrobe

38ft x 12ft - 2 bedroom (Std)

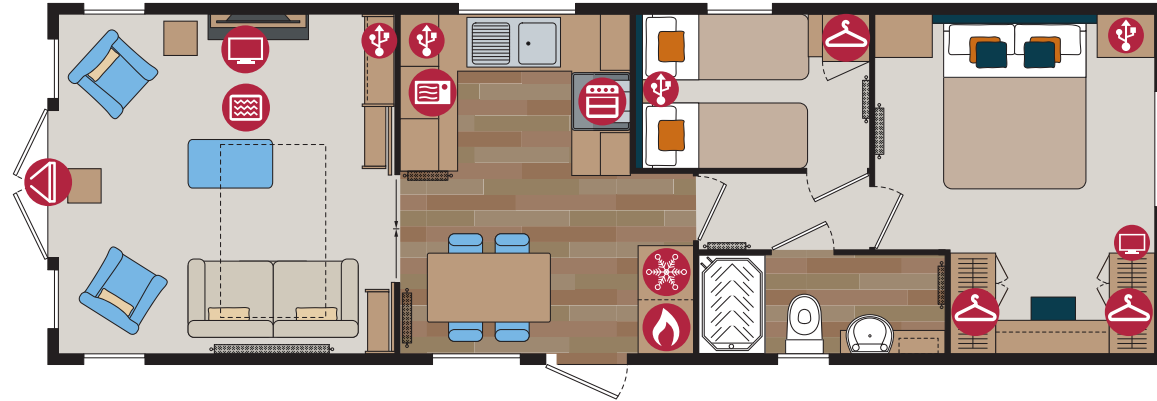

38ft x 12ft - 2 bedroom (En-suite)

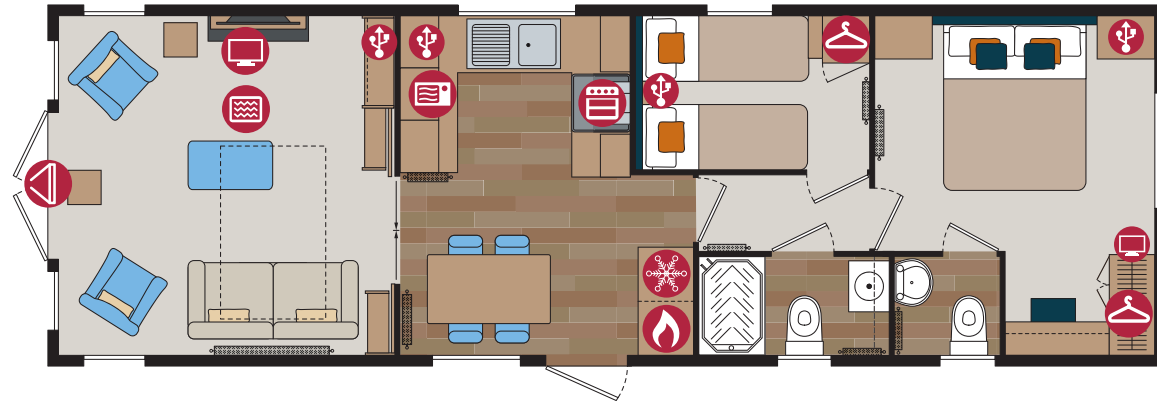

42ft x 13ft - 2 bedroom

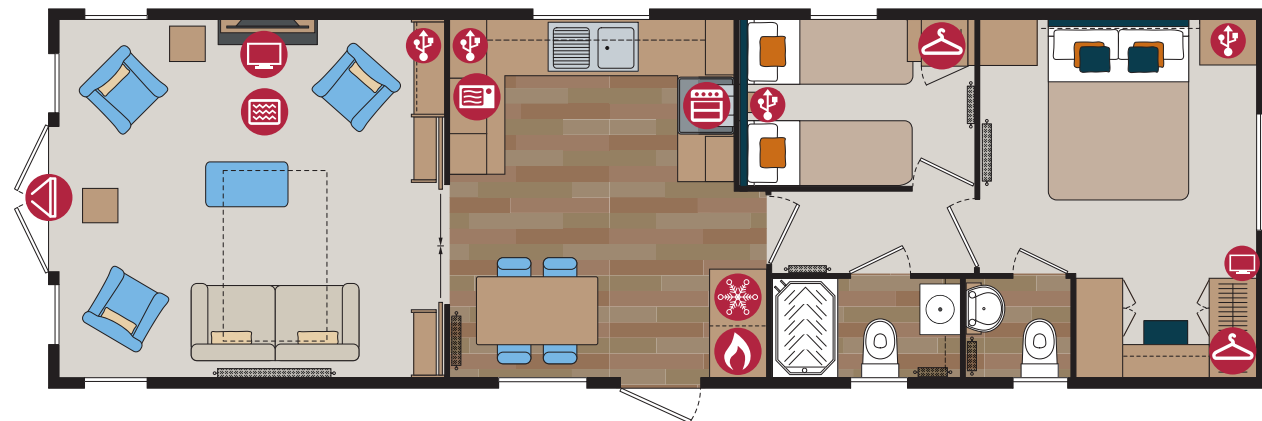



Image shows 42x13 2 bed



Image shows 42x13 2 bed



Image shows 42x13 2 bed



Image shows 42x13 2 bed

### Options available to order

- Residential Specification to BS3632 available in all cladding types
- Integrated dishwasher and washer/dryer
- Pocket doors separating lounge and kitchen
- TV points in the twin bedrooms
- Stowaway occasional bed in twin room
- Bedroom Throws and Co-ordinating Scatter Cushions
- Duvet Sets
- Abingdon Lodge available in Grain Effect Plastic, Canexel, Stucco & Vinylit Cladding
- Lift up storage bed
- All electric version including central heating
- Platinum upgrade

For further details see standard features checklist on pages 80-82.

# Rivington

Sit back and admire the beauty of nature through the expansive front patio doors whilst enjoying a spot of cooking in the open plan kitchen or a good conversation at the breakfast bar. The modern sleek kitchen with a mirrored kitchen backsplash is a perfect backdrop to the lounge which includes an L shaped sofa bed and matching storage footstool, and an accent chair (two in 14ft models). Graphite accents such as the wall mounted fire, dining chairs and bar stools work perfectly with copper coloured scatter cushions and rich emerald-coloured fabrics.



Image shows 42x14 2 bed



Pemberton Rivington 42 x 14 2 bed shown with standard Seafoam Aluminium & optional Anthracite Windows & Doors



Adjust the carefully considered lighting throughout to suit your mood. All models have walk-in wardrobes to the master bedrooms which are perfect for storing larger items and the dressing tables feature storage shelves that can accommodate storage boxes. Both the 2 bedroom models have the option to change the en-suite bath to a shower if required.

Image shows 42x14 2 bed



### Highlights

- PVCu double glazing with large patio door to front elevation
- Integrated microwave and fridge/freezer
- Breakfast bar with 2 bar stools
- Contemporary wall mounted fire
- 5ft bed in master bedroom
- Walk in wardrobe with LED lighting to master bedroom (2 bed)
- Family shower room with storage cabinets
- En-suite with domestic sized bath (2 bed models only)
- Gas combi central heating system with thermostatic radiator valves
- Lounge cushions
- L shaped sofa bed, co-ordinating accent chair and footstool (2 accent chairs in the 42ft 2bed)
- TV points in all bedrooms
- Integrated cooker with separate oven and grill
- Kitchen Plinth Ambient lighting

40ft x 12ft	2 bedroom
42ft x 13ft	3 bedroom
42ft x 14ft	2 bedroom

# Rivington

## Residential Specification

Option includes the following:

- Roof 250mm insulated
- 125mm thick wall
- Floor minimum 120mm insulated
- Windows low E glass and Argon filled
- Superior Insulation U values exceeding the British Standard

### Key

40ft x 12ft - 2 bedroom

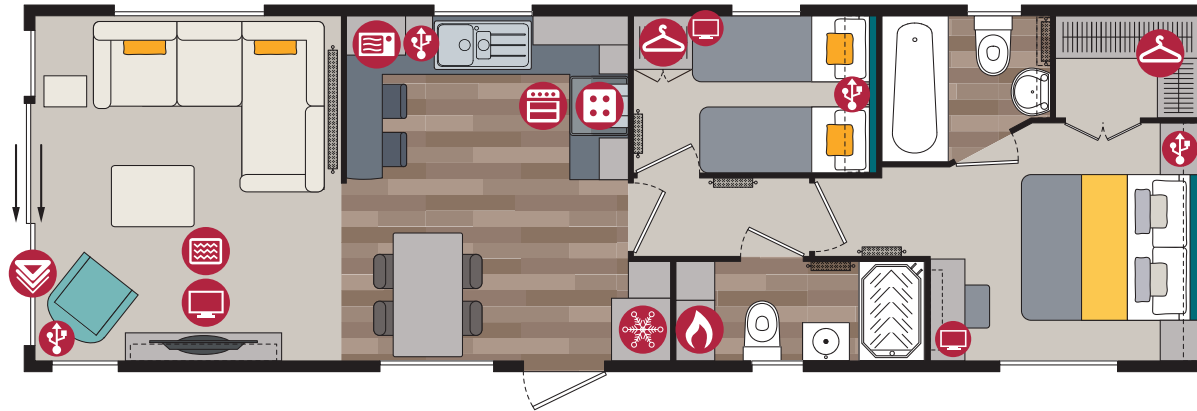

42ft x 13ft - 3 bedroom

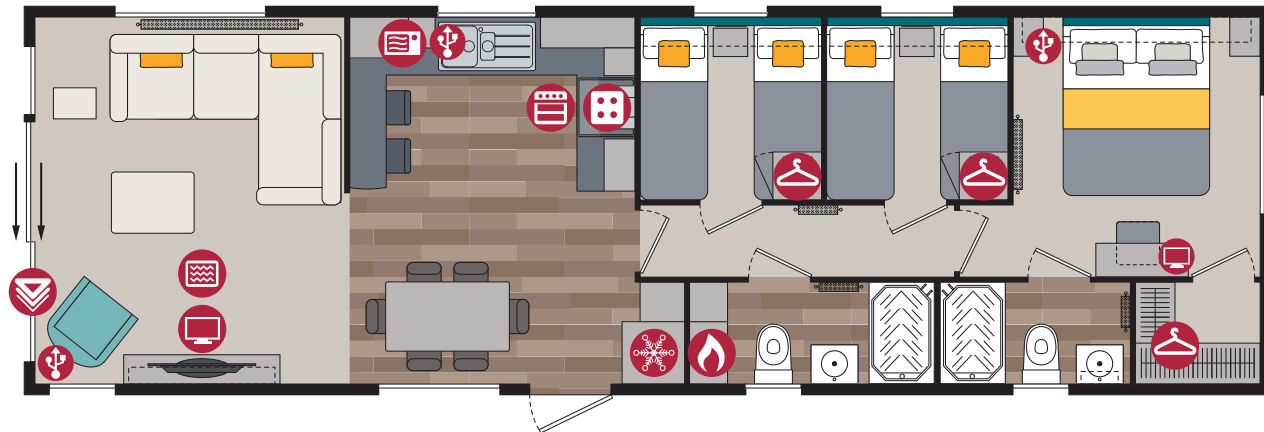

42ft x 14ft - 2 bedroom

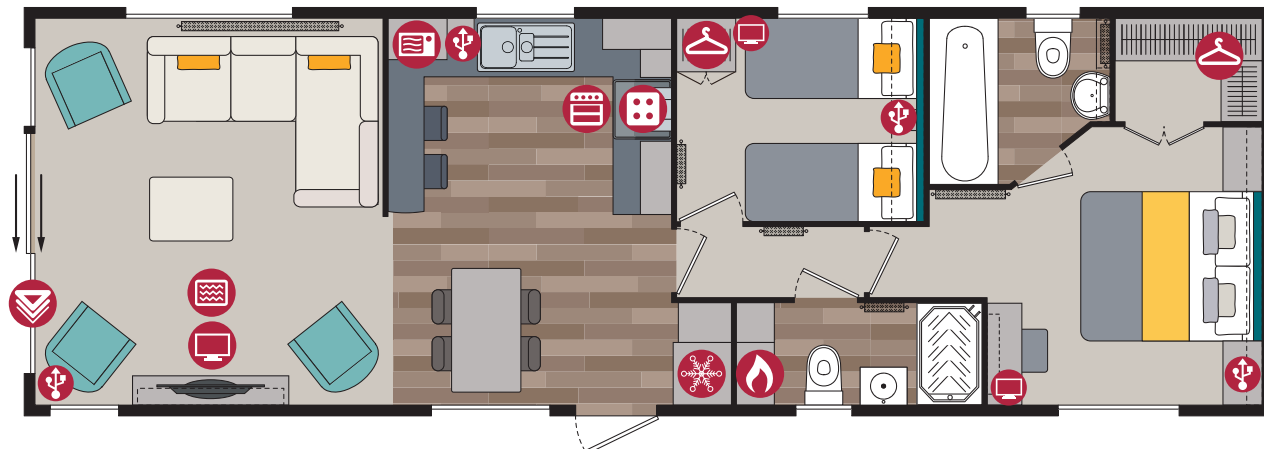

 **3D Walkthroughs**  
available to view online  
[www.pembertonlh.co.uk](http://www.pembertonlh.co.uk)



### Options available to order

- Residential Specification to BS3632 available in all cladding types
- Integrated dishwasher and washer/dryer
- Shower in lieu of bath
- Stowaway occasional bed in twin room
- Bedroom Throws and Co-ordinating Scatter Cushions
- Duvet Sets
- Rivington Lodge available in Grain Effect Plastic, Canexel, Stucco & Vinylit Cladding
- Lift up storage bed
- All electric version including central heating
- Platinum upgrade

For further details see standard features checklist on pages 80-82.

# Langton

A high 8 foot ceiling brings an abundance of light into this closed off home coupled with the dormer window over the dining area. Grey accent walls provide contrast to the oak colours throughout and tan and russet shades lift the mood adding warmth. The entrance vestibule has a louvre partition which screens off the dining area and provides a more intimate feel. With a kitchen island included the worktop space is increased together with extra storage.



Image shows 43x14 2 bed



Pemberton Langton 43 x 14 2 bed shown in standard Light Grey Woodgrain Cladding with standard White Windows & Doors



A wine cooler is the perfect optional extra to complete an already comprehensive standard kitchen specification of an integrated washer/dryer, fridge/freezer, dishwasher and microwave. This model has 3ft beds to the twin bedroom which can be swapped for a 5 ft bed if required. Plush headboards add a pop of colour to the bedrooms and the lighting throughout is beautiful and well thought-out.

Image shows 43x14 2 bed



## Highlights

- Entrance vestibule with storage
- PVCu double glazing with four panel patio door to front elevation
- Gas combi central heating system with thermostatic radiator valves
- TV points in all bedrooms
- Dormer window in the dining area and a skylight above the kitchen
- Integrated washer/dryer, fridge/freezer, dishwasher and microwave
- Traditional style flame effect fire
- Pocket doors between the lounge and kitchen
- Stylish lounge suite with a sofa, 2 armchairs and a footstool
- Bath in en-suite
- 5ft divan in the master bedroom with 3ft divans in the twin room
- Vaulted ceiling throughout with a minimum ceiling height of 2.4m (8ft)
- External socket
- Woodgrain Light Grey aluminium
- Wireless thermostat
- Lounge Scatter Cushions
- Bedroom Throws and Co-ordinating Scatter Cushions
- Duvet Sets
- Integrated cooker with separate oven and grill
- Kitchen Plinth Ambient lighting

43ft x 14ft

2 bedroom



Image shows 43x14 2 bed



Image shows 43x14 2 bed



Image shows 43x14 2 bed



Image shows 43x14 2 bed



# Langton

## Residential Specification

Option includes the following:

- Roof 250mm insulated
- 125mm thick wall
- Floor minimum 120mm insulated
- Windows low E glass and Argon filled
- Superior Insulation U values exceeding the British Standard

### Key

43ft x 14ft - 2 bedroom

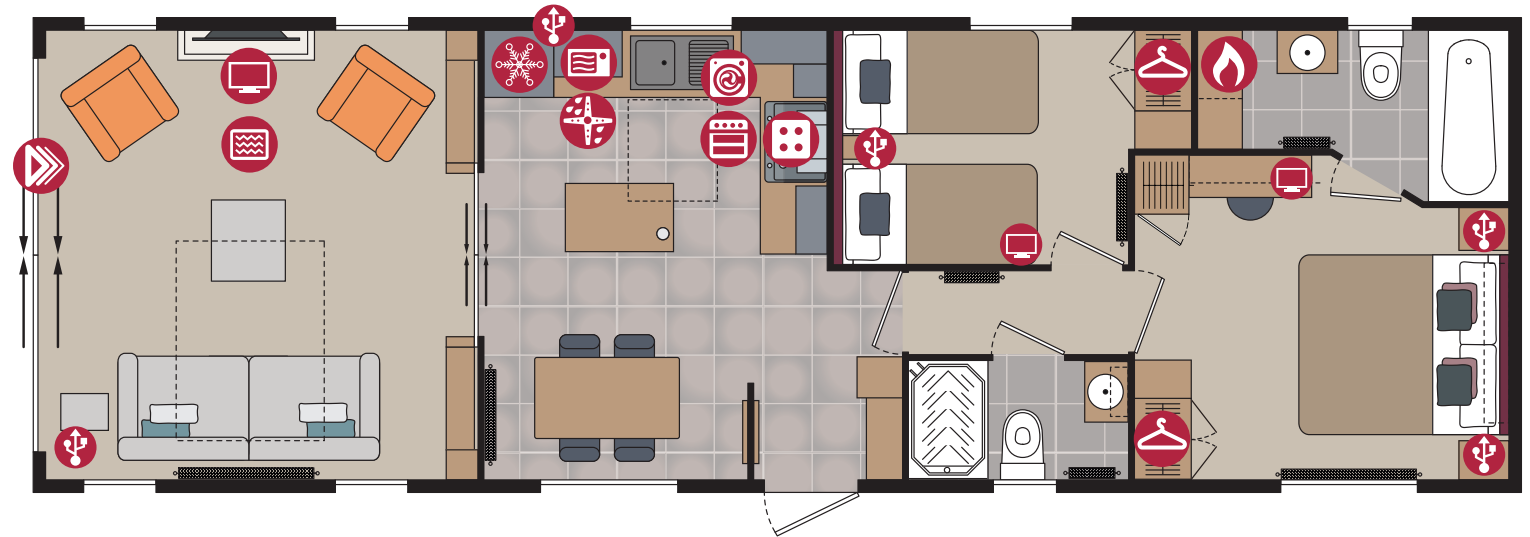



Image shows 43x14 2 bed



Image shows 43x14 2 bed



Image shows 43x14 2 bed



Image shows 43x14 2 bed

### Options available to order

- Residential Specification to BS3632 available in all cladding types
- Wine cooler
- Lounge curtains instead of roman blinds
- Shower in lieu of bath
- Stowaway occasional bed in twin room
- Langton Lodge available in Grain Effect Plastic, Canoxel, Stucco & Vinylit Cladding
- Lift up storage bed
- All electric version including central heating
- Platinum upgrade

For further details see standard features checklist on pages 80-82.



**Pemberton**  
PARK & LEISURE HOMES

# Park Lane

Both the 43ft x 14ft 2 and 3 bedroom models in the Park Lane range share the spacious kitchen and dining area but have quite different layouts to the back of the home. The kitchen scheme is inspired by three different mediums: graphite, marble and rustic wood. Great care has been taken over the lounge styling with statement accent chairs, a built in fireplace, a drinks table and footstool incorporating a matching table.

Image shows 43x14 2 bed



Pemberton Park Lane 43 x 14 2 bed shown in optional Canaxel Cladding with optional Anthracite Windows & Doors



A refresh to the 2 bedroom layout now offers a generous dressing table with neat storage compartments to showcase your cherished items, and a wall of mirrored robes maximises every inch of space. Whilst the Park Lane is clad in a smart contemporary woodgrain aluminium it is also available in a range of other claddings and window and door colours to personalise your home.

Image shows 43x14 2 bed



## Highlights

- PVCu double glazing with four panel patio door
- Large U shaped kitchen with glass splashback and skylight
- Breakfast bar with 2 bar stools
- High level cooker with separate oven and grill
- Integrated washer/dryer, fridge/freezer, dishwasher and microwave
- State of the art flame effect fire with co-ordinating DVD unit
- Contemporary sofabed with 2 accent armchairs and a footstool/coffee table
- 5ft wide divan in master bedroom with 3ft divans in the twin room (2 bedroom only)
- Domestic sized bath with aqua board surround
- Vaulted ceiling throughout with a minimum ceiling height of 2.4m (8ft)
- External socket
- Gas combi central heating system with thermostatic radiator valves
- TV points in all bedrooms
- Woodgrain Light Grey aluminium
- Wireless thermostat
- Plank effect dining table with faux leather chairs
- Lounge drinks table
- Lounge Scatter Cushions
- Bedroom Throws and Co-ordinating Scatter Cushions
- Duvet Sets
- Kitchen Plinth Ambient lighting

43ft x 14ft

2 & 3 bedroom



Image shows 43x14 2 bed



Image shows 43x14 2 bed



Image shows 43x14 2 bed



Image shows 43x14 2 bed



# Park Lane

## Residential Specification

Option includes the following:

- Roof 250mm insulated
- 125mm thick wall
- Floor minimum 120mm insulated
- Windows low E glass and Argon filled
- Superior Insulation U values exceeding the British Standard

### Key

- |   |                |   |               |
|---|----------------|---|---------------|
|  | Cooker         |  | USB Point     |
|  | Hob            |  | TV Space      |
|  | Fridge-Freezer |  | Electric Fire |
|  | Microwave      |  | Patio Doors   |
|  | Washer/Dryer   |  | French Doors  |
|  | Dishwasher     |  | Bifold Doors  |
|  | Boiler         |  | Wardrobe      |



 **3D Walkthroughs**  
available to view online  
[www.pembertonlh.co.uk](http://www.pembertonlh.co.uk)

43ft x 14ft - 2 bedroom

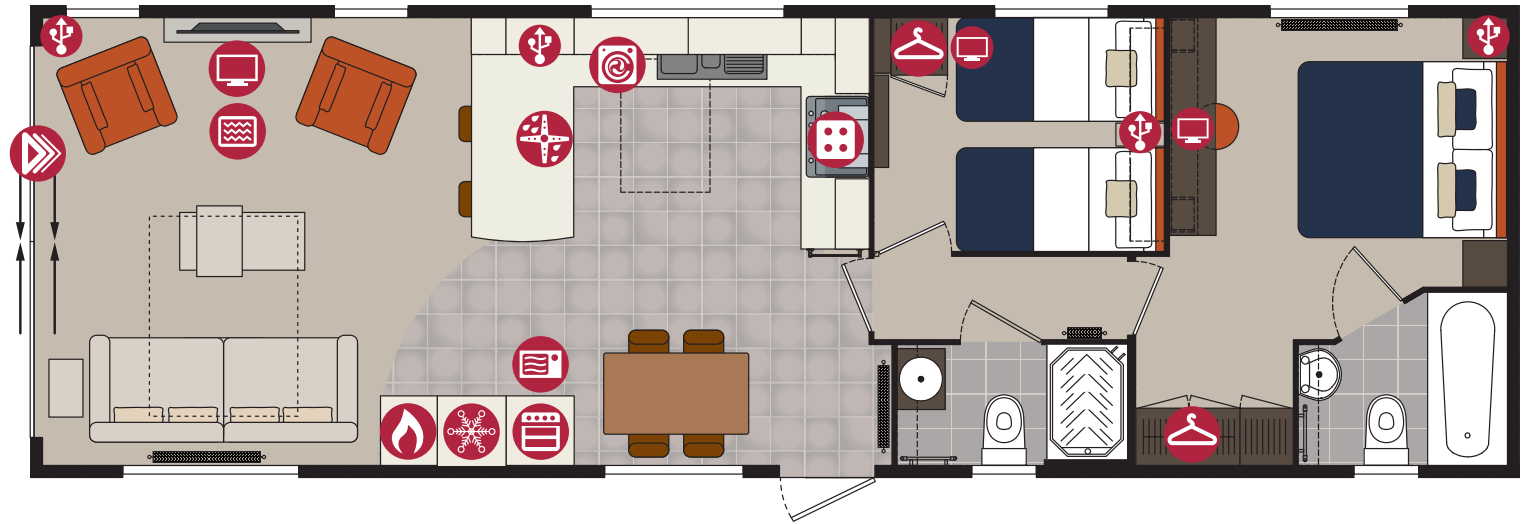

43ft x 14ft - 3 bedroom

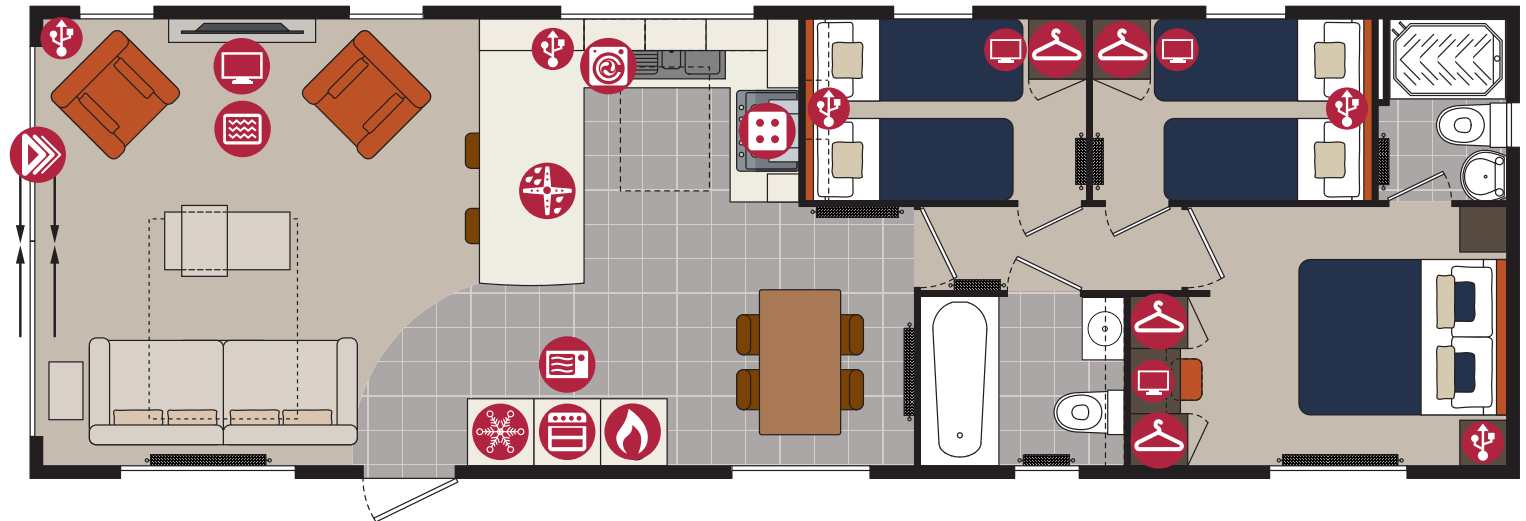



Image shows 43x14 2 bed



Image shows 43x14 2 bed



Image shows 43x14 2 bed



Image shows 43x14 2 bed

### Options available to order

- Residential Specification to BS3632 available in all cladding types
- Wine cooler
- Shower in lieu of bath
- Stowaway occasional bed in twin room (3 bed only)
- Park Lane Lodge available in Grain Effect Plastic, Canaxel, Stucco & Vinylit Cladding
- Lift up storage bed
- All electric version including central heating
- Platinum upgrade

For further details see standard features checklist on pages 80-82.



# Knightsbridge

Stepping into the Knightsbridge through the wide sliding patio doors you are met with a fusion of sharp contemporary styling and refined rustic features. High ceilings, beams and a dormer window to the side entrance provide drama and the statement dark blue kitchen is luxurious and modern with contrast marble effect counter tops.



Image shows 43x14 2 bed



Pemberton Knightsbridge 42 x 14 2 bed shown in optional Canaxel Cladding with optional Anthracite Windows & optional Bifold Door



The sumptuous sofa provides a separation between the dining area and lounge, however the flow of natural daylight fills the entire scene through the dormer and skylight windows. There's also the option to further augment this airiness by choosing the side bifolding door. Pampering is a pleasure thanks to the thoughtfully designed vanity area which has an elegant backdrop of a feature panelled wall. A variety of beautiful lighting options throughout allows each room to have the perfect ambiance.

Image shows 43x14 2 bed



### Highlights

- PVCu double glazing with four panel patio door to front elevation
- Gas combi heating system with thermostatic radiator valves
- TV points in both bedrooms
- Dormer window over the side entrance and a skylight above the kitchen
- Integrated washer/dryer, dishwasher and microwave
- American style fridge freezer
- Traditional style flame effect fire
- Stylish lounge suite with a sofa bed, 2 armchairs and a storage footstool
- Sideboard
- Bath in en-suite
- 5ft divan in the master bedroom with 3ft divans in the twin room
- Spacious dressing table
- Vaulted ceiling throughout with a minimum ceiling height of 2.4m (8ft)
- External socket
- Woodgrain Chateaux aluminium
- Wireless thermostat
- Lounge Scatter Cushions
- Bedroom Throws and Co-ordinating Scatter Cushions
- Duvet Sets
- High level cooker with separate oven and grill
- Kitchen Plinth Ambient lighting

43ft x 14ft

2 bedroom



Image shows 43x14 2 bed



Image shows 43x14 2 bed



Image shows 43x14 2 bed



Image shows 43x14 2 bed



# Knightsbridge

## Residential Specification

Option includes the following:

- Roof 250mm insulated
- 125mm thick wall
- Floor minimum 120mm insulated
- Windows low E glass and Argon filled
- Superior Insulation U values exceeding the British Standard

### Key

43ft x 14ft - 2 bedroom

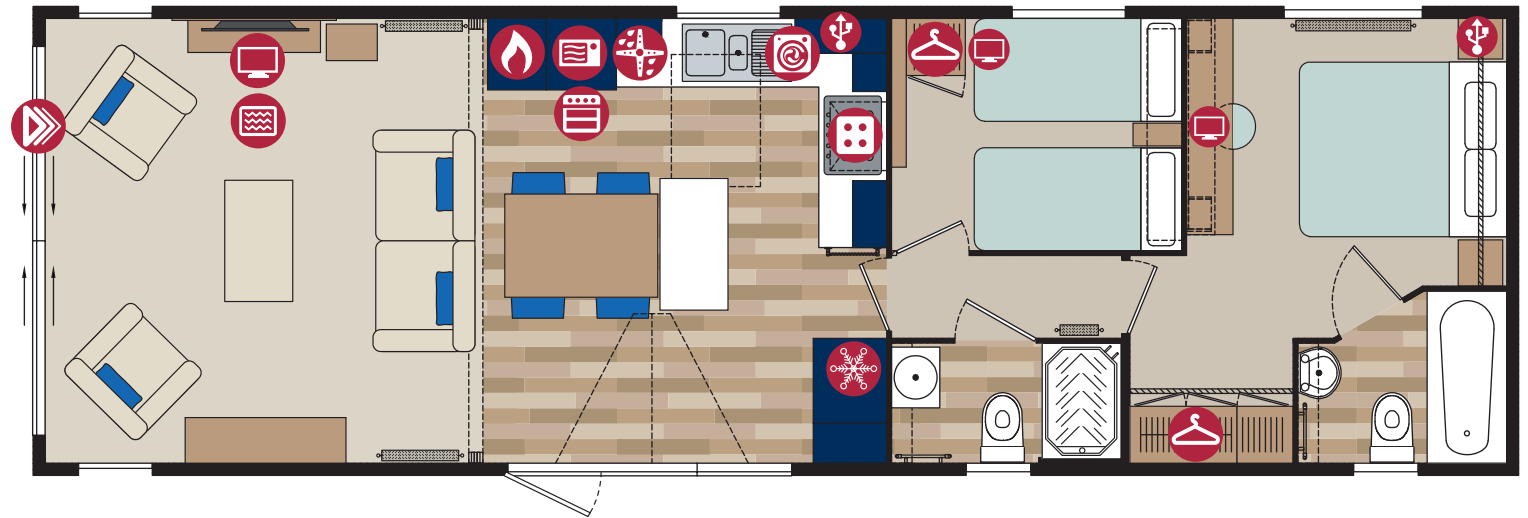

Image shows 43x14 2 bed



Image shows 43x14 2 bed



Image shows 43x14 2 bed



Image shows 43x14 2 bed



### Options available to order

- Residential Specification to BS3632 available in all cladding types
- Wine cooler
- Lounge curtains instead of venetian blinds
- Shower in lieu of bath
- Side bifold door
- Knightsbridge Lodge available in Grain Effect Plastic, Canexel, Stucco & Vinylit Cladding
- Lift up storage bed
- All electric version including central heating
- Platinum upgrade

For further details see standard features checklist on pages 80-82.



**Pemberton**  
PARK & LEISURE HOMES

# Arrondale Lodge

The Arrondale is quite distinctive thanks to its 16 foot dimension as it gives you the lodge feel for a more modest pitch size. No compromises have been made where this is concerned and you will find the same high specification as any other Pemberton lodge. A contemporary treatment has been given to the furniture and the furnishings using a combination of warm colours to harmonise with the opulent dark wood and metal accents.



Image shows 45x16 2 bed



Pemberton Arrondale 45 x 15 2 bed shown in optional CanExcel Cladding & standard White Windows & Doors



The well appointed kitchen creates a striking backdrop to the spacious lounge and boasts an array of adjustable lighting and bang up to date appliances. Clever storage solutions guarantee a place for everything, including the addition of a useful desk space to the 45ft model. There are two layouts available (42ft x 16ft and 45ft x 16ft) with 2 bedrooms however with the larger footprint there is the option to change the utility room to a single bedroom.

Image shows 45x16 2 bed



### Highlights

- PVCu double glazing with bifold doors to front elevation
- Self contained entrance hallway with integrated storage (45ft only)
- High level cooker with separate oven and grill
- Integrated washer/dryer, fridge/freezer, dishwasher and microwave
- Kitchen island with 2 bar stools
- Luxurious lounge sofa bed with co-ordinating armchairs and a footstool
- Recessed electric fire and DVD unit
- Full size bath with aqua board
- Large domestic shower in en-suite
- 5ft upholstered divan in the master bedroom with lift up flap for storage
- Vaulted ceiling throughout with a minimum ceiling height of 2.4m (8ft)
- Grain Effect Plastic Cladding
- External socket
- Gas combi central heating system with thermostatic radiator valves
- TV points in all bedrooms
- Feature metal base dining table
- Wireless thermostat
- Lounge Scatter Cushions
- Bedroom Throws and Co-ordinating Scatter Cushions
- Duvet Sets
- Kitchen Plinth Ambient lighting

42ft x 16ft

2 bedroom

45ft x 16ft

2 & 3 bedroom





Image shows 45x16 2 bed



Image shows 45x16 2 bed



Image shows 45x16 2 bed



Image shows 45x16 2 bed

# Arrondale Lodge

## Platinum Package Option includes the following:

- Aggregate Coated Steel Tile System with a 50 Year Weatherproof Warranty
- Wood effect Panelled Ceiling
- Wallpaper Finish
- Domestic Skirting and Door Casings
- Electric Combination Safe
- Hive Heating System
- Wine Cooler
- Bluetooth Speakers
- Outdoor Tap

## Residential Specification

### Option includes the following:

- Roof 250mm insulated
- 125mm thick wall
- Floor minimum 120mm insulated
- Windows low E glass and Argon filled
- Superior Insulation U values exceeding the British Standard

### Key

 Cooker	 USB Point
 Hob	 TV Space
 Fridge-Freezer	 Electric Fire
 Microwave	 Patio Doors
 Washer/Dryer	 French Doors
 Dishwasher	 Bifold Doors
 Boiler	 Wardrobe



42ft x 16ft - 2 bedroom

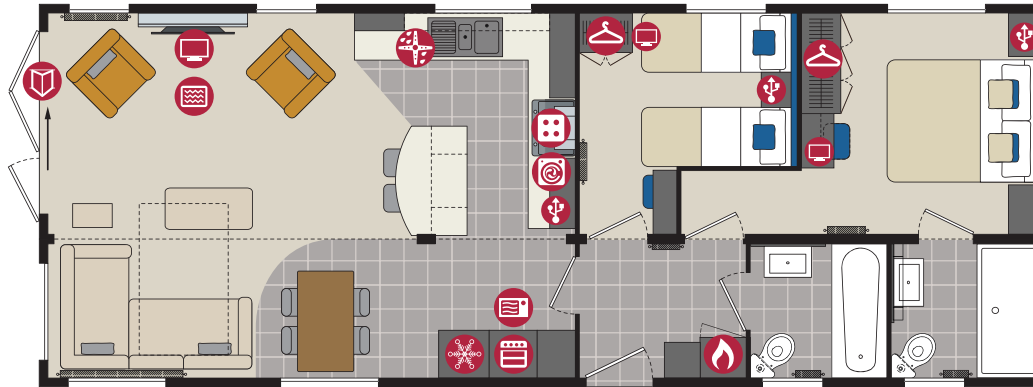

45ft x 16ft - 2 bedroom



45ft x 16ft - 3 bedroom

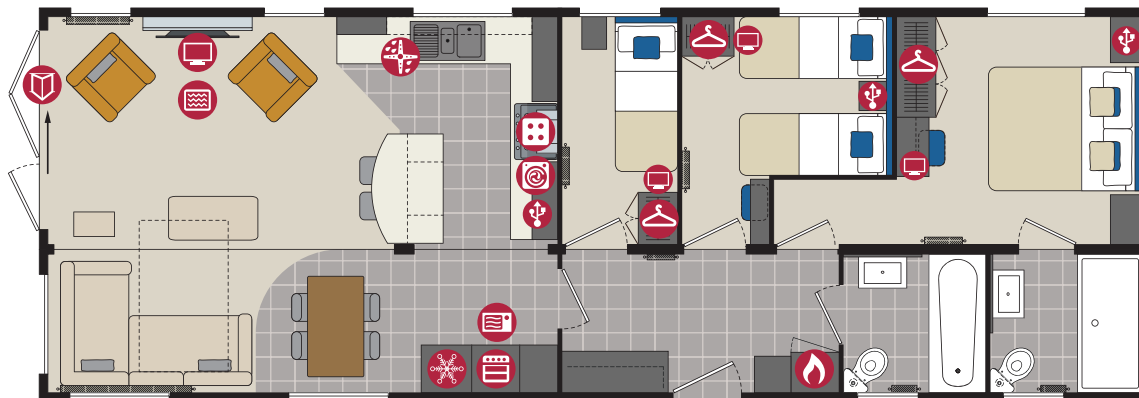



Image shows 45x16 2 bed



Image shows 45x16 2 bed



Image shows 45x16 2 bed



Image shows 45x16 2 bed

### Options available to order

- Residential Specification to BS3632 available in all cladding types
- Wine cooler
- Utility room or single bedroom (45ft only)
- Lounge curtains in lieu of roman blinds
- Shower in lieu of bath
- Stowaway occasional bed in twin room
- Platinum Package
- Arrondale Lodge available in Canexel, Stucco & Vinylit Cladding
- Lift up storage bed
- All electric version including central heating
- Platinum upgrade

For further details see standard features checklist on pages 80-82.



# Rivendale Lodge

The Rivendale is Pemberton's most established luxury lodge offering 6 different layouts ranging from 36 foot to 50 foot options. The stand out offset pitch makes for an interesting layout and provides a generous amount of space in the living areas, where it is most needed. To the side of the lounge area there is a Snug which can be used as an office, a supplementary bedroom (as it contains a sofabed) or purely a cosy 'den' for some quiet time away from it all.



Image shows 44x20 2 bed



Pemberton Arrondale 45 x 15 2 bed shown in optional CanExel Cladding & standard White Windows & Doors



Whilst the Rivendale suits its open plan kitchen, dining and living area there is an option to close off the lounge creating a more formal layout. The lounge and dining furniture is beautifully crafted and sets the tone with other highlights being the beams, the plank effect accents in the Snug, bathrooms and master bedroom and the crittall effect shower enclosures.

### Highlights

- PVCu double glazing with french doors to front elevation and Bifold door to side elevation
- Gas combi central heating system with thermostatic radiator valves
- TV points in all bedrooms
- Freestanding American style fridge freezer
- Integrated washer/dryer, dishwasher and microwave
- Kitchen island
- Recessed electric fire and DVD unit
- Luxurious lounge suite
- Sofabed and accent chair in the Snug
- 5ft upholstered divan in the master bedroom with lift up flap for storage
- Vaulted ceiling throughout with a minimum ceiling height of 2.4m (8ft)
- Grain Effect Plastic Cladding
- External socket
- Extendable dining table to seat 6 people
- Lounge Scatter Cushions
- Bedroom Throws and Co-ordinating Scatter Cushions
- Duvet Sets
- Wireless thermostat
- Integrated cooker with separate oven and grill
- Kitchen Plinth Ambient lighting

Image shows 44x20 2 bed



36ft x 20ft	2 bedroom
40ft x 20ft	2 & 3 bedroom
44ft x 20ft	2 & 3 bedroom
50ft x 20ft	2 bedroom





Image shows 44x20 2 bed



Image shows 44x20 2 bed



Image shows 44x20 2 bed



Image shows 44x20 2 bed

# Rivendale Lodge

## Platinum Package Option includes the following:

- Aggregate Coated Steel Tile System with a 50 Year Weatherproof Warranty
- Wood effect Panelled Ceiling
- Wallpaper Finish
- Domestic Skirting and Door Casings
- Electric Combination Safe
- Hive Heating System
- Wine Cooler
- Bluetooth Speakers
- Outdoor Tap

## Residential Specification

### Option includes the following:

- Roof 250mm insulated
- 125mm thick wall
- Floor minimum 120mm insulated
- Windows low E glass and Argon filled
- Superior Insulation U values exceeding the British Standard

### Key

- |   |  |
|---|--|
|  Cooker          |  USB Point      |
|  Hob             |  TV Space       |
|  Fridge-Freezer |  Electric Fire |
|  Microwave     |  Patio Doors  |
|  Washer/Dryer  |  French Doors |
|  Dishwasher    |  Bifold Doors |
|  Boiler        |  Wardrobe     |



36ft x 20ft - 2 bedroom

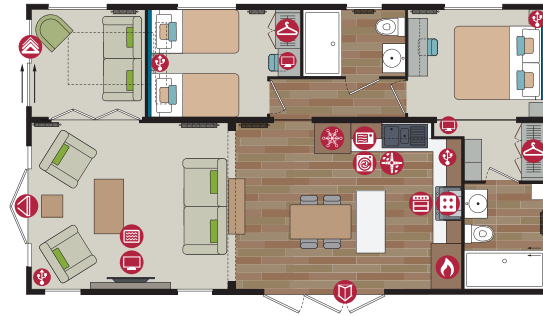

40ft x 20ft - 2 bedroom

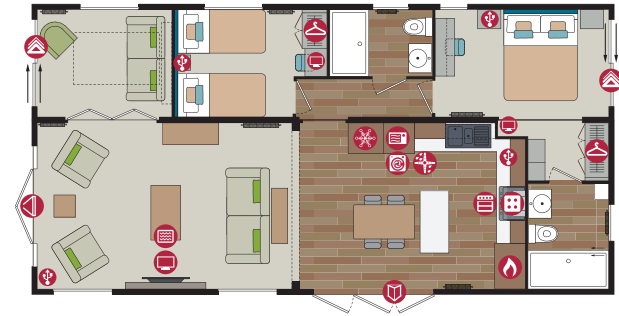

40ft x 20ft - 3 bedroom

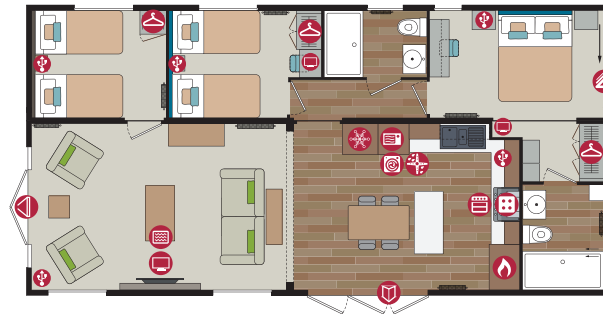

44ft x 20ft - 2 bedroom (Utility)

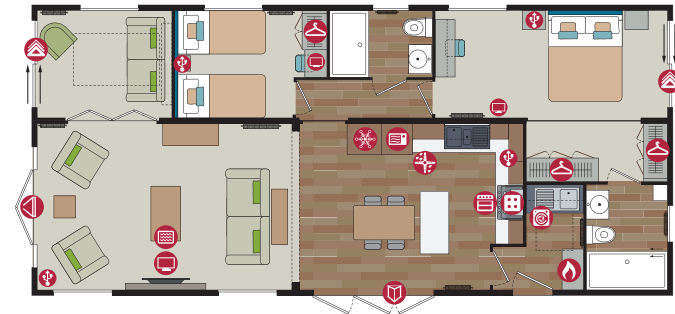

44ft x 20ft - 3 bedroom (Utility)

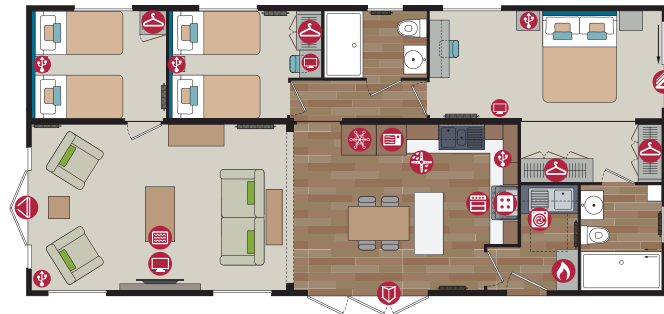

50ft x 20ft - 2 bedroom (Utility)

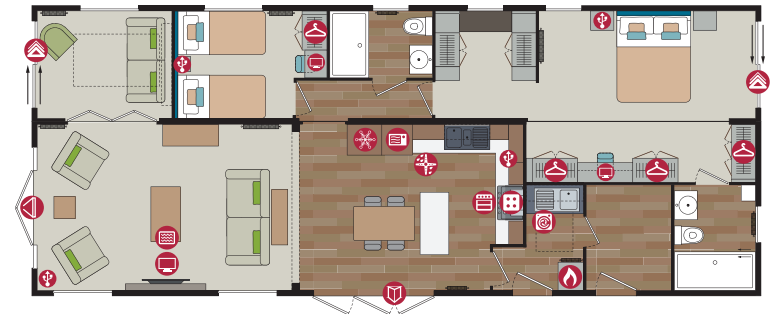



Image shows 44x20 2 bed



Image shows 44x20 2 bed



Image shows 44x20 2 bed



Image shows 44x20 2 bed

### Options available to order

- Residential Specification to BS3632 available in all cladding types
- Wine cooler
- Utility room
- Closed off lounge
- Lounge curtains in lieu of roman blinds
- Privacy curtains for the Snug
- Bath in lieu of shower (ensuite only)
- 3ft wide beds in twin room
- Patio door to lounge
- Skylight in Snug
- Windows in lieu of patio doors in the master bedroom and Snug
- Stowaway occasional bed in twin room
- Other sizes available - please enquire
- Platinum Package
- Rivendale Lodge available in Canoxel, Stucco & Vinylit Cladding
- Lift up storage bed
- All electric version including central heating

For further details see standard features checklist on pages 80-82.

# Glendale Lodge

Sophistication exudes from the luxurious materials and details of the Glendale. Contemporary styling mixes with classical craftsmanship to bring a truly special feel. Plush cream sofas sit perfectly amongst rich wood, antique brass, and natural textures.



Image shows 44x22 3 bed



Pemberton Glendale 44 x 22 3 bed Platinum shown in optional CanExel Cladding with optional Anthracite Windows & Doors



The elegant lounge blends seamlessly with the impressive backdrop of the well-equipped kitchen, packed with state-of-the-art equipment, an expansive island and perfectly matched bar stools. The main bathroom impressively boasts both a bath and separate shower cubicle. Carefully considered spaces and thoughtful storage throughout create a perfect haven of relaxation.

### Highlights

- PVCu double glazing with two sets of bi-fold doors to front elevation
- Gas combi central heating with thermostatic radiator valves
- TV points in all bedrooms
- Kitchen skylight
- Kitchen island with integrated sockets
- Dining table with feature pedestal, plush dining chairs and matching bar stools
- Integrated washer/dryer, dishwasher, microwave, and eye-level oven
- Integrated tall fridge and separate integrated tall freezer
- Freestanding sofas (one incorporating a sofa bed) and matching storage footstool
- 5ft upholstered divan in the master bedroom and second bedroom with lift flap for storage
- Bathroom with bath and separate shower cubicle. Master en-suite with generous shower enclosure
- Vaulted ceiling throughout with a minimum ceiling height of 2.4m (8ft)
- Grain Effect Plastic Cladding
- External socket, side lanterns and front downlights
- Bedroom throws and coordinating scatter cushions
- Lounge scatter cushions
- Feature paneled fireplace with integrated lighting
- Luxurious plain duvet covers
- USB sockets throughout for convenience

### PLATINUM

Image shows 44x22 3 bed



40ft x 22ft	2 & 3 bedroom
44ft x 22ft	2 & 3 bedroom
50ft x 22ft	3 bedroom





Image shows 44x22 3 bed



Image shows 44x22 3 bed



Image shows 44x22 3 bed



Image shows 44x22 3 bed

# Glendale Lodge

Platinum Package Option includes the following:

- Aggregate Coated Steel Tile System with a 50 Year Weatherproof Warranty
- Wood effect Panelled Ceiling
- Wallpaper Finish
- Domestic Skirting and Door Casings
- Electric Combination Safe
- Hive Heating System
- Wine Cooler
- Bluetooth Speakers
- Outdoor Tap

## Residential Specification

Option includes the following:

- Roof 250mm insulated
- 125mm thick wall
- Floor minimum 120mm insulated
- Windows low E glass and Argon filled
- Superior Insulation U values exceeding the British Standard

### Key

- |   |                |   |               |
|---|----------------|---|---------------|
|    | Cooker         |    | USB Point     |
|    | Hob            |    | TV Space      |
|   | Fridge-Freezer |   | Electric Fire |
|  | Microwave      |  | Patio Doors   |
|  | Washer/Dryer   |  | French Doors  |
|  | Dishwasher     |  | Bifold Doors  |
|  | Boiler         |  | Wardrobe      |



40ft x 22ft - 2 bedroom

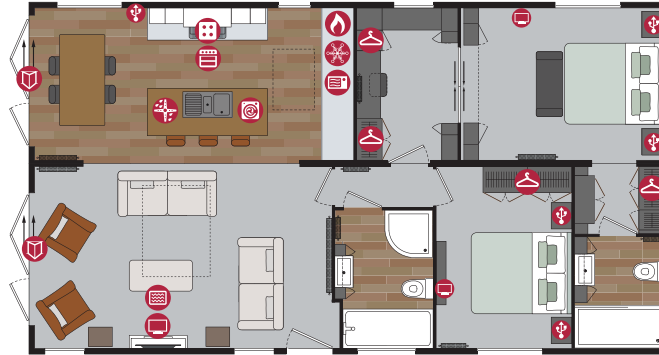

44ft x 22ft - 2 bedroom

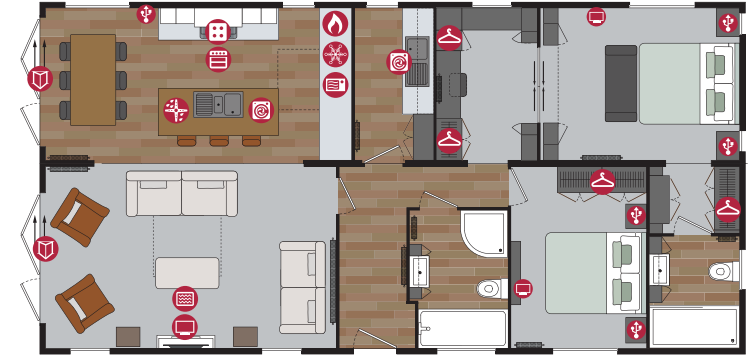

40ft x 22ft - 3 bedroom

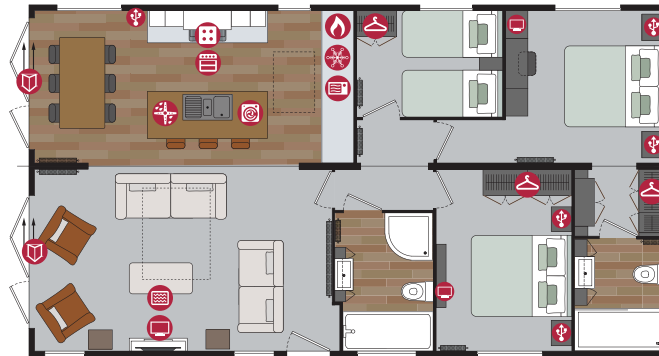

44ft x 22ft - 3 bedroom



50ft x 22ft - 3 bedroom

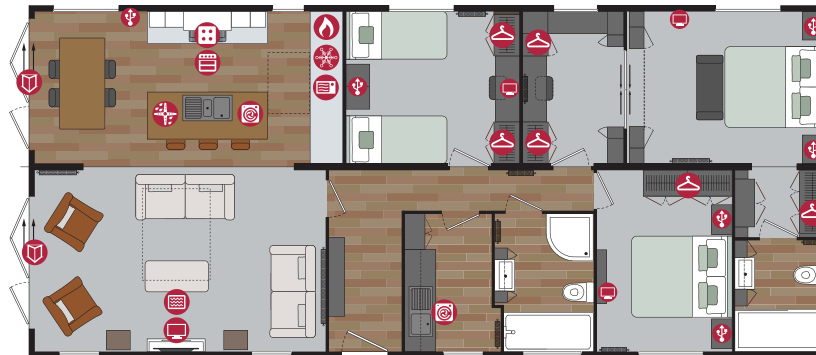

**PLATINUM**

Image shows 44x22 2 bed



Image shows 44x22 2 bed



Image shows 44x22 3 bed



Image shows 44x22 3 bed



**Options available to order**

- Residential Specification to BS3632 available in all cladding types
- Utility room in 44ft and 50ft models
- Wine cooler (standard in Platinum package)
- Windows in place of bi-fold doors
- Lounge curtains in lieu of roman blinds
- Platinum package
- Lift up bed storage space
- All electric version including central heating
- Bath instead of shower to en-suite

For further details see standard features checklist on pages 80-82.



**Pemberton**  
PARK & LEISURE HOMES

# Kingsdale Lodge

The Kingsdale is Pemberton's flagship park home and is popular with an optional appealing Canaxel and Stucco exterior, bay windows in a choice of 4 different colours and dual entrances with an open sight line from the hallway to the utility area. This home has been designed to free flow from one room to another but with the option to have a closed off lounge and a door from the hallway to the kitchen/utility.

PLATINUM

Image shows 40x20 2 bed



*Pemberton Kingsdale 40 x 20 2 bed Platinum shown in optional Canexel Cladding & Stucco with optional Anthracite Windows & Doors*



With an eye-catching mirrored splashback to the utility the large work surface is perfect for mixing cocktails for your guests. Both bedrooms have king size beds and stunning wardrobes complete with internal drawers and there is a walk through vanity area linking the en-suite to the master bedroom. Colours are elegantly neutral throughout, with a pop of burgundy in the lounge, and calming blue to the bedrooms.

PLATINUM

Image shows 40x20 2 bed



### Highlights

- PVCu double glazing with bay windows
- Gas combi central heating system with thermostatic radiator valves
- TV points in both bedrooms
- Integrated washer/dryer, dishwasher and microwave
- Downlit fireplace with electric stove
- Luxurious lounge suite
- Coffee table
- Utility room with rear door access
- 5ft upholstered divan in the master bedroom and second bedroom with drawers for storage
- External socket
- Wireless thermostat
- Grain Effect Plastic Cladding
- Lounge Scatter Cushions
- Bedroom Throws and Co-ordinating Scatter Cushions
- Duvet Sets
- High level cooker with separate oven and grill
- Kitchen Plinth Ambient lighting

36ft x 20ft	2 bedroom
40ft x 20ft	2 bedroom
44ft x 20ft	3 bedroom
50ft x 20ft	2 bedroom



PLATINUM

Image shows 40x20 2 bed



PLATINUM

Image shows 40x20 2 bed



PLATINUM

Image shows 40x20 2 bed



PLATINUM

Image shows 40x20 2 bed



# Kingsdale Lodge

Platinum Package Option includes the following:

- Aggregate Coated Steel Tile System with a 50 Year Weatherproof Warranty
- Wood effect Panelled Ceiling
- Wallpaper Finish
- Domestic Skirting and Door Casings
- Electric Combination Safe
- Hive Heating System
- Wine Cooler
- Bluetooth Speakers
- Outdoor Tap

## Residential Specification

Option includes the following:

- Roof 250mm insulated
- 125mm thick wall
- Floor minimum 120mm insulated
- Windows low E glass and Argon filled
- Superior Insulation U values exceeding the British Standard

## Key

	Cooker		USB Point
	Hob		TV Space
	Fridge-Freezer		Electric Fire
	Microwave		Patio Doors
	Washer/Dryer		French Doors
	Dishwasher		Bifold Doors
	Boiler		Wardrobe



36ft x 20ft - 2 bedroom

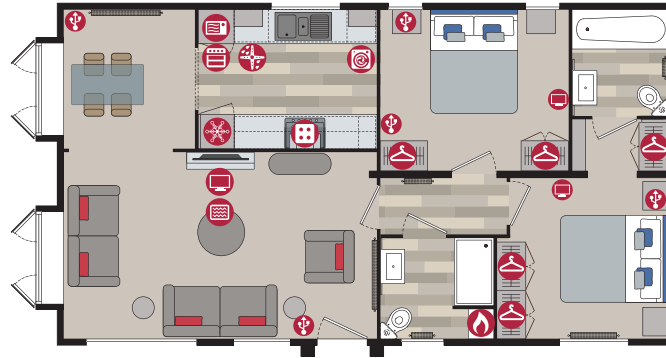

40ft x 20ft - 2 bedroom

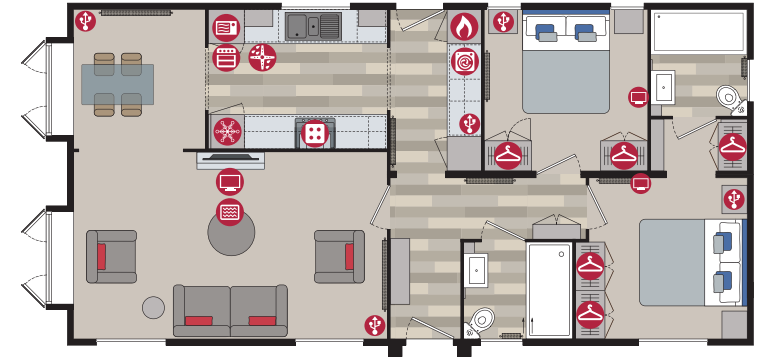

44ft x 20ft - 3 bedroom

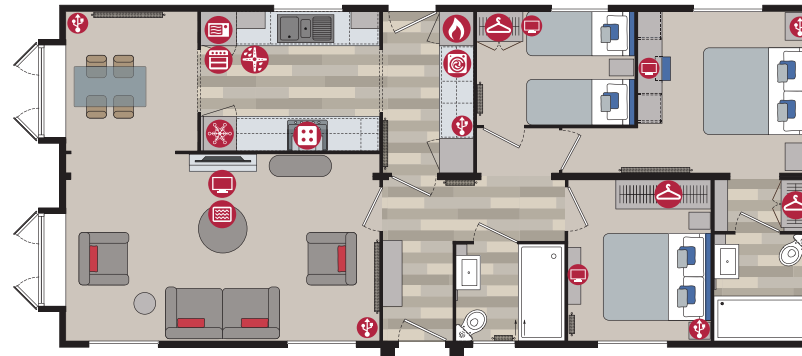

50ft x 20ft - 2 bedroom



PLATINUM

Image shows 40x20 2 bed



PLATINUM

Image shows 40x20 2 bed



PLATINUM

Image shows 40x20 2 bed



PLATINUM

Image shows 40x20 2 bed



### Options available to order

- Residential Specification to BS3632 available in all cladding types
- Patio doors to front elevation
- Wine cooler
- Closed off lounge
- Bath in lieu of shower
- Platinum Package
- Kingsdale Lodge available in Canexel, Stucco & Vinylit Cladding
- Lift up storage bed
- All electric version including central heating

For further details see standard features checklist on pages 80-82.



**Pemberton**  
PARK & LEISURE HOMES

# Skydale Lodge

The Skydale is an impressive addition to the Pemberton range of lodges and is brimming with character and charm. This 40 x 20 model is fundamentally an open plan home with each social space flowing seamlessly into the next. A display unit creates a screen between the side entrance and the spacious lounge. The U shaped kitchen has plenty of room for food preparation and the breakfast bar gives diners a more casual option for meal times.



PLATINUM

Image shows 40x20 2 bed



*Pemberton Skydale 40 x 20 2 bed shown in optional Vinylit Shadow Turner Oak and Kitami Oak with optional Anthracite Windows & Doors*



Industrial elements can be found in the lighting and the concrete effect dining and coffee table with a contrast metal base. Kitchen plinth lighting and under cupboard spotlights allow for ambient lighting in the evenings. Both bedrooms are bright and airy with a zesty, fresh colour scheme throughout. Available with 2 or 3 bedrooms where an air of freshness is created through a combination of feature walls alongside bright, zesty colours. The 2 bedroom version features a cleverly concealed, dressing area with hanging space, shelving and drawers.

Skydale's exterior has an option for Vinylit contrast cladding combining both horizontal and vertical panels to create a stunning, crafted effect. Combined with optional anthracite windows this new model certainly makes its presence known in any location.

### Highlights

- Hive thermostat
- Gas combi central heating system with thermostatic radiator valves
- PVCu double glazing with French doors to front elevation
- Integrated washer/dryer, dishwasher and microwave
- Luxurious sofa and sofabed with accent chair
- High level cooker with separate oven and grill
- Breakfast bar with 2 bar stools
- Plinth lighting in kitchen
- Entrance vestibule with storage
- Hallway closet
- 5ft bed in the master bedroom and 3ft beds in the second bedroom
- TV points in both bedrooms
- Grain Effect Plastic Cladding
- Lounge Scatter Cushions
- Bedroom Throws and Co-ordinating Scatter Cushions
- Duvet Sets
- Vaulted ceiling throughout with a minimum ceiling height of 2.4m (8ft)
- Kitchen Plinth Ambient lighting

PLATINUM

Image shows 40x20 2 bed



30ft x 20ft

2 bedroom

40ft x 20ft

2 & 3 bedroom

# Skydale Lodge

## Platinum Package Option includes the following:

- Aggregate Coated Steel Tile System with a 50 Year Weatherproof Warranty
- Wood effect Panelled Ceiling
- Wallpaper Finish
- Domestic Skirting and Door Casings
- Electric Combination Safe
- Hive Heating System
- Wine Cooler
- Bluetooth Speakers
- Outdoor Tap

## Residential Specification

### Option includes the following:

- Roof 250mm insulated
- 125mm thick wall
- Floor minimum 120mm insulated
- Windows low E glass and Argon filled
- Superior Insulation U values exceeding the British Standard

### Key

- |   |  |
|---|--|
|  Cooker          |  USB Point      |
|  Hob             |  TV Space       |
|  Fridge-Freezer |  Electric Fire |
|  Microwave     |  Patio Doors  |
|  Washer/Dryer  |  French Doors |
|  Dishwasher    |  Bifold Doors |
|  Boiler        |  Wardrobe     |



30ft x 20ft - 2 bedroom

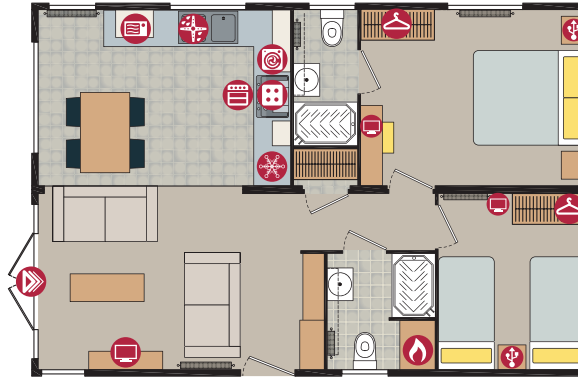

40ft x 20ft - 2 bedroom

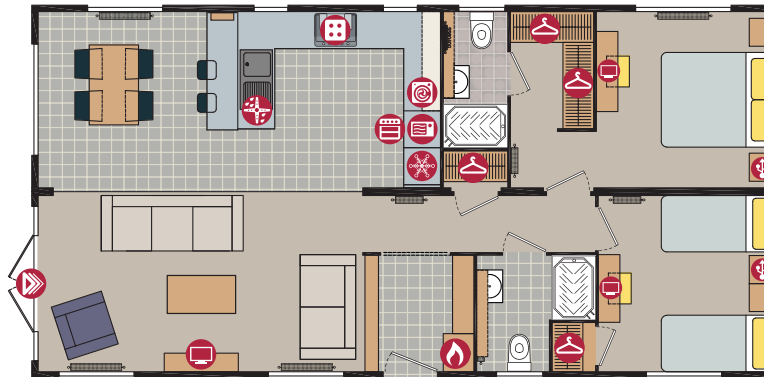

40ft x 20ft - 3 bedroom

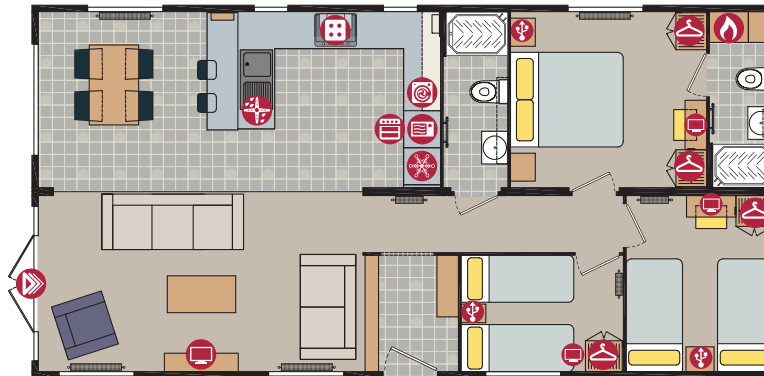

PLATINUM

Image shows 40x20 2 bed



PLATINUM

Image shows 40x20 2 bed



PLATINUM

Image shows 40x20 2 bed



PLATINUM

Image shows 40x20 2 bed

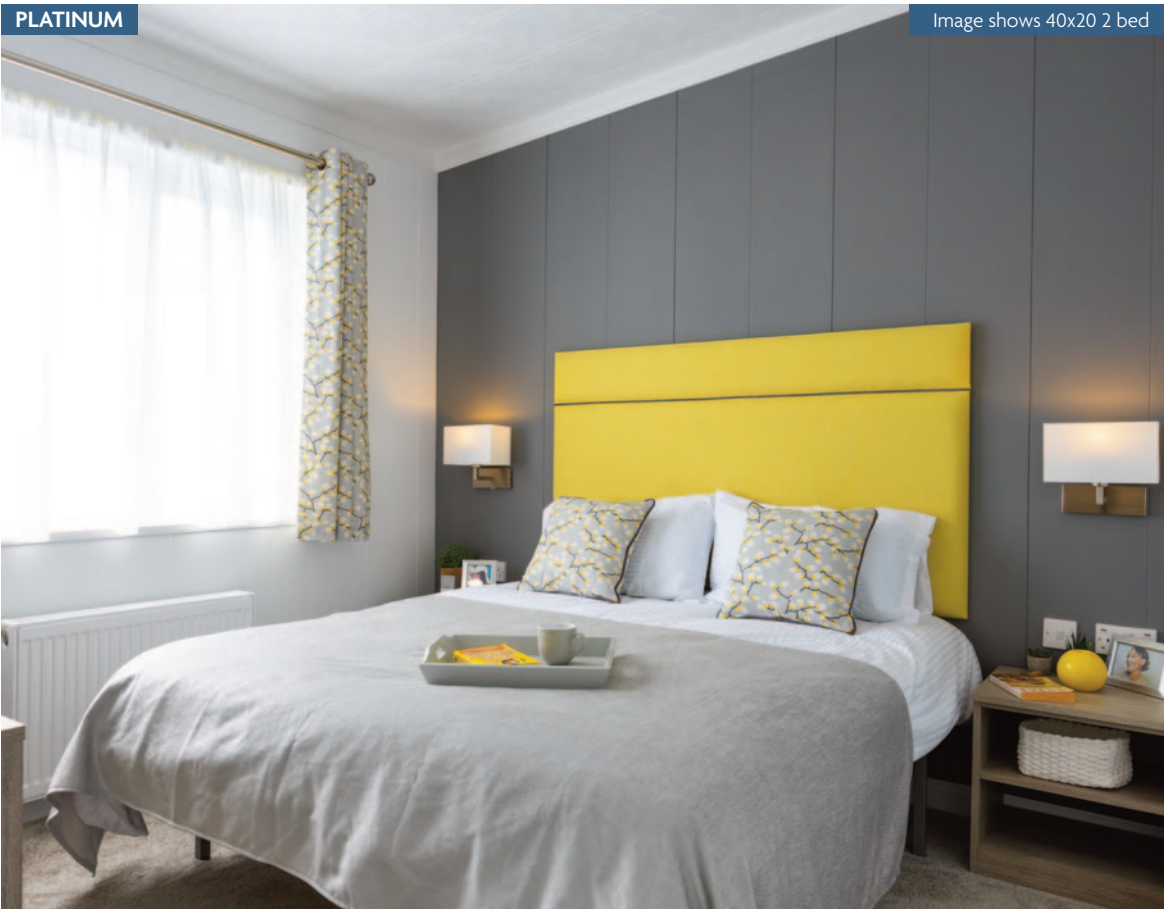

### Options available to order

- Residential Specification to BS3632 available in all cladding types
- Patio doors or bifold doors to front elevation
- Wine cooler
- Platinum Package
- Skydale Lodge available in Canexel, Vinylit & Stucco Cladding
- Lift up storage bed
- All electric version including central heating
- Bluetooth
- Bath in lieu of shower (in 2 bedroom model 40 x 20ft)

For further details see standard features checklist on pages 80-82.



**Pemberton**  
 PARK & LEISURE HOMES

# Features Check List

	Avon 28 x 10 2 Bed	Avon 30 x 12 2 Bed	Avon 32 x 12 2 Bed	Avon 35 x 12 2 Bed	Avon 38 x 12 2 Bed	Avon 38 x 12 3 Bed	Avon 40 x 13 2 Bed	Regent 2 Bed	Marlow All models	Marlow 38 x 12 2 Bed CL	Marlow 40 x 13 2 Bed CL	Abingdon 38 x 12 2 Bed	Abingdon 42 x 13 2 Bed	Rivington 2 Bed	Rivington 3 Bed	Langton 2 Bed	Park Lane 2 Bed	Park Lane 3 Bed	Knightsbridge 43 x 14 2 Bed	Skydale 40 x 20 2 Bed	Arrendale All models	Rivendale All other models	Rivendale 50 model only	Glendale All other models	Glendale 50 model only	Kingsdale All models	
RESIDENTIAL BS3632	O	O	O	O	O	O	O	O	O	O	O	O	O	O	O	O	O	O	O	O	O	O	O	O	O	O	O
Platinum Package	O	O	O	O	O	O	O	O	O	O	O	O	O	O	O	O	O	O	O	O	O	O	O	O	O	O	O
<b>STRUCTURE</b>																											
Pre Galvanised Chassis	O	O	O	O	O	O	O	O	O	O	O	S	S	S	S	-	-	-	-	-	-	-	-	-	-	-	-
Hot Dipped Galvanised Chassis	O	O	O	O	O	O	O	O	O	O	O	O	O	O	O	S	S	S	S	S	S	S	S	S	S	S	S
Twin Axle Chassis	-	-	S	S	S	S	S	S	S	S	S	S	S	S	S	S	S	S	S	S	S	S	S	S	S	S	S
Underfloor & Walls 60mm Fibreglass Insulation	S	S	S	S	S	S	S	S	S	S	S	S	S	S	S	S	S	S	S	S	S	S	S	S	S	S	S
Roof 150mm Fibreglass Insulation	S	S	S	S	S	S	S	S	S	S	S	S	S	S	S	S	S	S	S	S	S	S	S	S	S	S	S
Tongue and Grooved P5 Moisture Resistant Floor Boarding	S	S	S	S	S	S	S	S	S	S	S	S	S	S	S	S	S	S	S	S	S	S	S	S	S	S	S
Lagged Hot & Cold Water Exterior Pipework	S	S	S	S	S	S	S	S	S	S	S	S	S	S	S	S	S	S	S	S	S	S	S	S	S	S	S
<b>EXTERIOR</b>																											
External Socket	O	O	O	O	O	O	O	O	O	O	O	O	O	S	S	S	S	S	S	S	S	S	S	S	S	S	S
External Tap	O	O	O	O	O	O	O	O	O	O	O	O	O	O	O	O	O	O	O	O	O	O	O	O	O	O	O
PVCu Double Glazing	O	O	O	O	O	O	O	O	O	O	O	S	S	S	S	S	S	S	S	S	S	S	S	S	S	S	S
Exterior Light	S	S	S	S	S	S	S	S	S	S	S	S	S	S	S	S	S	S	S	S	S	S	S	S	S	S	S
Pitched Pan Tile Roof and Domestic Gutters	S	S	S	S	S	S	S	S	S	S	S	S	S	S	S	S	S	S	S	S	S	S	S	S	S	S	S
White Windows & Doors	S	S	S	S	S	S	S	S	S	S	S	S	S	S	S	S	S	S	S	S	S	S	S	S	S	S	S
Skylight Window	-	-	-	-	-	-	-	-	-	-	-	-	-	-	-	S	S	S	S	-	-	O	O	O	O	-	-
Window in Lieu of Front Doors (refer to BS3632)	S	S	S	S	S	S	S	S	S	S	S	O	O	O	O	O	O	O	O	O	O	O	O	O	O	O	O
Side Bifold Door in lieu of Door	-	-	-	-	-	-	-	-	-	O	O	-	-	-	-	-	-	-	O	-	-	S	S	-	-	-	-
French Doors in Lieu of Windows *	-	O	O	O	O	O	O	O	O	-	-	S	S	S	S	S	S	S	S	S	S	S	S	S	S	S	-
<b>INTERIOR Heating &amp; General</b>																											
Bluetooth Surround Sound	O	O	O	O	O	O	O	O	O	O	O	O	O	O	O	O	O	O	O	O	O	O	O	O	O	O	O
Sky TV cabling	O	O	O	O	O	O	O	O	O	O	O	O	O	O	O	O	O	O	O	O	O	O	O	O	O	O	O
Wireless Thermostat	O	O	O	O	O	O	O	O	O	O	O	O	O	S	S	S	S	S	S	S	S	S	S	S	S	S	S
Thermostatic Mixer to Bath and/or Shower	S	S	S	S	S	S	S	S	S	S	S	S	S	S	S	S	S	S	S	S	S	S	S	S	S	S	S
Gas Combi Central Heating with Thermostatic Radiator Valves	O	O	O	O	O	O	O	O	O	O	O	S	S	S	S	S	S	S	S	S	S	S	S	S	S	S	S
Electric Convector/Panel Heaters	O	O	O	O	O	O	O	O	O	O	O	O	O	O	O	O	O	O	O	O	O	O	O	O	O	O	O
All Electric Version (including central heating)	O	O	O	O	O	O	O	O	O	O	O	O	O	O	O	O	O	O	O	O	O	O	O	O	O	O	O
Trace Heating	O	O	O	O	O	O	O	O	O	O	O	O	O	O	O	O	O	O	O	O	O	O	O	O	O	O	O
Auto Stop Valve	O	O	O	O	O	O	O	O	O	O	O	O	O	O	O	O	O	O	O	O	O	O	O	O	O	O	O
LED Lighting	S	S	S	S	S	S	S	S	S	S	S	S	S	S	S	S	S	S	S	S	S	S	S	S	S	S	S
<b>INTERIOR Kitchen</b>																											
Externally Vented Cooker Extractor Hood	S	S	S	S	S	S	S	S	S	S	S	S	S	S	S	S	S	S	S	S	S	S	S	S	S	S	S
Inset 5 Burner Gas Hob with Electric Ignition	-	-	-	-	-	-	-	-	-	-	-	-	-	-	-	S	S	S	S	S	S	S	S	S	S	S	S
Gas Oven and Grill with Electric Ignition	-	-	-	-	-	-	-	-	-	-	-	-	-	-	-	S	S	S	S	S	S	S	S	S	S	S	S
Gas Cooker and Grill with Electric Ignition	S	S	S	S	S	S	S	S	S	S	S	S	S	S	S	-	-	-	-	-	-	-	-	-	-	-	-
Microwave	O	O	O	O	O	O	O	O	O	O	O	S	S	S	S	S	S	S	S	S	S	S	S	S	S	S	S
Dishwasher	-	O	O	O	O	O	O	O	O	O	O	O	O	O	O	S	S	S	S	S	S	S	S	S	S	S	S
Washing Machine (Freestanding)	-	O	O	O	O	O	O	O	O	O	O	O	O	O	O	O	O	O	O	O	O	O	O	O	O	O	O
Washer Dryer (Integrated or Freestanding)	-	O	O	O	O	O	O	O	O	O	O	O	O	O	O	S	S	S	S	S	S	S	S	S	S	S	S
Fridge Freezer (Integrated)	O	O	O	O	O	O	O	O	O	O	O	S	S	S	S	S	S	S	-	S	-	-	-	-	-	-	-
Fridge Freezer (Free Standing)	O	O	O	O	O	O	O	O	O	O	O	-	-	-	-	-	-	-	S	-	-	-	S	S	-	-	-
Fridge (Free Standing)	O	O	O	O	O	O	O	O	O	O	O	-	-	-	-	-	-	-	-	-	-	-	-	-	-	-	-
Wine Cooler	-	-	-	-	-	-	-	-	-	-	-	-	-	-	-	O	O	O	O	O	O	O	O	O	O	O	O

	Avon 28 x 10.2 Bed	Avon 30 x 12.2 Bed	Avon 32 x 12.2 Bed	Avon 35 x 12.2 Bed	Avon 38 x 12.2 Bed	Avon 38 x 12.3 Bed	Avon 40 x 13.2 Bed	Regent 2 Bed	Marlow All models	Marlow 38 x 12.2 Bed CL	Marlow 40 x 13.2 Bed CL	Abingdon 38 x 12.2 Bed	Abingdon 42 x 13.2 Bed	Rivington 2 Bed	Rivington 3 Bed	Langton 2 Bed	Park Lane 2 Bed	Park Lane 3 Bed	Knightbridge 43 x 14.2 Bed	Skydale 40 x 20.2 Bed	Arundale All models	Rivendale All other models	Rivendale 50 model only	Glendale All other models	Glendale 50 model only	Kingsdale All models
<b>INTERIOR Utility Storage</b>	-	-	-	-	-	-	-	-	-	-	-	-	-	-	-	-	-	-	-	-	O	O	S	O	S	S
<b>INTERIOR Dining</b>																										
Dining Table with 4 Chairs (plus 2 dining stools for Avon 3 bed)	-	S	S	S	S	S	S	S	S	S	S	S	S	S	S	S	S	S	S	S	S	S	S	S	S	S
Extra Dining Chairs	A	A	A	A	A	A	A	A	A	A	A	A	A	A	A	A	A	A	A	A	A	A	A	A	A	A
Bar Stools	-	-	-	-	-	-	-	-	-	-	-	-	-	S	S	-	S	S	-	S	S	-	-	S	S	-
<b>INTERIOR Lounge</b>																										
Fabric Covered Lounge Seating/Suite	S	S	S	S	S	S	S	S	S	S	S	S	S	S	S	S	S	S	S	S	S	S	S	S	S	S
Occasional/Accent Chair	-	S	S	S	S	S	S	S	O	-	S	S	S	S	S	S	S	S	-	S	S	-	-	S	S	-
Fold out Sofa Bed in Lounge/Snug	S	S	S	S	S	S	S	S	S	S	S	S	S	S	S	S	S	S	S	S	S	S	S	S	S	A
Lounge Scatter Cushions	O	O	O	O	O	O	O	O	O	O	O	S	S	S	S	S	S	S	S	S	S	S	S	S	S	S
Lounge Curtains instead of Venetian/Roman blinds	-	-	-	-	-	-	-	-	O	O	O	-	-	-	-	O	O	O	O	-	O	O	O	O	O	-
TV Booster (Multi Outlet)	S	S	S	S	S	S	S	S	S	S	S	S	S	S	S	S	S	S	S	S	S	S	S	S	S	S
Flame Effect Electric Fire	S	S	S	S	S	S	S	S	S	S	S	S	S	S	S	S	S	S	S	S	S	S	S	S	S	S
Coffee Table	S	S	S	S	S	S	S	S	S	S	S	A	A	-	-	A	A	A	A	S	-	S	S	A	A	O
Footstool	A	A	A	A	A	A	A	A	A	A	A	S	S	S	S	S	S	S	S	A	S	A	A	S	S	S
Side Table	-	-	-	-	S	-	S	A	S	A	A	S	S	S	S	A	A	A	A	-	-	-	-	S	S	S
<b>INTERIOR Bathrooms</b>																										
Extractor Fan to Bathroom/Shower	S	S	S	S	S	S	S	S	S	S	S	S	S	S	S	S	S	S	S	S	S	S	S	S	S	S
Family Bathroom with Bath/Shower	-	-	-	-	-	-	-	-	-	-	-	-	-	-	-	-	S	-	S	-	S	-	-	S	S	O
Family Shower Room with Shower S	S	S	S	S	S	S	S	S	S	S	S	S	S	S	S	S	S	S	S	-	S	S	-	-	S	-
Separate En-Suite Shower, Basin and Toilet	-	-	-	-	-	-	-	-	-	-	-	-	-	O	S	-	-	S	-	S	S	S	S	S	S	S
Separate En-Suite Bath/Shower, Basin and Toilet	-	-	-	-	-	-	-	-	-	-	S	-	-	S	-	S	S	-	S	-	O	O	O	O	O	O
Separate En-Suite Basin and Toilet	-	-	-	S	S	S	S	S	S	S	-	-	S	-	-	-	-	-	-	-	-	-	-	-	-	-
Shaver Point	-	-	-	-	-	-	-	-	-	-	-	-	-	-	-	O	O	O	O	O	O	O	O	O	O	O
Family Bathroom with Shower (instead of Bath)	-	-	-	-	-	-	-	-	-	-	-	-	-	-	-	S	S	O	S	-	O	S	S	-	-	-
En-suite Bathroom with Shower (instead of Bath)	-	-	-	-	-	-	-	-	-	-	O	-	-	O	-	O	O	S	O	-	-	-	-	-	-	-
Family Bathroom with Bath (instead of Shower)	-	-	-	-	-	-	-	-	-	-	-	-	-	-	-	-	-	-	-	-	-	-	-	-	-	-
En-suite Bathroom with Bath (instead of Shower)	-	-	-	-	-	-	-	-	-	-	-	-	-	-	-	-	-	-	-	-	-	O	O	-	-	-
<b>INTERIOR Bedrooms</b>																										
Bed throws and Bedroom Scatter Cushions	A	A	A	A	A	A	A	A	A	A	A	A	A	A	A	S	S	S	S	S	S	S	S	S	S	S
Bedroom Duvet Covers and Pillowcases	A	A	A	A	A	A	A	A	A	A	A	A	A	A	A	S	S	S	S	S	S	S	S	S	S	S
Divan Bed Bases with built in storage	-	-	-	-	-	-	-	-	-	-	-	-	-	-	-	-	-	-	-	-	O	S	S	S	S	S
Lift up Storage Bed (master bedroom only)	O	O	O	O	O	O	O	O	O	O	O	O	O	O	O	O	O	O	O	O	O	O	O	O	O	O
Safe	O	O	O	O	O	O	O	O	O	O	O	O	O	O	O	O	O	O	O	O	O	O	O	O	O	O
TV Point in Main Bedroom	S	S	S	S	S	S	S	S	S	S	S	S	S	S	S	S	S	S	S	S	S	S	S	S	S	S
TV Point in Twin Bedroom	O	O	O	O	O	O	O	O	O	O	O	O	O	S	S	S	S	S	S	S	S	S	S	S	S	S
Stowaway Occasional Bed	O	O	O	O	O	O	O	O	O	O	O	O	O	O	O	O	O	O	O	O	O	O	O	O	O	-
<b>SAFETY</b>																										
Fire Extinguisher	S	S	S	S	S	S	S	S	S	S	S	S	S	S	S	S	S	S	S	S	S	S	S	S	S	S
Smoke Detector	S	S	S	S	S	S	S	S	S	S	S	S	S	S	S	S	S	S	S	S	S	S	S	S	S	S
Carbon Monoxide Detector	S	S	S	S	S	S	S	S	S	S	S	S	S	S	S	S	S	S	S	S	S	S	S	S	S	S
Emergency Escape Windows	S	S	S	S	S	S	S	S	S	S	S	S	S	S	S	S	S	S	S	S	S	S	S	S	S	S

Standard = S    Optional = O    Not Available/Applicable = -    Accessories = A

This brochure does not constitute any part of an offer or contract. Pemberton Park & Leisure Homes Limited reserve the right to alter specifications, equipment and prices without prior notice in accordance with availability of material and our policy of continuous product development. All dimensions in this brochure are approximate overall sizes. Please refer to the Features Check List to establish whether items are standard features or optional extras. Photographic props such as dining crockery and glassware, rugs, towels, kitchen accessories and exterior balconies, steps and skirts are shown for pictorial decoration only. The indications of colour of interior décor are as close as printing techniques allow.

# Cladding

	Avon	Regent	Marlow	Marlow Centre Lounge	Abingdon	Rivington	Langton	Park Lane	Knightsbridge	Skydale	Arrondale	Rivendale	Glendale	Kingsdale
<b>ALUMINIUM</b>														
Seafoam	S	S	S	S	S	S	O	O	O	'	'	'	'	'
Sandstone	O	O	O	O	O	O	O	O	O	'	'	'	'	'
Environmental Green	O	O	O	O	O	O	O	O	O	'	'	'	'	'
<b>WOODGRAIN ALUMINIUM</b>														
LightGrey	O	O	O	O	O	O	S	S	O	'	'	'	'	'
Chateaux	O	O	O	O	O	O	O	O	S	'	'	'	'	'
<b>GRAIN EFFECT PLASTIC</b>														
Cream	O	O	O	O	O	O	O	O	O	S	S	S	S	S
Sand	O	O	O	O	O	O	O	O	O	S	S	S	S	S
Environmental Green	O	O	O	O	O	O	O	O	O	S	S	S	S	S
Light Grey	O	O	O	O	O	O	O	O	O	S	S	S	S	S
<b>CANEXEL</b>														
Yellowstone	O	O	O	O	O	O	O	O	O	O	O	O	O	O
Acadia	O	O	O	O	O	O	O	O	O	O	O	O	O	O
Sierra	O	O	O	O	O	O	O	O	O	O	O	O	O	O
Mist Grey	O	O	O	O	O	O	O	O	O	O	O	O	O	O
Cliffside	O	O	O	O	O	O	O	O	O	O	O	O	O	O
Timberwolf	O	O	O	O	O	O	O	O	O	O	O	O	O	O
Sand	O	O	O	O	O	O	O	O	O	O	O	O	O	O
Barnwood	O	O	O	O	O	O	O	O	O	O	O	O	O	O
Red Fox	O	O	O	O	O	O	O	O	O	O	O	O	O	O
<b>VINYLIT</b>														
Turner Oak Malt	O	O	O	O	O	O	O	O	O	O	O	O	O	O
Kitami Oak	O	O	O	O	O	O	O	O	O	O	O	O	O	O
Sheffield Oak Alpine	O	O	O	O	O	O	O	O	O	O	O	O	O	O
Sheffield Oak Concrete	O	O	O	O	O	O	O	O	O	O	O	O	O	O
<b>STUCCO RENDER</b>														
Gardenia	O	O	O	O	O	O	O	O	O	O	O	O	O	O
Grey Pearl	O	O	O	O	O	O	O	O	O	O	O	O	O	O
Almond	O	O	O	O	O	O	O	O	O	O	O	O	O	O

Other options are available. Please contact Pemberton for more details.

# Decking

If you are looking for a truly spectacular finish to your Pemberton Park & Leisure Home, then opt for a stylish decking solution. Offering a comprehensive choice, ranging from decking and balustrades to skirting and lighting, you can customise your home to suit the aspect of your plot.

Decking is available in wood effect finish with a variety of different colours to choose from.



# Cladding

## ALUMINIUM



## STUCCO RENDER



## CANEXEL



## WOODGRAIN ALUMINIUM



## GRAIN EFFECT PLASTIC



## VINYLIT



# Windows & Doors

How your Pemberton Park & Leisure Home should look is a personal choice, so we offer as many aesthetic choices as possible. You may want your windows and doors to blend in with your cladding, or maybe you love to see the contrast. Either way, we offer a choice of colours in our PVCu doubleglazed windows and doors, right across our entire Pemberton collection.

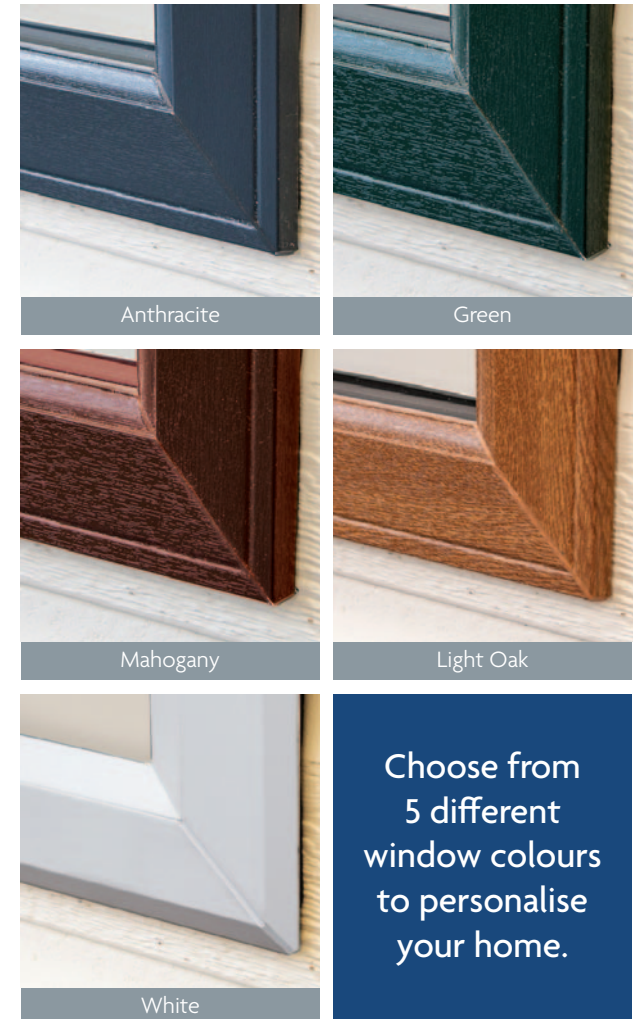

Choose from  
5 different  
window colours  
to personalise  
your home.

# Beds & Bed sizes

A comfortable night's sleep is never far away in a Pemberton home. Every model includes British manufactured domestic deluxe mattresses which provide an esteemed level of support. Customers can also specify crib 5 standard mattresses to conform to contract standard when homes are being let out to holidaymakers.

We have put together a comprehensive list of bed sizes throughout the whole range which includes options for when requirements differ from the standard floorplan.

Our king size divans in the Arrondale, Rivendale and Glendale are now upholstered to co-ordinate with the headboards really giving a feeling our luxury in the master bedrooms. In addition they all come with a lift up flap so that items can be stored within the cavity.

If you would like more storage then you have the lift up storage bed option for your master bedroom which is really practical as it provides easy access.



Slim Single Bed (6' x 2')

Single Bed (6' x 3')

Single Bed (6' x 2'3")

Single Bed (6' x 2'6")

Single Bed (6'3" x 2'6")

Super Single Bed (6'3" x 3')

Double Bed (6' x 4')

Double Bed (6' x 4'6")

Kingsize Bed (6' x 5')

Kingsize Bed (6'3" x 5')

	Avon 28 x 10 2 Bed	Avon 30 x 12 2 Bed	Avon 32 x 12 2 Bed	Avon 35 x 12 2 Bed	Avon 38 x 12 2 Bed	Avon 38 x 12 3 Bed	Avon 40 x 13 2 Bed	Regent 36 x 12 2 Bed	Regent 38 x 12 2 Bed	Marlow 36 x 12 1 Bed	Marlow 36 x 12 2 Bed	All other models	Marlow 38 x 12 2 Bed CL	Marlow 40 x 13 2 Bed CL	Abingdon 38 x 12 2 Bed	Abingdon 42 x 13 2 Bed	Rivington 40 x 12 2 Bed	Rivington 42 x 13 3 Bed	Rivington 42 x 14 2 Bed	Langton 2 Bed	Park Lane 2 Bed	Park Lane 3 Bed	Knightsbridge 43 x 14 2 Bed	Skydale 40 x 20 2 Bed	Skydale 40 x 20 3 Bed	Arrondale All models	Rivendale 36 x 20 2 Bed	Rivendale 40 & 44 x 20 2 Bed	Rivendale 40 & 44 x 20 3 Bed	Rivendale 50 model only	Glendale 40 & 44 x 22 2 Bed	Glendale 40 & 44 x 22 3 Bed	Glendale 50 x 22 3 Bed	Kingsdale 2 Bed					
Slim Single Bed (6' x 2')	S																																						
Single Bed (6' x 3')													S	S																									
Single Bed (6' x 2'3")		S	S	S	S	S	S	S	S						S	S	S	S	O	O	O	S	O	O	O														
Single Bed (6' x 2'6")																O																							
Single Bed (6'3" x 2'6")																										S													
Super Single Bed (6'3" x 3')																									O	O		S	S	S	S	S	S	O	O	O			
Double Bed (6' x 4')	S	O	O	O	O	O	O	O	O	O	O	O	O	O	O	O	O	O	O	O	O	O	O	O	O	O	O	O	O	O	O	O	O	O	O	O	O	O	O
Double Bed (6' x 4'6")		S	S	S	O	S	S	S	O	O	S	O	O	O	O	O	O	O	O	O	O	S	O	O	O	O	O	O	O	O	O	O	O	O	O	O	O	O	O
Kingsize Bed (6' x 5')					S		S	O	S	S	O	S	S	S	S	S	S	S	S	S	S		S	S	S	O	O	O	O	O	O	O	O	O	O	O	O	O	S
Kingsize Bed (6'3" x 5')													O	O										O	O	S	S	S	S	S	S	S	S	S	S	S	S	S	S

Standard = S    Optional = O    Not Available/Applicable = -

# Dimensions

Dimensions in mm	L1	L2	W1	W2	H1	H2
Avon 28 x 10 2B	8941	8607	3402	3122	3728	3728
Avon 30 x 12 2B	9538	9204	4096	3816	3728	3728
Avon 32 x 12 2B	10148	9814	4096	3816	3728	3728
Avon 35 x 12 2B & 3B	11062	10728	4096	3816	3728	3728
Avon 38 x 12 2B & 3B	11976	11642	4096	3816	3728	3728
Avon 40 x 13 2B	12598	12264	4272	3992	3718	3718
Avon 42 x 14 2B	13166	12832	4450	4170	3760	3760
Regent 36 x 12 2B	11366	11032	4096	3816	3728	3728
Regent 38 x 12 2B	11976	11642	4096	3816	3728	3728
Marlow 36 x 12 1B & 2B	11366	11032	4096	3816	3728	3728
Marlow 38 x 12 2B	11976	11642	4096	3816	3728	3728
Marlow 40 x 13 2B & 3B	12598	12264	4272	3992	3718	3718
Marlow 42 x 14 2B	13166	12832	4450	4170	3760	3760
Marlow c/lounge 38 x 12 2B	11790	11642	3990	3816	3935	3935
Marlow c/lounge 40 x 13 2B	12412	12264	4178	3992	3972	3972
Abingdon 38 x 12 2B	11976	11642	4096	3816	3728	3728
Abingdon 42 x 13 2B	13166	12832	4272	3992	3718	3718
Rivington 40 x 12 2B	12598	12264	4096	3816	3728	3728
Rivington 42 x 13 3B	13166	12832	4272	3992	3718	3718
Rivington 42 x 14 2B	13166	12832	4450	4170	3760	3760
Langton 43 x 14 2B	13717	13178	4450	4170	3984	3984
Park Lane 43 x 14 2B & 3B	13717	13178	4450	4170	3984	3984
Knightsbridge 43 x 14 2B	13717	13178	4450	4170	3984	3984
Skydale 30 x 20 2B & 3B	9675	9167	6433	6122	4034	4034
Skydale 40 x 20 2B & 3B	12725	12217	6433	6122	4034	4034
Arrondale 42 x 16 2B	13338	12830	5666	4907	4029	4029
Arrondale 45 x 16 2B & 3B	14251	13743	5666	4907	4029	4029
Rivendale 36 x 20 2B	11505	10997	6824	6122	4034	4034
Rivendale 40 x 20 2B & 3B	12725	12217	6824	6122	4034	4034
Rivendale 44 x 20 2B & 3B	13945	13437	6824	6122	4034	4034
Rivendale 50 x 20 2B	15775	15267	6824	6122	4034	4034
Glendale 40 x 22 2B & 3B	12725	12217	7434	6732	4034	4034
Glendale 44 x 22 2B & 3B	13945	13437	7434	6732	4034	4034
Glendale 50 x 22 3B	15775	15267	7434	6732	4034	4034
Kingsdale 36 x 20 2B	11680	10997	6824	6122	4034	4034
Kingsdale 40 x 20 2B	12900	12217	6824	6122	4034	4034
Kingsdale 44 x 20 2B	14118	13437	6824	6122	4034	4034
Kingsdale 50 x 20 2B	15950	15267	6824	6122	4034	4034

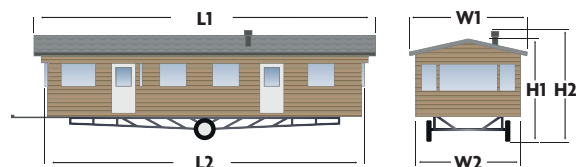

Pemberton Homes are built and certified to the European Standard EN1647 and BS3632 when sited.

# Siting & Assembly

**When you have chosen your park, selected your pitch and secured your new Pemberton leisure home the next step is siting and assembly.**

This requires experienced staff that have been trained by the NCC. They make sure that the twin unit has a completely level platform in order that all the doors and windows can operate correctly and to ensure the white goods are able to function as they should. All Pemberton's engineers have this qualification and adhere to the relevant working practices.

The scope of our siting service extends beyond the borders of the UK and Ireland to the rest of Europe and beyond. Pemberton's siting team are also able to offer a relocation service for twin units.

**Please contact our After Sales Department for a breakdown of their services. Details of how to do this can be found on page 82.**



# Parts & Services

Our expert team of engineers can undertake all manner of repairs and upgrades.

These are coupled with our extremely helpful and efficient Aftersales Customer Care team, who are more than happy to offer guidance and assistance. You will also have the peace of mind that all work carried out comes with a no quibble 12 month guarantee.

Or, do you just need replacement parts?

No problem, as we are here to help you with that too!

Our replacement parts service enables you to obtain newer versions of items, or in some cases depending on the age of the home, identical replacements.

**Below are examples of the work we can undertake:-**

- ✓ Replacement lighting
- ✓ Plumbing repairs
- ✓ Roof repairs
- ✓ Cladding repairs and renewals
- ✓ Insurance work and repairs
- ✓ Levelling
- ✓ Twin chassis assembly
- ✓ Replace kitchen units, worktops, doors and drawers
- ✓ Accidental damage repairs
- ✓ Install or replace appliances
- ✓ Replace windows and doors
- ✓ Replace bathroom fixtures and fittings

With the support of our award winning design team, we can also make your Pemberton home as individual as you are by offering internal layout changes.

## The latest upgrades

If you're looking to give your Pemberton home a fresh look, our team of experts are on hand to help!



### Kitchen Upgrades

We can supply and install everything you need for a total kitchen makeover, from wall cabinets to the flooring, and everything in between!



### Appliances

Replace appliances such as fridges, washing machines and wine coolers. We can carry out new installations, or replace existing appliances.



### Lounge Upgrades

You could choose to have a new luxury suite, or why not make the change even more dramatic by adding patio doors, or even a feature wall. Or simply replace carpets, lighting or furniture.



### External Upgrade

Give your Pemberton a fresh look with a selection of external upgrades.



### Bedroom Upgrades

Why not upgrade your bedroom with the latest designs in furniture and upholstery. We can also transform the look of your bedroom with a feature wall.



### Bathroom Upgrades

We can replace your bath with a shower, or vice versa, lay new vinyl flooring, and upgrade your sinks, toilets and taps.

For more parts ideas and options, please visit our website [www.pembertonlh.co.uk](http://www.pembertonlh.co.uk)

To make a parts, repair or upgrade enquiry, please send an email to [info@pembertonlh.co.uk](mailto:info@pembertonlh.co.uk)  
Alternatively, please call our Aftersales Team on 01942 321 221, and select Option 3, then Option 2.

# Pemberton Warranty

## 3 Year Complete Care Warranty

Pemberton's 3 Year Complete Care Warranty provides the first home owner a comprehensive guarantee on all parts and fittings within the Pemberton home. This reassurance is offered to the first owner during the first 36 months of ownership against installation errors, defects and manufacturing faults, these include sockets, wiring, lights, baths, shower trays, bath/shower screens, toilets, internal doors, door casings, skirting boards, architraves, plumbing pipes and connectors, gutters, downpipes, taps (inc mixers/valves), wallboards, furniture (fitted and freestanding) dining chairs and upholstered furniture. \*\*

## 5 Year Boiler Warranty

The new upgraded version of the Morco Boiler (with the serial number beginning AHN) comes with a 5 year owner transferable warranty. \*\*

## 5 Year Structural Warranty

Pemberton's 5 year Structural Warranty provides the first home owner with the safeguard of knowing that the Aluminum cladding, metal pantile roof sheets, windows, doors, walls and floorboards are covered for 5 years against installation errors, defects and manufacturing faults from the date the home is purchased by the first owner, or commissioned and hired out.\*\*

## 10 Year Superior Cladding Warranty

LP Building Solutions/Eltherington Group/Vox Carafax backed warranty covers our premium cladding range, including CanExel, Vinylit and VOX Artefoam PVC Cladding, and is offered to the first home owner. The warranty covers against water ingress directly through the cladding boards, and any breakdown of the exterior surface. \*\*

## 12 Year Chassis Warranty

Fully Hot Dipped Galvanised chassis (HDG) have a 12 year anti-corrosion warranty. \*\*

## 50 Year Platinum Roof Warranty

BRITMET TILEFORM LIMITED backed warranty covers the Aggregate Coated Steel TileRoof System which has a 50 year weatherproof warranty against water entering the home through the tiles, and is offered to the first home owner. \*\*

\*\*Subject to terms, conditions and exclusions



### 10 YEAR WARRANTY

## Residential Park Home Warranty

Pemberton Park & Leisure Homes are pleased to announce that they are a part of the GoldShield Warranty scheme.

The Goldshield 10 –year warranty is exclusively designed for park home owners. It is provided and administered on behalf of the manufacturers and the NCC, the industry's trade body.

GoldShield maintains an independent financial reserve, funded by member park home manufacturers, to guarantee comprehensive structural coverage for homes registered under the warranty for a duration of 10 years. These exceptional benefits are provided in conjunction with and in addition to the legal rights afforded to purchasers.





# Pemberton

P A R K & L E I S U R E H O M E S

Woodhouse Lane, Wigan, Lancashire WN6 7NF

Tel: 01942 321 221

Email: [info@pembertonlh.co.uk](mailto:info@pembertonlh.co.uk)

[www.pembertonlh.co.uk](http://www.pembertonlh.co.uk)

*The first choice for your new home*